

95.21532 38.97792

129

1. Location of well:	County Douglas	Fraction NE SW NE 1/4 SW 1/4 SE 1/4	Section number 29	Township number T 12	Range number S R 20	(EXW)
----------------------	--------------------------	--	-----------------------------	--------------------------------	-------------------------------	--------------

2. Distance and direction from nearest town or city: Street address of well location if in city: 9th + Maple, Lawrence	3. Owner of well: FMC Corp. R.R. or street: 9th + Maple City, state, zip code: Lawrence, Kansas 66044
--	--

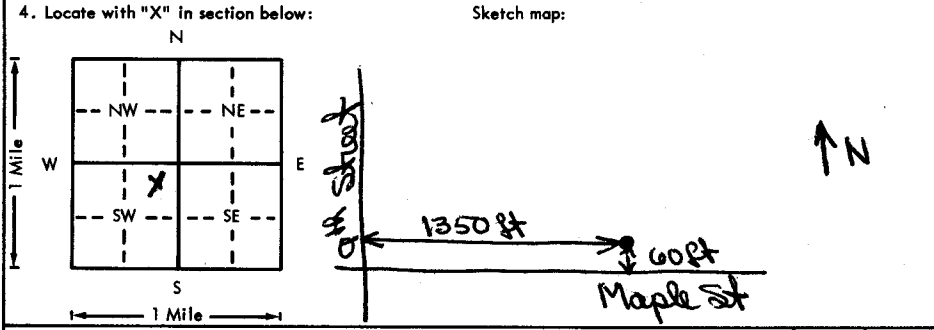

6. Bore hole dia. 8 in. Completion date _____ Well depth _____ ft. 1/9/76
7. <input checked="" type="checkbox"/> Cable tool <input type="checkbox"/> Rotary <input type="checkbox"/> Driven <input type="checkbox"/> Dug <input type="checkbox"/> Hollow rod <input type="checkbox"/> Jetted <input type="checkbox"/> Bored <input type="checkbox"/> Reverse rotary
8. Use: <input type="checkbox"/> Domestic <input type="checkbox"/> Public supply <input type="checkbox"/> Industry <input type="checkbox"/> Irrigation <input type="checkbox"/> Air conditioning <input type="checkbox"/> Stock <input type="checkbox"/> Lawn <input type="checkbox"/> Oil field water <input checked="" type="checkbox"/> Other
9. Casing: Material Steel Height: (Above) or below Threaded _____ Welded <input checked="" type="checkbox"/> Surface 1.32 ft in. RMP _____ PVC _____ Weight _____ lbs./ft. Dia. 4 in. to 45 ft. depth; Wall Thickness (inches) or Dia. _____ in. to _____ ft. depth; gage No. 25

5. Type and color of material	From	To
TOPSOIL	0	6
SILT - yellowish brown	6	9
SILTY SAND - fine, yellowish brown	9	11
SAND - fine, yellow brown	11	17
SAND and SILTY SAND, interbedded, y. brown	17	28.75
SAND - medium, gray	28.75	30
SAND - medium, gray	28.75	30
SAND - medium, yellow brown	30	31
SAND - medium, gray	31	34
SAND - fine to medium, gray	34	40
CLAY - gray	40	41.5
SAND - fine to medium, gray	41.5	46
SAND - coarse, gray	46	49.5
BEDROCK	49.5	

10. Screen: Manufacturer's name Johmann Type low carbon steel Dia. 4 <input checked="" type="checkbox"/> Slot gauze 30 Length 3 ft Set between 45 ft. and 48 ft. Gravel pack? NO Size range of material _____
11. Static water level: _____ mo./day/yr. 1420 ft. below land surface Date 1/9/76
12. Pumping level below land surfaces: NA _____ ft. after _____ hrs. pumping _____ g.p.m. _____ ft. after _____ hrs. pumping _____ g.p.m. Estimated maximum yield _____ g.p.m.
13. Water sample submitted: _____ mo./day/yr. Yes <input checked="" type="checkbox"/> No <input type="checkbox"/> Date _____
14. Well head completion: NA <input type="checkbox"/> Pitless adapter 127 Inches above grade
15. Well grouted? YES With: <input checked="" type="checkbox"/> Neat cement <input type="checkbox"/> Bentonite <input type="checkbox"/> Concrete Depth: From 0 ft. to 15 ft.
16. Nearest source of possible contamination: NA ft. _____ Direction _____ Type _____ Well disinfected upon completion? _____ Yes <input checked="" type="checkbox"/> No <input type="checkbox"/>
17. Pump: <input checked="" type="checkbox"/> Not installed Manufacturer's name _____ Model number _____ HP _____ Volts _____ Length of drop pipe _____ ft. capacity _____ g.p.m. Type: <input type="checkbox"/> Submersible <input type="checkbox"/> Turbine <input type="checkbox"/> Jet <input type="checkbox"/> Reciprocating <input type="checkbox"/> Centrifugal <input type="checkbox"/> Other

18. Elevation:	19. Remarks:
Topography: <input type="checkbox"/> Hill <input type="checkbox"/> Slope <input type="checkbox"/> Upland <input checked="" type="checkbox"/> Valley	

20. Water well contractor's certification: This well was drilled under my jurisdiction and this report is true to the best of my knowledge and belief. JUGMAN N.B. 119 A Business name _____ License No. _____ Address CARBONDALE KS Signed James P. Jugman Date 1-9-76 Authorizing representative
--

129
200
29
NE NE SW
1/4 1/4 1/4