

WATER WELL RECORD

Form WWC-5

Division of Water Resources App. No.

1 LOCATION OF WATER WELL: County: Douglas Fraction NW 1/4 NW 1/4 NW 1/4 NW 1/4 Section Number 35 Township No. T 12 S Range Number R 20 [X]E [ ]W

Street/Rural Address of Well Location; if unknown, distance & direction from nearest town or intersection: If at owner's address, check here [ ]. ~1/2-mile North of the intersection of E. 1900 Rd and N 1550 Rd. Eudora, KS 66044

2 WATER WELL OWNER: Penny's Concrete, Inc. RR#, Street Address, Box #: 23400 W. 82nd Street City, State, ZIP Code : Shawnee, KS 66227

Global Positioning System (GPS) information: Latitude: 38.971456 Longitude: 95.148561 Elevation: 806 805.95 Datum: [X] WGS 84, [ ] NAD 83, [ ] NAD 27 Collection Method: [ ] GPS unit, [X] Digital Map/Photo, [ ] Topographic Map, [ ] Land Survey Est. Accuracy: [X] <3 m, [ ] 3-5 m, [ ] 5-15 m, [ ] >15 m

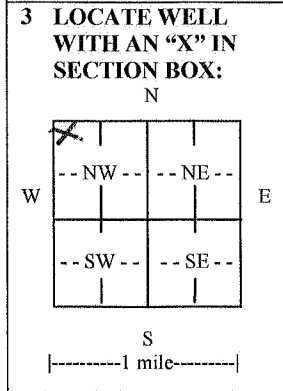

3 LOCATE WELL WITH AN 'X' IN SECTION BOX: 4 DEPTH OF COMPLETED WELL 40 ft. Depth(s) Groundwater Encountered (1) 32.24 ft. (2) N/A (3) N/A WELL'S STATIC WATER LEVEL 20.21 ft. below land surface measured on mo/day/yr. 5-1-13 Pump test data: Well water was N/A ft. after N/A hours pumping, N/A gpm EST. YIELD N/A gpm. Well water was N/A ft. after N/A hours pumping, N/A gpm Bore Hole Diameter 8.25 in. to 40 ft., and N/A in. to N/A ft. WELL WATER TO BE USED AS: [ ] Public water supply [ ] Geothermal [ ] Injection well [ ] Domestic [ ] Feedlot [ ] Oil field water supply [ ] Dewatering [ ] Other (Specify below) [ ] Irrigation [ ] Industrial [ ] Domestic-lawn & garden [X] Monitoring well MW-1 Was a chemical/bacteriological sample submitted to Department? [ ] Yes [X] No If yes, mo/day/yr sample was submitted. Water well disinfected? [ ] Yes [X] No

5 TYPE OF CASING USED: [ ] Steel [X] PVC [ ] Other CASING JOINTS: [ ] Glued [ ] Clamped [ ] Welded [X] Threaded Casing diameter 2 in. to 20 ft., Diameter N/A in. to N/A ft., Diameter N/A in. to N/A ft. Casing height above land surface 30 in., Weight N/A lbs./ft., Wall thickness or gauge No. Schedule 40

TYPE OF SCREEN OR PERFORATION MATERIAL: [ ] Steel [ ] Stainless Steel [X] PVC [ ] Other (Specify) [ ] Brass [ ] Galvanized Steel [ ] None used (open hole) SCREEN OR PERFORATION OPENINGS ARE: [ ] Continuous slot [X] Mill slot [ ] Gauze wrapped [ ] Torch cut [ ] Drilled holes [ ] None (open hole) [ ] Louvered shutter [ ] Key punched [ ] Wire wrapped [ ] Saw cut [ ] Other (specify) SCREEN-PERFORATED INTERVALS: From 20 ft. to 40 ft., From N/A ft. to N/A ft., From N/A ft. to N/A ft. GRAVEL PACK INTERVALS: From 18 ft. to 40 ft., From N/A ft. to N/A ft., From N/A ft. to N/A ft.

6 GROUT MATERIAL: [ ] Neat cement [ ] Cement grout [X] Bentonite [X] Other Concrete pad from 0 to 2-feet Grout Intervals: From 2 ft. to 18 ft., From N/A ft. to N/A ft., From N/A ft. to N/A ft. What is the nearest source of possible contamination: [ ] Septic tank [ ] Lateral lines [ ] Pit privy [ ] Livestock pens [ ] Insecticide storage [X] Other (specify below) [ ] Sewer lines [ ] Cesspool [ ] Sewage lagoon [ ] Fuel storage [ ] Abandoned water well [ ] Watertight sewer lines [ ] Seepage pit [ ] Feedyard [ ] Fertilizer storage [ ] Oil well/gas well Agricultural Direction from well Adjacent Distance from well Adjacent

Table with 6 columns: FROM, TO, LITHOLOGIC LOG, FROM, TO, LITHO. LOG (cont.) or PLUGGING INTERVALS. Rows describe soil layers from 0 to 40 feet depth, including clay, sand, and gravel with various textures and saturations.

7 CONTRACTOR'S OR LANDOWNER'S CERTIFICATION: This water well was [X] constructed, [ ] reconstructed, or [ ] plugged under my jurisdiction and was completed on (mo/day/year) 5-1-2013 and this record is true to the best of my knowledge and belief. Kansas Water Well Contractor's License No. 759 This Water Well Record was completed on (mo/day/year) 6/16/2013 under the business name of RAZEK Environmental, LLC by (signature) [Signature]

INSTRUCTIONS: Use typewriter or ball point pen. PLEASE PRESS FIRMLY and PRINT clearly. Please fill in blanks and check the correct answers. Send three copies (white, blue, pink) to Kansas Department of Health and Environment, Bureau of Water, Geology Section, 1000 SW Jackson St., Suite 420, Topeka, Kansas 66612-1367. Telephone 785-296-5524. Send one copy to WATER WELL OWNER and retain one for your records. I include fee of \$5.00 for each constructed well. Visit us at http://www.kdheks.gov/waterwell/index.html.