

Location listed as:

Section-Township-Range: 4-115-24E

Fraction ($\frac{1}{4}$ $\frac{1}{4}$ $\frac{1}{4}$): SW SW SW

County: Johnson

Location changed to:

4-125-24E

SW SW SW

Other changes: Initial statements: _____

Changed to: _____

Comments: _____

verification method: Johnson County map + directions given by driller

initials: JB date: 9-27-2004

submitted by: Kansas Geological Survey, Data Resources Library, 1930 Constant Ave., Lawrence, KS 66047-3726
to: Kansas Dept of Health & Environment, Bureau of Water, 1000 SW Jackson, Suite 420, Topeka, KS 66612-1367.

1 LOCATION OF WATER WELL: County Johnson Fraction SW 1/4 SW 1/4 SW 1/4 Section Number 4 Township Number T 11 S Range Number R 24 E/W

Distance and direction from nearest town or city street address of well if located within city?
11019 W. 75th St., Shawnee, Ks.

2 WATER WELL OWNER: Shell Oil Products, U.S.

RR#, St. Address, Box # : 308 Wilcox # 101
 City, State, ZIP Code Castle Rock, Colo 80104

Board of Agriculture, Division of Water Resources
 Application Number:

3 LOCATE WELL'S LOCATION WITH AN "X" IN SECTION BOX:

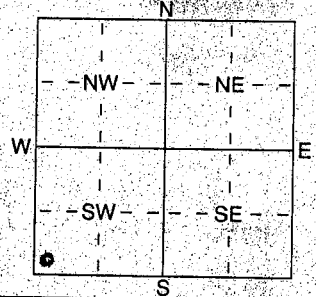

4 DEPTH OF COMPLETED WELL 15.6' ft. ELEVATION: _____ ft.

Depth(s) Groundwater Encountered _____ ft. 2 _____ ft. 3 _____ ft.
 WELL'S STATIC WATER LEVEL 9.15 ft. below land surface measured on mo/day/yr 8-3-04
 Pump test data: Well water was _____ ft. after _____ hours pumping _____ gpm
 Est. Yield _____ gpm: Well water was _____ ft. after _____ hours pumping _____ gpm
 WELL WATER TO BE USED AS: 5 Public water supply 8 Air conditioning 11 Injection well
 1 Domestic 3 Feedlot 6 Oil field water supply 9 Dewatering 12 Other (Specify below)
 2 Irrigation 4 Industrial 7 Domestic (lawn & garden) 10 Monitoring well

Was a chemical/bacteriological sample submitted to Department? Yes _____ No X : If yes, mo/day/yr sample was submitted
 Water Well Disinfected? Yes _____ No (No)

5 TYPE OF BLANK CASING USED:

2 Steel 2 PVC 3 RMP (SR) 4 ABS 5 Wrought iron 6 Asbestos-Cement 7 Fiberglass 8 Concrete tile 9 Other (specify below)
 Blank casing diameter 0.875 in. to 5' ft. Dia _____ in. to _____ ft. Dia _____ in. to _____ ft. Dia
 Casing height above land surface Flush Mt. in., weight _____ lbs./ft. Wall thickness or gauge No. San 40

TYPE OF SCREEN OR PERFORATION MATERIAL:

1 Steel 2 Brass 3 Stainless Steel 4 Galvanized Steel 5 Fiberglass 6 Concrete tile 7 PVC 8 RMP (SR) 9 ABS 10 Asbestos-Cement 11 Other (Specify) 12 None used (open hole)

SCREEN OR PERFORATION OPENINGS ARE:

1 Continuous slot 2 Louvered shutter 3 Mill slot 4 Key punched 5 Gauzed wrapped 6 Wire wrapped 7 Torch cut 8 Saw cut 9 Drilled holes 10 Other (specify) _____ ft. 11 None (open hole)

SCREEN-PERFORATED INTERVALS: From 15' ft. to 5' ft. From _____ ft. to _____ ft. From _____ ft. to _____ ft. From _____ ft. to _____ ft. From _____ ft. to _____ ft. From _____ ft. to _____ ft. From _____ ft. to _____ ft.

GRAVEL PACK INTERVALS: From 15.6" ft. to 4' ft. From _____ ft. to _____ ft. From _____ ft. to _____ ft. From _____ ft. to _____ ft. From _____ ft. to _____ ft.

6 GROUT MATERIAL: 1 Neat cement 2 Cement grout 3 Bentonite 4 Other Concrete
 Grout Intervals: From 4' ft. to 2' ft. From 2' ft. to Surface ft. From _____ ft. to _____ ft. From _____ ft. to _____ ft.

What is the nearest source of possible contamination:
 1 Septic tank 2 Sewer lines 3 Watertight sewer lines 4 Lateral lines 5 Cess pool 6 Seepage pit 7 Pit privy 8 Sewage lagoon 9 Feedyard 10 Livestock pens 11 Fuel storage 12 Fertilizer storage 13 Insecticide storage 14 Abandoned water well 15 Oil well/Gas well 16 Other (specify below)

Direction from well? West North West How many feet? 200'

FROM	TO	LITHOLOGIC LOG	FROM	TO	PLUGGING INTERVALS
0	1.75	Asphalt over 1/2 R.R. Gravel			
1.75	2.0	Dr. Green-Black clay, dry, firm			RECEIVED
2.0	3.0	Limestone-concrete fill			SEP 09 2004
3.0	6.0	Black clay, moist, firm, no odor			BUREAU OF WATER
6.0	7.0	Brk, concrete rubble layer			
7.0	11.0	Dr. Gray to Black clay, moist to very moist firm			
11.0	15.6	Red pin clay, stiff, moist, no odor			

F.H. OK'd by Don Taylor

7 CONTRACTOR'S OR LANDOWNER'S CERTIFICATION: This water well was (1) constructed (2) reconstructed, or (3) plugged under my jurisdiction and was completed on (mo/day/year) 7-29-04 and this record is true to the best of my knowledge and belief. Kansas

Water Well Contractor's Licence No. 732 This Water Well Record was completed on (mo/day/yr) 8-23-04
 under the business name of JB Env. Service & Supply by (signature) James Beckel

EXPLANATION

- ⊕ PROPOSED SOIL BORING
- ⊙ PROPOSED SOIL BORING / MONITORING WELL
- EXISTING MONITORING WELL (1998)
- ⊕ EXISTING SOIL BORING LOCATION (1998)
- EXISTING OBSERVATION WELL
- G GAS LINE
- V WATER LINE
- T TELEPHONE LINE (BURIED)
- SS SANITARY SEWER LINE
- E OVERHEAD ELECTRIC
- L ELECTRIC (BURIED)

WELL	DTW	TD
MW-1	4.52	13.62
MW-2	6.41	14.42
MW-3	5.48	12.97
MW-4	6.68	14.78

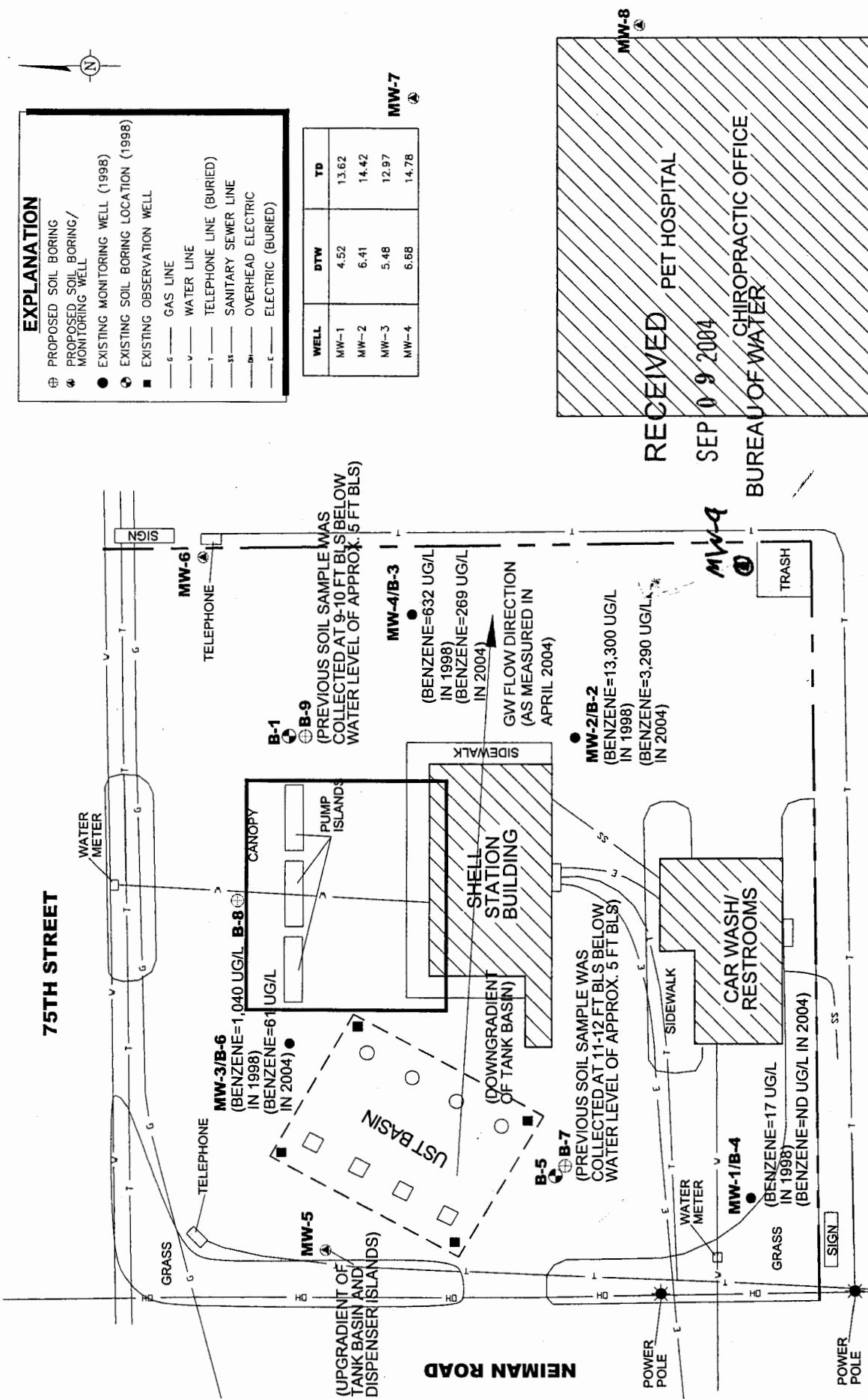

SITE MAP WITH PROPOSED SOIL BORINGS AND MONITORING WELLS

ARCADIS G&M

8725 ROSEHILL SUITE 350
 LEAN, KANSAS 66215
 Tel: (613) 492-0900 Fax: (913) 492-0902

0 30 FT.

SHELL SERVICE STATION
 11019 W 75TH STREET
 SHAWNEE, KANSAS

PROJECT NUMBER
 KC001428.0001

FIGURE NUMBER
2