

County: Johnson

Location listed as:

Section-Township-Range: 4-11S-24E

Fraction (  $\frac{1}{4}$   $\frac{1}{4}$   $\frac{1}{4}$ ): SW SW SW

Location changed to:

4-12S-24E

SW SW SW

Other changes: Initial statements: \_\_\_\_\_

Changed to: \_\_\_\_\_

Comments: \_\_\_\_\_

verification method: Johnson County map & directions given by driller

initials: JB date: 9-27-2004

1 LOCATION OF WATER WELL: County Johnson Fraction SW 1/4 SW 1/4 Sec 10 Section Number 4 Township Number T 11 S Range Number R 24 E

Distance and direction from nearest town or city street address of well if located within city?  
11019 West 75th St; Shawnee, KS

2 WATER WELL OWNER: Shell Oil Product, U.S.  
 RR#, St. Address, Box #: 308 Wilcox #101  
 City, State, ZIP Code: Castle Rock, Colo 80104  
 Board of Agriculture, Division of Water Resources  
 Application Number:

3 LOCATE WELL'S LOCATION WITH AN "X" IN SECTION BOX:

N			
-NW-		-NE-	
W			E
-SW-		-SE-	
S			

4 DEPTH OF COMPLETED WELL 15'6" ft. ELEVATION: \_\_\_\_\_ ft.  
 Depth(s) Groundwater Encountered 8.07 10' ft. 2 \_\_\_\_\_ ft. 3 \_\_\_\_\_ ft.  
 WELL'S STATIC WATER LEVEL 8.07 10' ft. below land surface measured on mo/day/yr 8-3-04  
 Pump test data: Well water was \_\_\_\_\_ ft. after \_\_\_\_\_ hours pumping \_\_\_\_\_ gpm  
 Est. Yield \_\_\_\_\_ gpm: Well water was \_\_\_\_\_ ft. after \_\_\_\_\_ hours pumping \_\_\_\_\_ gpm  
 WELL WATER TO BE USED AS:  
 1 Domestic 3 Feedlot 6 Oil field water supply 9 Dewatering 11 Injection well  
 2 Irrigation 4 Industrial 7 Domestic (lawn & garden) 10 Monitoring well 12 Other (Specify below)  
 Was a chemical/bacteriological sample submitted to Department? Yes \_\_\_\_\_ No X; If yes, mo/day/yr sample was submitted \_\_\_\_\_  
 Water Well Disinfected? Yes \_\_\_\_\_ No (No)

5 TYPE OF BLANK CASING USED:  
 1 Steel 3 RMP (SR) 5 Wrought iron 8 Concrete tile CASING JOINTS: Glued \_\_\_\_\_ Clamped \_\_\_\_\_  
 2 PVC 4 ABS 6 Asbestos-Cement 9 Other (specify below) Welded \_\_\_\_\_  
 7 Fiberglass Threaded X  
 Blank casing diameter 2.375 in. to 5' ft., Dia \_\_\_\_\_ in. to \_\_\_\_\_ ft., Dia \_\_\_\_\_ in. to \_\_\_\_\_ ft.  
 Casing height above land surface Flush Mt. in., weight \_\_\_\_\_ lbs./ft. Wall thickness or gauge No. sch 40  
 TYPE OF SCREEN OR PERFORATION MATERIAL:  
 1 Steel 3 Stainless Steel 5 Fiberglass 8 RMP (SR) 10 Asbestos-Cement  
 2 Brass 4 Galvanized Steel 6 Concrete tile 9 ABS 11 Other (Specify) \_\_\_\_\_  
 12 None used (open hole)  
 SCREEN OR PERFORATION OPENINGS ARE:  
 1 Continuous slot 3 Mill slot 5 Gauzed wrapped 8 Saw cut 11 None (open hole)  
 2 Louvered shutter 4 Key punched 6 Wire wrapped 9 Drilled holes  
 7 Torch cut 10 Other (specify) \_\_\_\_\_  
 SCREEN-PERFORATED INTERVALS: From 15' ft. to 5' ft., From \_\_\_\_\_ ft. to \_\_\_\_\_ ft.  
 GRAVEL PACK INTERVALS: From 15'6" ft. to 4' ft., From \_\_\_\_\_ ft. to \_\_\_\_\_ ft.

6 GROUT MATERIAL: 1 Neat cement 2 Cement grout 3 Bentonite 4 Other Concrete  
 Grout intervals: From 4' ft. to 2' ft., From 2' ft. to 5' ft., From \_\_\_\_\_ ft. to \_\_\_\_\_ ft.  
 What is the nearest source of possible contamination:  
 1 Septic tank 4 Lateral lines 7 Pit privy 10 Livestock pens 14 Abandoned water well  
 2 Sewer lines 5 Cess pool 8 Sewage lagoon 11 Fuel storage 15 Oil well/Gas well  
 3 Watertight sewer lines 6 Seepage pit 9 Feedyard 12 Fertilizer storage 16 Other (specify below)  
 13 Insecticide storage  
 Direction from well? West North West How many feet? 110'

FROM	TO	LITHOLOGIC LOG	FROM	TO	PLUGGING INTERVALS
0	1.50	Concrete			
1.50	2.0	Black-DK Binclay fill w/ls or gravel dry			RECEIVED
2.0	8.0	Concrete, brick, metal fill w/ Binclay matrix, dry, loose			SEP 09 2004
8.0	12.0	Black to DK Binclay, heavy to very heavy fine			BUREAU OF WATER
12.0	15.6	Red Binclay, tight to stiff, no dx			F.H. OK'd by N. Taylor

7 CONTRACTOR'S OR LANDOWNER'S CERTIFICATION: This water well was (1) constructed (2) reconstructed, or (3) plugged under my jurisdiction and was completed on (mo/day/year) 7-29-04 and this record is true to the best of my knowledge and belief. Kansas Water Well Contractor's Licence No. 732 This Water Well Record was completed on (mo/day/yr) 8-23-04 under the business name of QB Serv. Service & Supply by (signature) James Beebe

DC:\spr\04\01\BELL\K142800\DATA\DRAWING\MAS\B\FR\CON\S-B\APP\DWG\_51977\09/2004 03:15:30 P.M. COMPILED BY: TINA LLOYD | PROJECT MANAGER: TINA LLOYD | DRAWN BY: SHANON WALKER

**EXPLANATION**

- ⊕ PROPOSED SOIL BORING
- ⊙ PROPOSED SOIL BORING / MONITORING WELL
- EXISTING MONITORING WELL (1998)
- ⊙ EXISTING SOIL BORING LOCATION (1998)
- EXISTING OBSERVATION WELL
- G GAS LINE
- W WATER LINE
- T TELEPHONE LINE (BURIED)
- S SANITARY SEWER LINE
- E OVERHEAD ELECTRIC
- C ELECTRIC (BURIED)

WELL	DTW	TD
MW-1	4.52	13.62
MW-2	6.41	14.42
MW-3	5.48	12.97
MW-4	6.68	14.78

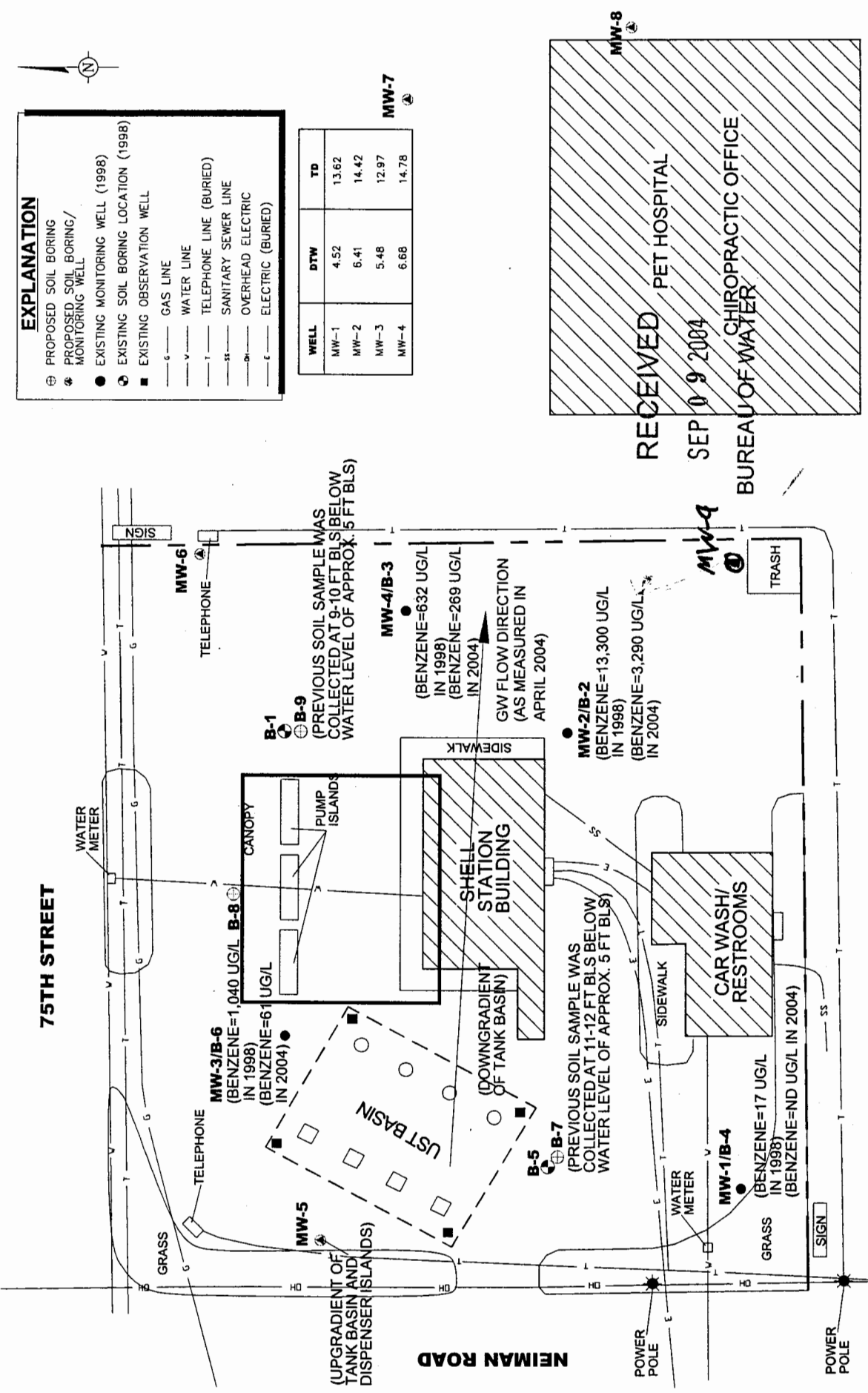

**ARCADIS G&M**

8725 ROSEHILL SUITE 350  
 SHAWNEE, KANSAS 66201  
 Tel: (913) 492-0900 Fax: (913) 492-0902

**SITE MAP WITH PROPOSED SOIL BORINGS AND MONITORING WELLS**

PROJECT NUMBER: KC001428.0001  
 FIGURE NUMBER: 2

SHELL SERVICE STATION  
 11019 W 75TH STREET  
 SHAWNEE, KANSAS

0 30 FT.