

WATER WELL RECORD

Form WWC-5

Division of Water Resources App. No.

1 LOCATION OF WATER WELL: County: Johnson Fraction: SE SE SW Section Number: 34 Township No.: T 12 S Range Number: R 24 E W W

Street/Rural Address of Well Location; if unknown, distance & direction from nearest town or intersection: If at owner's address, check here . Fuel Max 12930 W. 95th St; Lenexa, KS. Global Positioning System (GPS) information: Latitude: 38.57.23.99 (in decimal degrees) Longitude: 94.44.10.55 (in decimal degrees) Elevation: Datum: WGS 84, NAD 83, NAD 27 Collection Method: GPS unit (Make/Model: Google Earth) Digital Map/Photo, Topographic Map, Land Survey Est. Accuracy: <3 m, 3-5 m, 5-15 m, >15 m

2 WATER WELL OWNER: Cuda Holdings, LLC RR#, Street Address, Box #: 7915 N. Oak Trway City, State, ZIP Code: Kansas City, Mo. 64118

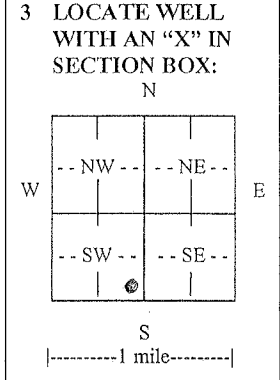

4 DEPTH OF COMPLETED WELL 14' 4" ft. Depth(s) Groundwater Encountered (1)..... ft. (2)..... ft. (3)..... ft. WELL'S STATIC WATER LEVEL 6.59 ft. below land surface measured on mo/day/yr. 4/16/14 Pump test data: Well water was.....ft. after..... hours pumping..... gpm EST. YIELD.....gpm Well water was.....ft. after..... hours pumping..... gpm Bore Hole Diameter 7.62 in. to 14.7 in. to in. to in. to in. to in. WELL WATER TO BE USED AS: Public water supply Geothermal Injection well Domestic Feedlot Oil field water supply Dewatering Other (Specify below) Irrigation Industrial Domestic-lawn & garden Monitoring well Was a chemical/bacteriological sample submitted to Department? Yes No If yes, mo/day/yr sample was submitted..... Water well disinfected? Yes No

5 TYPE OF CASING USED: Steel PVC Other CASING JOINTS: Glued Clamped Welded Threaded Casing diameter 2.375 in. to 4.375 ft. Diameter in. to ft. Diameter in. to ft. Casing height above land surface. Flush to in., Weightlbs./ft., Wall thickness or gauge No. 30x40 TYPE OF SCREEN OR PERFORATION MATERIAL: Steel Stainless Steel PVC Other (Specify) Brass Galvanized Steel None used (open hole) SCREEN OR PERFORATION OPENINGS ARE: Continuous slot Mill slot Gauze wrapped Torch cut Drilled holes None (open hole) Louvered shutter Key punched Wire wrapped Saw cut Other (specify) SCREEN-PERFORATED INTERVALS: From 14.3' ft. to 4.3' ft. From ft. to ft. From ft. to ft. GRAVEL PACK INTERVALS: From 14.7' ft. to 3' ft. From ft. to ft. From ft. to ft.

6 GROUT MATERIAL: Neat cement Cement grout Bentonite Other concrete Grout Intervals: From 3' ft. to 2' ft., From 2' ft. to 0' ft., From ft. to ft. What is the nearest source of possible contamination: Septic tank Lateral lines Pit privy Livestock pens Insecticide storage Other (specify below) Sewer lines Cesspool Sewage lagoon Fuel storage Fouler Abandoned water well Watertight sewer lines Seepage pit Feedyard Fertilizer storage Oil well/gas well Direction from well North east Distance from well 50'

FROM	TO	LITHOLOGIC LOG	FROM	TO	LITHO. LOG (cont.) or PLUGGING INTERVALS
0	1.50	Concrete			
1.50	5.0	Dk. clay w/ trace amt. of iron oxides			
5.0	13.0	Brn clay w/ iron oxides			
13.0	14.7'	Limestone - weathered			

7 CONTRACTOR'S OR LANDOWNER'S CERTIFICATION: This water well was constructed, reconstructed, or plugged under my jurisdiction and was completed on (mo/day/year) 4/19/14 and this record is true to the best of my knowledge and belief. Kansas Water Well Contractor's License No. 732 This Water Well Record was completed on (mo/day/year) 4/30/14 under the business name of G.B. Environmental by (signature) James Becker

INSTRUCTIONS: Use typewriter or ball point pen. PLEASE PRESS FIRMLY and PRINT clearly. Please fill in blanks and check the correct answers. Send one copy to Kansas Department of Health and Environment, Bureau of Water, Geology Section, 1000 SW Jackson St., Suite 420, Topeka, Kansas 66612-1367. Telephone 785-296-5524. Send one copy to WATER WELL OWNER and retain one for your records. Include fee of \$5.00 for each constructed well. Visit us at <http://www.kdheks.gov/waterwell/index.html>