

WATER WELL RECORD

Form WWC-5

Division of Water Resources App. No.

Well ID

MW10

Original Record Correction Change in Well Use

1 LOCATION OF WATER WELL: County Johnson Fraction NW 1/4 SW 1/4 SW 1/4 NE 1/4 Section Number 14 Township Number T 12 S Range Number R 24 E W

2 WELL OWNER: Last Name: First: Street or Rural Address where well is located (if unknown, distance and direction from nearest town or intersection): If at owner's address, check here: Business: QuikTrip Corporation Address: 4705 S 129th East Ave. City Tulsa State: OK ZIP: 74134

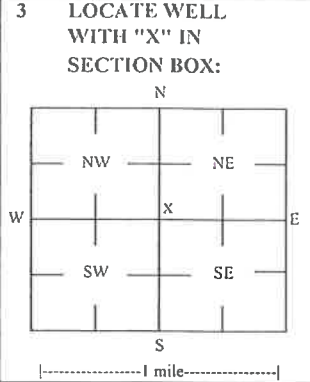

3 LOCATE WELL WITH "X" IN SECTION BOX: 4 DEPTH OF COMPLETED WELL: 15 ft Depth(s) Groundwater Encountered: 1) ft 2) ft 3) ft, or 4) Dry Well WELL'S STATIC WATER LEVEL: 6.35 ft

5 Latitude: 39.00864 (decimal degrees) Longitude: 94.71345 (decimal degrees) Horizontal Datum: WGS 84 NAD 83 NAD 27 Source for Latitude/Longitude: GPS (unit make/model: ) (WAAS enabled? Yes No) Land Survey Topographic Map Online Mapper

6 Elevation 1023.09 ft Ground Level TOC Source Land Survey GPS Topographic Map Other

7 WELL WATER TO BE USED AS: 1 Domestic: Household Lawn & Garden Livestock Irrigation Feedlot Industrial 2 Public Water Supply: well ID 3 Dewatering: how many bores? 4 Aquifer Recharge: well ID 5 Monitoring: well ID MW10 6 Environmental Remediation: well ID 7 Air Sparge Soil Vapor Extractor Recovery Injection 8 Oil Field Water Supply: lease 9 Test Hole: well ID 10 Cased Uncased Geotechnical 11 Geothermal: How many bores? 12 a) Closed Loop Horizontal Vertical b) Open Loop Surface Discharge Inj. of Water Other (specify):

Was a chemical/bacteriological sample submitted to KDHE? Yes No Water well disinfected? Yes No If yes, date sample was submitted:

8 TYPE OF CASING USED: Steel PVC Other CASING JOINTS: Glued Clamped Welded Threaded Casing diameter 2 in. to 5 ft, Diameter in. to ft, Diameter in. to ft, Casing height above land surface -0.50 in. Weight lbs./ft. Well thickness or gauge No TYPE OF SCREEN OR PERFORATION MATERIAL: Steel Stainless Steel Fiberglass PVC Other (Specify) SCREEN OR PERFORATION OPENINGS ARE: Continuous Slot Mill Slot Gauze Wrapped Torch Cut Drilled Holes Other (Specify) Louvered Shutter Key Punched Wire Wrapped Saw Cut None (Open Hole) SCREEN-PERFORATED INTERVALS: From 5 ft. to 15 ft, From ft. to ft, From ft. to ft, GRAVEL PACK INTERVALS: From 3 ft. to 15 ft, From ft. to ft, From ft. to ft,

9 GROUT MATERIAL: Neat cement Cement grout Bentonite Other Concrete: 0-0.5' Grout intervals: From 0.5 ft. to 3 ft, From ft. to ft, From ft. to ft, Nearest source of possible contamination: Septic Tank Lateral Lines Pit Privy Livestock Pens Insecticide Storage Sewer Lines Cess Pool Sewage Lagoon Fuel Storage Abandoned Water Well Watertight Sewer Lines Seepage Pit Feedyard Fertilizer Storage Oil Well / Gas Well Other (Specify)

Direction from well? SW Distance from well? ~140 ft

Table with columns: 10 FROM, TO, LITHOLOGIC LOG, FROM, TO, LITHO. LOG (cont.) or PLUGGING INTERVALS. Rows: 0-0.4 Asphalt, 0.4-1 Gravel fill, 1-4 Clay w/ gravel, 4-13 Clay, 13-15 Very fine sand w/ some silt and clay

Notes: KDHE ID: Former QuikTrip #164; U4-046-15231 Target of monitoring well is shallow groundwater, <20' of grout was installed at the direction of KDHE.

11 CONTRACTOR'S OR LANDOWNER'S CERTIFICATION: This water well was constructed, reconstructed, or plugged under my jurisdiction and was completed on (mo-day-year) 10/26/21 and this record is true to the best of my knowledge and belief. Kansas Water Well Contractor's License No. 757 This Water Well Record was completed on (mo-day-year) 11/15/21 under the business name of Larsen & Associates, Inc. Signature

# DENNIS L HANDKE

1820 NW 59th Terrace  
TOPEKA, KANSAS 66618  
785-286-4047 Home

Jess Chapman  
Larsen & Assoc.  
1311 E. 25<sup>th</sup> St., Suite B  
Lawrence, Kansas 66046

November 5, 2021

RE: Monitor Well Elevation Survey  
6637 Nieman Road, Shawnee, Kansas

Proj. 21-00KK  
Former Quik Trip #164  
KDHE ID U4-046-15231

Bench Mark: Square cut on North center of concrete storm inlet South of building.  
Elev.: 1026.10      North 2850.30      West 2436.56      (from SE Cor. Sec. 14-12-24E)

MW-10	rim	1023.59	North	3049.74	NW1/4,SW1/4,SW1/4,NE1/4
	top pipe	1023.09	West	2605.73	Lat = 39.00864    Long = 94.71345

Lat & Long derived from Shawnee 7.5' quad map. WGS84.

Elevation derived from existing project. NAVD88

If you have any questions, please feel free to call me. Thank you for the opportunity to be of service to you.

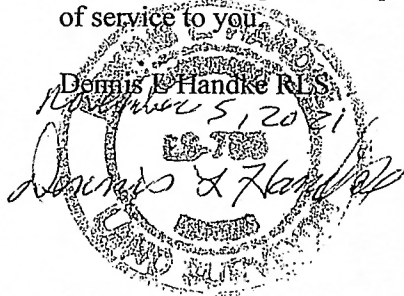

KS GEOLOGICAL SURVEY

FEB 16 2022

RECEIVED

RECEIVED  
DEC 16 2021  
BUREAU OF WATER

NOTE Figures exhibited within this report are only to be used within the context of this report Placement of property lines, wells, structures, and roads is based on the available information from county appraiser maps, surveys, site visits, and/or previous vendor reports and should be considered approximate

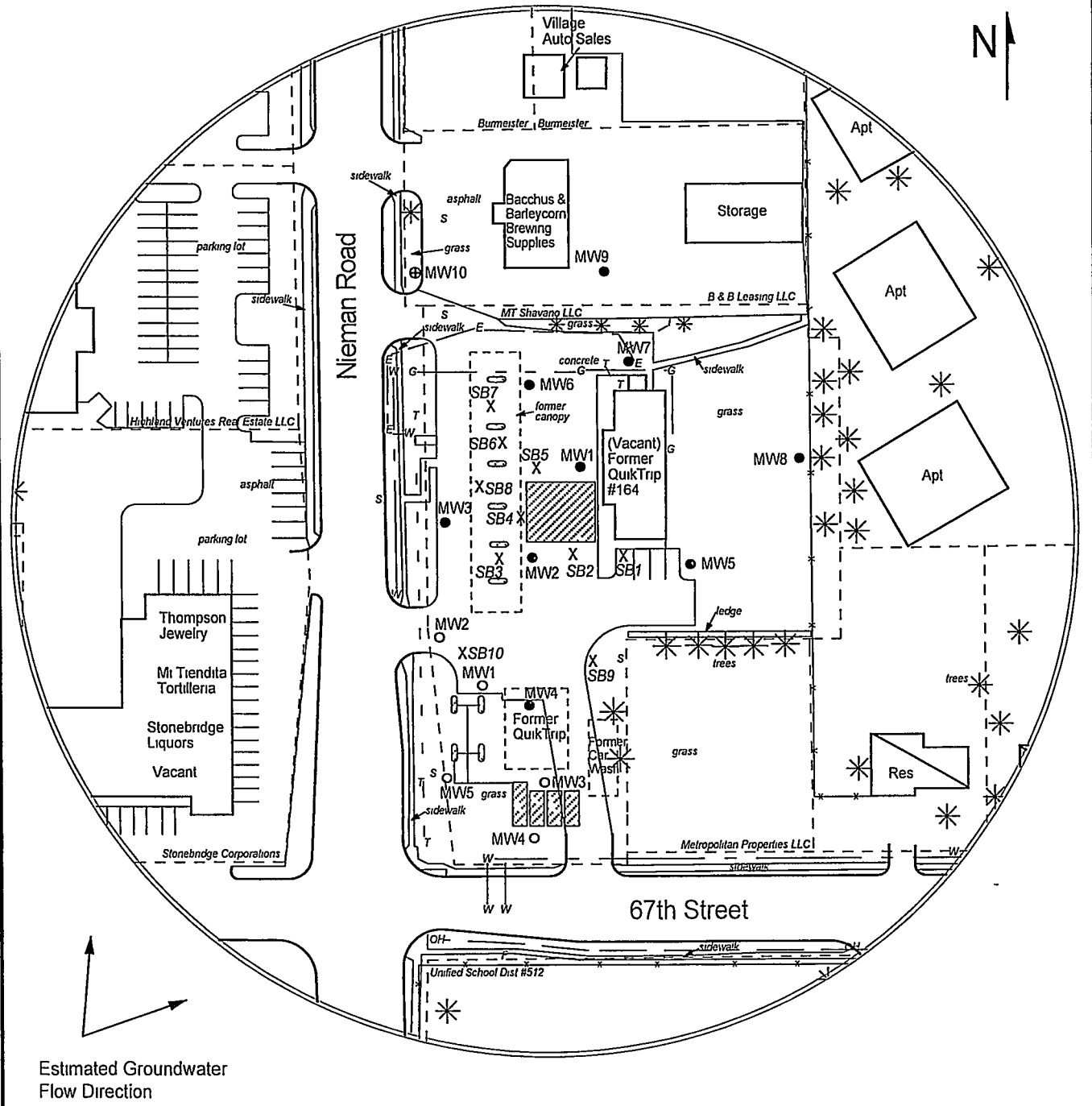

FIGURE 2.1 - 350 FT RADIUS AREA BASE MAP



1311 E 25th St Suite B 785-841-8707 office  
Lawrence, KS 66046 785-865-4282 fax

**PROJECT:**

Former QuikTrip #164  
6637 Nieman Road  
Shawnee, KS  
KDHE ID: U4-046-15231  
Date: 11/11-12/21

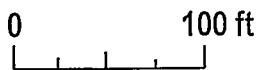

**LEGEND:**

- Approximate Location of Former UST Basin, Product Lines & Pump Islands
- Building with Basement
- Approximate Location of Property Line
- Existing Monitoring Well
- Plugged Well
- Monitoring Well (Installed 10/26/21)
- Soil Boring (Drilled 3/8-11/21)
- Fire Hydrant
- Sewer Inlet
- Electric Lines (1.5 - 3 ft bgs)
- Gas Lines (1.5 - 3 ft bgs)
- Overhead Lines (25'-40' high)
- Telephone Lines (2 - 6 ft bgs)
- Water Lines (1.5 - 3 ft bgs)

NOTE Utility depths, heights and locations are approximate  
NOTE SB9 & SB10 were drilled to collect hydrologic samples