

WATER WELL RECORD

Form WWC-5

Division of Water Resources App. No.

Well ID

MW5

[X] Original Record [ ] Correction [ ] Change in Well Use

1 LOCATION OF WATER WELL: County Johnson Fraction SE 1/4 SE 1/4 SE 1/4 NW 1/4 Section Number 11 Township Number T 12 S Range Number R 24 [X] E [ ] W

2 WELL OWNER: Last Name: Business: KDHE Address: 1000 SW Jackson Blvd City: Topeka State: KS ZIP: 66612 Street or Rural Address where well is located (if unknown, distance and direction from nearest town or intersection): ~130' W of 5833 Nieman Rd., Shawnee, KS

3 LOCATE WELL WITH "X" IN SECTION BOX: [Diagram showing a 4x4 grid with 'X' in the center square]

4 DEPTH OF COMPLETED WELL: 12.5 ft Depth(s) Groundwater Encountered: 1) \_\_\_\_\_ ft 2) \_\_\_\_\_ ft 3) \_\_\_\_\_ ft, or 4) [ ] Dry Well WELL'S STATIC WATER LEVEL: 9.1 ft. [X] below land surface, measured on (mo-day-yr) 2/25/2022 [ ] above land surface, measured on (mo-day-yr) \_\_\_\_\_ Pump test data: Well water was \_\_\_\_\_ ft after \_\_\_\_\_ hours pumping \_\_\_\_\_ gpm Water well was \_\_\_\_\_ ft after \_\_\_\_\_ hours pumping \_\_\_\_\_ gpm Estimated Yield: \_\_\_\_\_ gpm Bore Hole Diameter: 7.25 in to \_\_\_\_\_ ft, and \_\_\_\_\_ in to \_\_\_\_\_ ft

5 Latitude: 39.02210 (decimal degrees) Longitude: 94.71499 (decimal degrees) Horizontal Datum [X] WGS 84 [ ] NAD 83 [ ] NAD 27 Source for Latitude/Longitude: [ ] GPS (unit make/model: \_\_\_\_\_) (WAAS enabled? [ ] Yes [ ] No) [X] Land Survey [ ] Topographic Map [ ] Online Mapper

6 Elevation 992.6 ft [ ] Ground Level [X] TOC Source [X] Land Survey [ ] GPS [ ] Topographic Map [ ] Other \_\_\_\_\_

7 WELL WATER TO BE USED AS: 1 Domestic: [ ] Household [ ] Lawn & Garden [ ] Livestock [ ] Irrigation [ ] Feedlot [ ] Industrial 2 [ ] Public Water Supply: well ID 3 [ ] Dewatering: how many wells? 4 [ ] Aquifer Recharge: well ID 5 [X] Monitoring: well ID MWS 6 [ ] Environmental Remediation: well ID 7 [ ] Air Sparge [ ] Soil Vapor Extractor 8 [ ] Recovery [ ] Injection 9 [ ] Oil Field Water Supply: lease 10 [ ] Test Hole: well ID [ ] Cased [ ] Uncased [ ] Geotechnical 11 [ ] Geothermal: How many bores? a) Closed Loop [ ] Horizontal [ ] Vertical b) Open Loop [ ] Surface Discharge [ ] Inj. of Water [ ] Other (specify): \_\_\_\_\_

Was a chemical/bacteriological sample submitted to KDHE? [ ] Yes [X] No If yes, date sample was submitted: \_\_\_\_\_ Water well disinfected? [ ] Yes [X] No

8 TYPE OF CASING USED: [ ] Steel [X] PVC [ ] Other CASING JOINTS: [ ] Glued [ ] Clamped [ ] Welded [X] Threaded Casing diameter 2 in. to 3.5 ft, Diameter \_\_\_\_\_ in. to \_\_\_\_\_ ft, Diameter \_\_\_\_\_ in. to \_\_\_\_\_ ft, Casing height above land surface -0.29 in. Weight \_\_\_\_\_ lbs./ft. Well thickness or gauge No \_\_\_\_\_ TYPE OF SCREEN OR PERFORATION MATERIAL: [ ] Steel [ ] Stainless Steel [ ] Fiberglass [X] PVC [ ] Other (Specify) \_\_\_\_\_ [ ] Brass [ ] Galvanized Steel [ ] Concrete tile [ ] None used (open hole) SCREEN OR PERFORATION OPENINGS ARE: [ ] Continuous Slot [X] Mill Slot [ ] Gauze Wrapped [ ] Torch Cut [ ] Drilled Holes [ ] Other (Specify) \_\_\_\_\_ [ ] Louvered Shutter [ ] Key Punched [ ] Wire Wrapped [ ] Saw Cut [ ] None (Open Hole) SCREEN-PERFORATED INTERVALS: From 3.5 ft. to 12.5 ft, From \_\_\_\_\_ ft. to \_\_\_\_\_ ft, From \_\_\_\_\_ ft. to \_\_\_\_\_ ft, GRAVEL PACK INTERVALS: From 1.5 ft. to 12.5 ft, From \_\_\_\_\_ ft. to \_\_\_\_\_ ft, From \_\_\_\_\_ ft. to \_\_\_\_\_ ft,

9 GROUT MATERIAL: [ ] Neat cement [ ] Cement grout [X] Bentonite [X] Other Concrete: 0-0.5' Grout intervals: From 0.5 ft. to 1.5 ft, From \_\_\_\_\_ ft. to \_\_\_\_\_ ft, From \_\_\_\_\_ ft. to \_\_\_\_\_ ft.

Nearest source of possible contamination: [ ] Septic Tank [ ] Lateral Lines [ ] Pit Privy [ ] Livestock Pens [ ] Insecticide Storage [ ] Sewer Lines [ ] Cess Pool [ ] Sewage Lagoon [X] Fuel Storage [ ] Abandoned Water Well [ ] Watertight Sewer Lines [ ] Scepage Pit [ ] Feedyard [ ] Fertilizer Storage [ ] Oil Well / Gas Well [ ] Other (Specify) \_\_\_\_\_ Direction from well? E-NE Distance from well? ~150 ft

Table with 6 columns: FROM, TO, LITHOLOGIC LOG, FROM, TO, LITHO. LOG (cont.) or PLUGGING INTERVALS. Rows: 0-0.5 Asphalt, 0.5-0.8 Gravel fill, 0.8-11.5 Clay, 11.5-12.5 Shale

Notes: KDHE ID: Frank's OK Garage; U4-046-13752 Target of monitoring well is shallow groundwater, <20' of grout was installed at the direction of KDHE.

11 CONTRACTOR'S OR LANDOWNER'S CERTIFICATION: This water well was [X] constructed, [ ] reconstructed, or [ ] plugged under my jurisdiction and was completed on (mo-day-year) 1/25/22 and this record is true to the best of my knowledge and belief. Kansas Water Well Contractor's License No 757 This Water Well Record was completed on (mo-day-year) 3/7/22 under the business name of Larsen & Associates, Inc. Signature \_\_\_\_\_

John Cor.

# DENNIS L HANDKE

1820 NW 59th Terrace  
TOPEKA, KANSAS 66618  
785-286-4047 Home

Jess Chapman  
Larsen & Assoc.  
1311 E. 25<sup>th</sup> St., Suite B  
Lawrence, Kansas 66046

February 22, 2022

RE: Monitor Well Elevation Survey  
5833 Nieman Road, Shawnee, Kansas

Proj. 22-00K  
Frank's OK Garage  
KDHE ID U4-046-13752

Bench Mark: Square cut on West center of concrete pump island South of building.  
Elev.: 989.08      North 2708.65      West 2578.37      (from SE Cor. Sec. 11-12-24E)

MW-1	rim	988.37	North	2702.41	SW1/4,SW1/4,SW1/4,NE1/4
	top pipe	987.98	West	2573.10	Lat = 39.02220      Long = 94.71433
MW-2	rim	988.31	North	2690.18	SW1/4,SW1/4,SW1/4,NE1/4
	top pipe	987.77	West	2608.70	Lat = 39.02217      Long = 94.71446
MW-3	rim	989.55	North	2720.75	SW1/4,SW1/4,SW1/4,NE1/4
	top pipe	989.16	West	2449.91	Lat = 39.02225      Long = 94.71390
MW-4	rim	994.18	North	2789.94	SW1/4,SW1/4,SW1/4,NE1/4
	top pipe	993.69	West	2593.58	Lat = 39.02244      Long = 94.71441
MW-5	rim	992.89	North	2666.87	SE1/4,SE1/4,SE1/4,NW1/4
	top pipe	992.60	West	2761.42	Lat = 39.02210      Long = 94.71499
MW-6	rim	984.21	North	2608.44	NW1/4,NW1/4,NW1/4,SE1/4
	top pipe	983.82	West	2594.35	Lat = 39.02194      Long = 94.71441
MW-7	rim	987.64	North	2682.34	SW1/4,SW1/4,SW1/4,NE1/4
	top pipe	987.39	West	2448.63	Lat = 39.02215      Long = 94.71389
MW-8	rim	983.04	North	2537.48	NE1/4,NE1/4,NE1/4,SW1/4
	top pipe	982.50	West	2679.14	Lat = 39.02175      Long = 94.71470

Lat & Long derived from Shawnee 7.5' quad map. WGS84.

Elevation derived from Johnson County Bench Mark #848. NAVD 88

If you have any questions, please feel free to call me. Thank you for the opportunity to be of service to you.

March 10, 2022  
 Dennis L Handke RLS  

RECEIVED  
 MAR 22 2022  
 BUREAU OF WATER

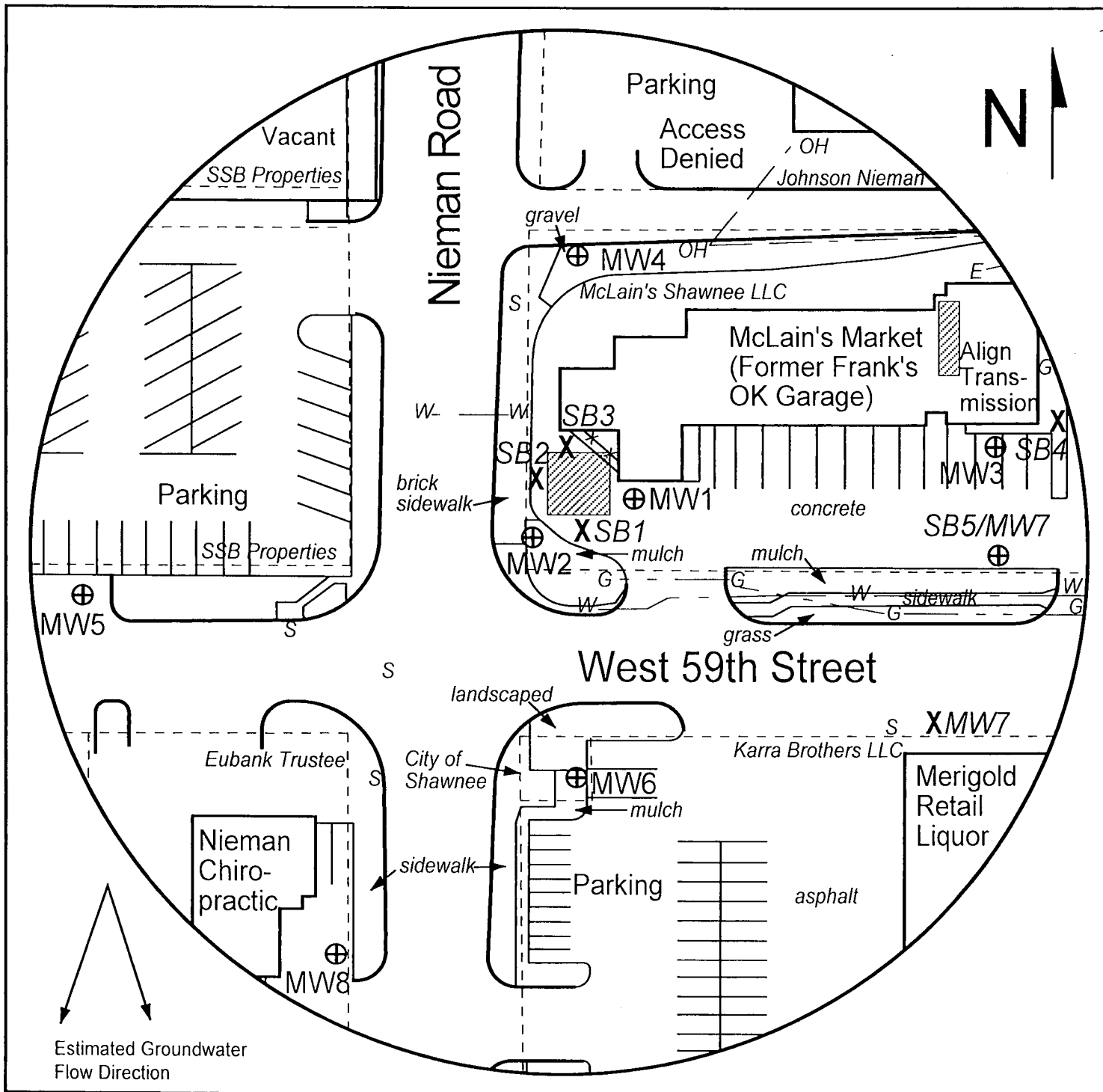

FIGURE 2.2 - DETAILED SITE BASE MAP

LEGEND

- Approximate Location of Former UST Basin
- Approximate Location of Property Line
- Monitoring Well (Installed 1/25-27/22)
- Soil Boring (Drilled 1/26-27/22)
- Sewer Inlet
- Electric Lines (2-6 ft bgs)
- Gas Lines (2-6 ft bgs)
- Overhead Lines (25'-40' high)
- Water Lines (2-6 ft bgs)

NOTE: MW7 was plugged due to utilities. SB5 drilled as MW7.  
 NOTE: SB5 & SB6 will be drilled to collect hydrologic samples.  
 NOTE: Utility depths, heights and locations are approximate.



PROJECT:

Frank's OK Garage  
 5833 Nieman Rd.  
 Shawnee, KS  
 KDHE ID: U4-046-13752  
 Date: 2/25/22



1311 E 25th St., Suite B (785) 841-8707 office  
 Lawrence, KS 66046 (785) 865-4282 fax