

WATER WELL RECORD

Form WWC-5

Division of Water Resources App. No.

Well ID

MW6

Original Record Correction Change in Well Ust

1 LOCATION OF WATER WELL: County Johnson Fraction NW 1/4 NW 1/4 NW 1/4 SE 1/4 Section Number 11 Township Number T 12 S Range Number R 24 E W

2 WELL OWNER: Last Name: Business: KDHE Address: 1000 SW Jackson Blvd City: Topeka State: KS ZIP: 66612 Street or Rural Address where well is located (if unknown, distance and direction from nearest town or intersection): ~50' S of 5833 Nieman Rd., Shawnee, KS

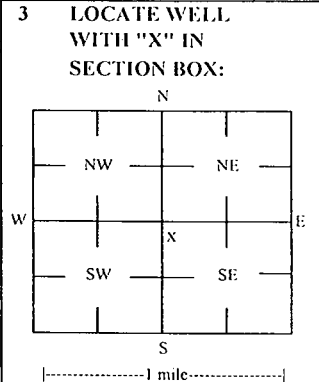

3 LOCATE WELL WITH 'X' IN SECTION BOX: 4 DEPTH OF COMPLETED WELL: 8.5 ft Depth(s) Groundwater Encountered: 1) 8.5 ft 2) 3) 4) Dry Well WELLS STATIC WATER LEVEL: Dry ft. below land surface, measured on (mo-day-yr) 2/25/2022

5 Latitude: 39.02194 (decimal degrees) Longitude: 94.71441 (decimal degrees) Horizontal Datum: X WGS 84 NAD 83 NAD 27 Source for Latitude/Longitude: GPS (unit make/model): (WAAS enabled? Yes No) X Land Survey Topographic Map Online Mapper 6 Elevation: 983.82 ft Ground Level: X TOC Source: X Land Survey GPS Topographic Map Other

7 WELL WATER TO BE USED AS: 1 Domestic: Household Lawn & Garden Livestock Irrigation Feedlot Industrial 2 Public Water Supply: well ID 3 Dewatering: how many wells? 4 Aquifer Recharge: well ID 5 Monitoring: well ID MW6 6 Environmental Remediation: well ID Air Sparge Soil Vapor Extractor Recovery Injection 7 Oil Field Water Supply: lease 8 Test Hole: well ID Cased Uncased Geotechnical 9 Geothermal: How many bores? a) Closed Loop Horizontal Vertical b) Open Loop Surface Discharge Inj. of Water Other (specify):

Was a chemical/bacteriological sample submitted to KDHE? Yes No X No If yes, date sample was submitted: Water well disinfected? Yes No X No

8 TYPE OF CASING USED: Steel PVC X Other CASING JOINTS: Glued Clamped Welded X Threaded Casing diameter 2 in. to 4 ft, Diameter in. to ft, Diameter in. to ft, Casing height above land surface -0.39 in. Weight lbs./ft. Well thickness or gauge No TYPE OF SCREEN OR PERFORATION MATERIAL: Steel Stainless Steel Fiberglass X PVC Brass Galvanized Steel Concrete tile None used (open hole) SCREEN OR PERFORATION OPENINGS ARE: Continuous Slot X Mill Slot Gauze Wrapped Torch Cut Drilled Holes Other (Specify) Louvered Shutter Key Punched Wire Wrapped Saw Cut None (Open Hole) SCREEN-PERFORATED INTERVALS: From 4 ft. to 8.5 ft, From ft. to ft, From ft. to ft, GRAVEL PACK INTERVALS: From 2 ft. to 8.5 ft, From ft. to ft, From ft. to ft.

9 GROUT MATERIAL: Neat cement Cement grout X Bentonite X Other Concrete: 0-0.5' Grout intervals: From 0.5 ft. to 2 ft, From ft. to ft, From ft. to ft.

Nearest source of possible contamination: Septic Tank Lateral Lines Pit Privy Livestock Pens Insecticide Storage Sewer Lines Cess Pool Sewage Lagoon X Fuel Storage Abandoned Water Well Watertight Sewer Lines Seepage Pit Feedyard Fertilizer Storage Oil Well / Gas Well Other (Specify): Direction from well? N Distance from well? ~90 ft

Table with 6 columns: FROM, TO, LITHOLOGIC LOG, FROM, TO, LITHO. LOG (cont.) or PLUGGING INTERVALS. Rows include Topsoil, Gravel fill, Clay, and Shale.

Notes: KDHE ID: Frank's OK Garage; U4-046-13752 Target of monitoring well is shallow groundwater, <20' of grout was installed at the direction of KDHE.

11 CONTRACTOR'S OR LANDOWNER'S CERTIFICATION: This water well was X constructed, reconstructed, or plugged under my jurisdiction and was completed on (mo-day-year) 1/25/22 and this record is true to the best of my knowledge and belief. Kansas Water Well Contractor's License No 757 This Water Well Record was completed on (mo-day-year) 3/7/22 under the business name of Larsen & Associates, Inc. Signature

John Cor.

# DENNIS L HANDKE

1820 NW 59th Terrace  
TOPEKA, KANSAS 66618  
785-286-4047 Home

Jess Chapman  
Larsen & Assoc.  
1311 E. 25<sup>th</sup> St., Suite B  
Lawrence, Kansas 66046

February 22, 2022

RE: Monitor Well Elevation Survey  
5833 Nieman Road, Shawnee, Kansas

Proj. 22-00K  
Frank's OK Garage  
KDHE ID U4-046-13752

Bench Mark: Square cut on West center of concrete pump island South of building.  
Elev.: 989.08      North 2708.65      West 2578.37      (from SE Cor. Sec. 11-12-24E)

MW-1	rim	988.37	North	2702.41	SW1/4,SW1/4,SW1/4,NE1/4
	top pipe	987.98	West	2573.10	Lat = 39.02220    Long = 94.71433
MW-2	rim	988.31	North	2690.18	SW1/4,SW1/4,SW1/4,NE1/4
	top pipe	987.77	West	2608.70	Lat = 39.02217    Long = 94.71446
MW-3	rim	989.55	North	2720.75	SW1/4,SW1/4,SW1/4,NE1/4
	top pipe	989.16	West	2449.91	Lat = 39.02225    Long = 94.71390
MW-4	rim	994.18	North	2789.94	SW1/4,SW1/4,SW1/4,NE1/4
	top pipe	993.69	West	2593.58	Lat = 39.02244    Long = 94.71441
MW-5	rim	992.89	North	2666.87	SE1/4,SE1/4,SE1/4,NW1/4
	top pipe	992.60	West	2761.42	Lat = 39.02210    Long = 94.71499
MW-6	rim	984.21	North	2608.44	NW1/4,NW1/4,NW1/4,SE1/4
	top pipe	983.82	West	2594.35	Lat = 39.02194    Long = 94.71441
MW-7	rim	987.64	North	2682.34	SW1/4,SW1/4,SW1/4,NE1/4
	top pipe	987.39	West	2448.63	Lat = 39.02215    Long = 94.71389
MW-8	rim	983.04	North	2537.48	NE1/4,NE1/4,NE1/4,SW1/4
	top pipe	982.50	West	2679.14	Lat = 39.02175    Long = 94.71470

Lat & Long derived from Shawnee 7.5' quad map. WGS84.

Elevation derived from Johnson County Bench Mark #848. NAVD 88

If you have any questions, please feel free to call me. Thank you for the opportunity to be of service to you.

March 10, 2022  
 Dennis L Handke RLS  
 785-286-4047



RECEIVED  
 MAR 22 2022  
 BUREAU OF WATER

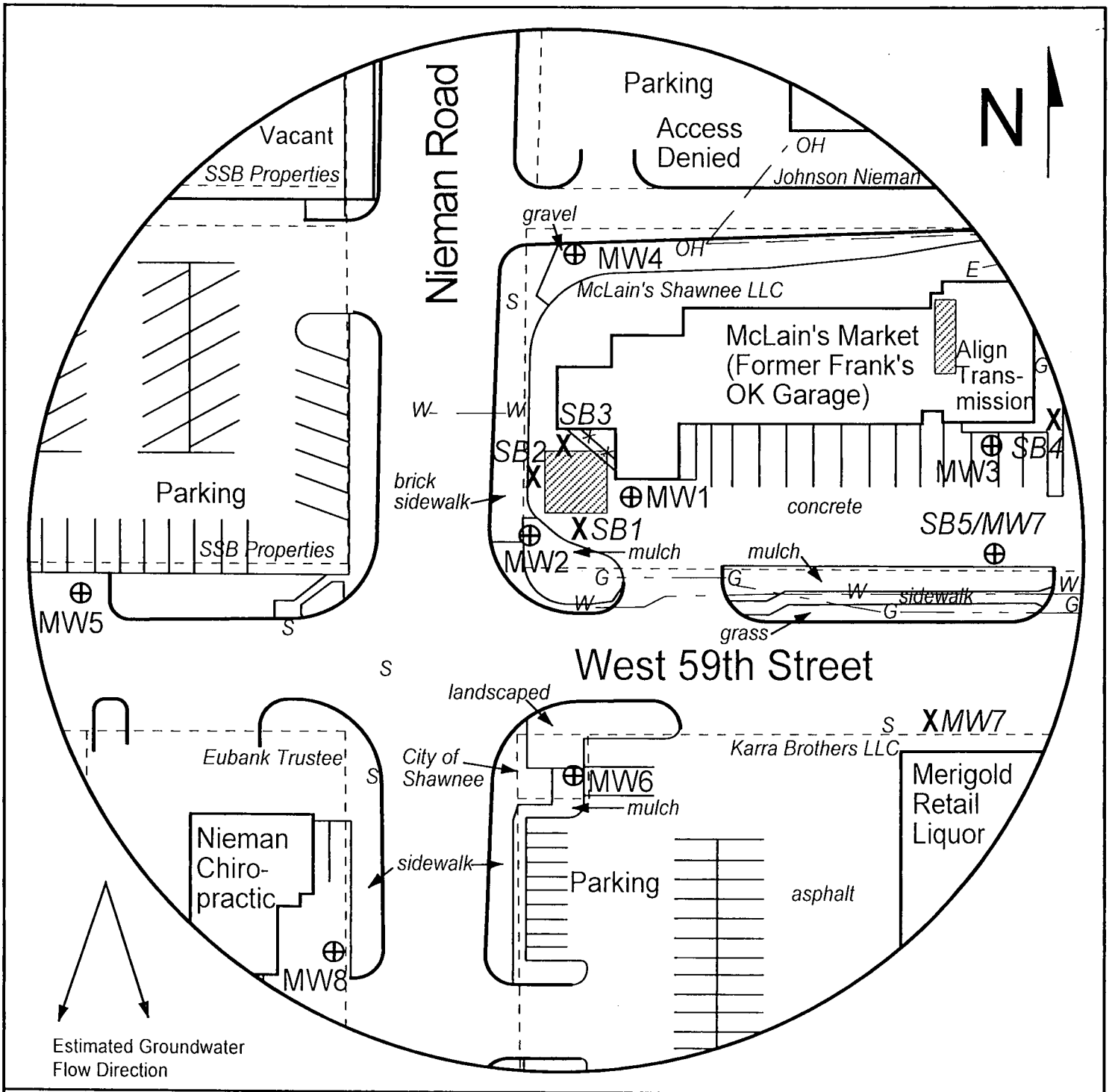

FIGURE 2.2 - DETAILED SITE BASE MAP



**PROJECT:**

Frank's OK Garage  
5833 Nieman Rd.  
Shawnee, KS  
KDHE ID: U4-046-13752  
Date: 2/25/22



**LEGEND**

- Approximate Location of Former UST Basin
- Approximate Location of Property Line
- Monitoring Well (Installed 1/25-27/22)
- Soil Boring (Drilled 1/26-27/22)
- Sewer Inlet
- Electric Lines (2-6 ft bgs)
- Gas Lines (2-6 ft bgs)
- Overhead Lines (25'-40' high)
- Water Lines (2-6 ft bgs)

NOTE: MW7 was plugged due to utilities. SB5 drilled as MW7.  
NOTE: SB5 & SB6 will be drilled to collect hydrologic samples.  
NOTE: Utility depths, heights and locations are approximate.

1311 E 25th St., Suite B (785) 841-8707 office  
Lawrence, KS 66046 (785) 865-4282 fax