

WATER WELL RECORD

Form WWC-5

Division of Water Resources App. No.

Well ID

MW7

Original Record Correction Change in Well Use

1 LOCATION OF WATER WELL: County Johnson Fraction SW 1/4 SW 1/4 SW 1/4 NE 1/4 Section Number 11 Township Number T 12 S Range Number R 24 E

2 WELL OWNER: Last Name: Business: KDHE Address: 1000 SW Jackson Blvd City: Topeka State: KS ZIP: 66612 Street or Rural Address where well is located (if unknown, distance and direction from nearest town or intersection): 5833 Nieman Rd., Shawnee, KS

3 LOCATE WELL WITH "X" IN SECTION BOX: NW NE SW SE X

4 DEPTH OF COMPLETED WELL: 15 ft Depth(s) Groundwater Encountered: 1) 15 ft 2) 3) 4) Dry Well WELL'S STATIC WATER LEVEL: 7.25 ft

5 Latitude: 39.02215 (decimal degrees) Longitude: 94.71389 (decimal degrees) Horizontal Datum: X WGS 84

6 Elevation: 987.39 ft Ground Level: X TOC Source: X Land Survey

7 WELL WATER TO BE USED AS: 1 Domestic: Household Lawn & Garden Livestock Irrigation Feedlot Industrial 5 Public Water Supply: well ID 6 Dewatering: how many wells? 7 Aquifer Recharge: well ID 8 X Monitoring: well ID MW7 9 Environmental Remediation: well ID 10 Oil Field Water Supply: lease 11 Test Hole: well ID 12 Geothermal: How many bores?

Was a chemical/bacteriological sample submitted to KDHE? Yes No X No If yes, date sample was submitted: Water well disinfected? Yes No X No

8 TYPE OF CASING USED: Steel X PVC Other CASING JOINTS: Glued Clamped Welded X Threaded Casing diameter 2 in. to 5 ft, Diameter in. to ft, Diameter in. to ft, Casing height above land surface -0.25 in. Weight lbs./ft. Well thickness or gauge No

9 GROUT MATERIAL: Neat cement Cement grout X Bentonite X Other Concrete: 0-0.5' Grout intervals: From 0.5 ft. to 3 ft, From ft. to ft, From ft. to ft

Nearest source of possible contamination: Septic Tank Lateral Lines Pit Privy Livestock Pens Insecticide Storage Sewer Lines Cess Pool Sewage Lagoon X Fuel Storage Abandoned Water Well Watertight Sewer Lines Seepage Pit Feedyard Fertilizer Storage Oil Well / Gas Well Other (Specify)

Table with 6 columns: FROM, TO, LITHOLOGIC LOG, FROM, TO, LITHO. LOG (cont.) or PLUGGING INTERVALS. Rows include 0-0.5 Concrete, 0.5-10 Clay, 10-11.5 Sandy clay, 11.5-15 Sandstone.

Notes: KDHE ID: Frank's OK Garage; U4-046-13752 Target of monitoring well is shallow groundwater, <20' of grout was installed at the direction of KDHE.

11 CONTRACTOR'S OR LANDOWNER'S CERTIFICATION: This water well was X constructed, reconstructed, or plugged under my jurisdiction and was completed on (mo-day-year) 1/27/22 and this record is true to the best of my knowledge and belief. Kansas Water Well Contractor's License No 757 This Water Well Record was completed on (mo-day-year) 3/7/22 under the business name of Larsen & Associates, Inc. Signature

John Cor

DENNIS L HANDKE

1820 NW 59th Terrace
TOPEKA, KANSAS 66618
785-286-4047 Home

Jess Chapman
Larsen & Assoc.
1311 E. 25th St., Suite B
Lawrence, Kansas 66046

February 22, 2022

RE: Monitor Well Elevation Survey
5833 Nieman Road, Shawnee, Kansas

Proj. 22-00K
Frank's OK Garage
KDHE ID U4-046-13752

Bench Mark: Square cut on West center of concrete pump island South of building.
Elev.: 989.08 North 2708.65 West 2578.37 (from SE Cor. Sec. 11-12-24E)

MW-1	rim	988.37	North	2702.41	SW1/4,SW1/4,SW1/4,NE1/4
	top pipe	987.98	West	2573.10	Lat = 39.02220 Long = 94.71433
MW-2	rim	988.31	North	2690.18	SW1/4,SW1/4,SW1/4,NE1/4
	top pipe	987.77	West	2608.70	Lat = 39.02217 Long = 94.71446
MW-3	rim	989.55	North	2720.75	SW1/4,SW1/4,SW1/4,NE1/4
	top pipe	989.16	West	2449.91	Lat = 39.02225 Long = 94.71390
MW-4	rim	994.18	North	2789.94	SW1/4,SW1/4,SW1/4,NE1/4
	top pipe	993.69	West	2593.58	Lat = 39.02244 Long = 94.71441
MW-5	rim	992.89	North	2666.87	SE1/4,SE1/4,SE1/4,NW1/4
	top pipe	992.60	West	2761.42	Lat = 39.02210 Long = 94.71499
MW-6	rim	984.21	North	2608.44	NW1/4,NW1/4,NW1/4,SE1/4
	top pipe	983.82	West	2594.35	Lat = 39.02194 Long = 94.71441
MW-7	rim	987.64	North	2682.34	SW1/4,SW1/4,SW1/4,NE1/4
	top pipe	987.39	West	2448.63	Lat = 39.02215 Long = 94.71389
MW-8	rim	983.04	North	2537.48	NE1/4,NE1/4,NE1/4,SW1/4
	top pipe	982.50	West	2679.14	Lat = 39.02175 Long = 94.71470

Lat & Long derived from Shawnee 7.5' quad map. WGS84.

Elevation derived from Johnson County Bench Mark #848. NAVD 88

If you have any questions, please feel free to call me. Thank you for the opportunity to be of service to you.



RECEIVED
MAR 22 2022
BUREAU OF WATER

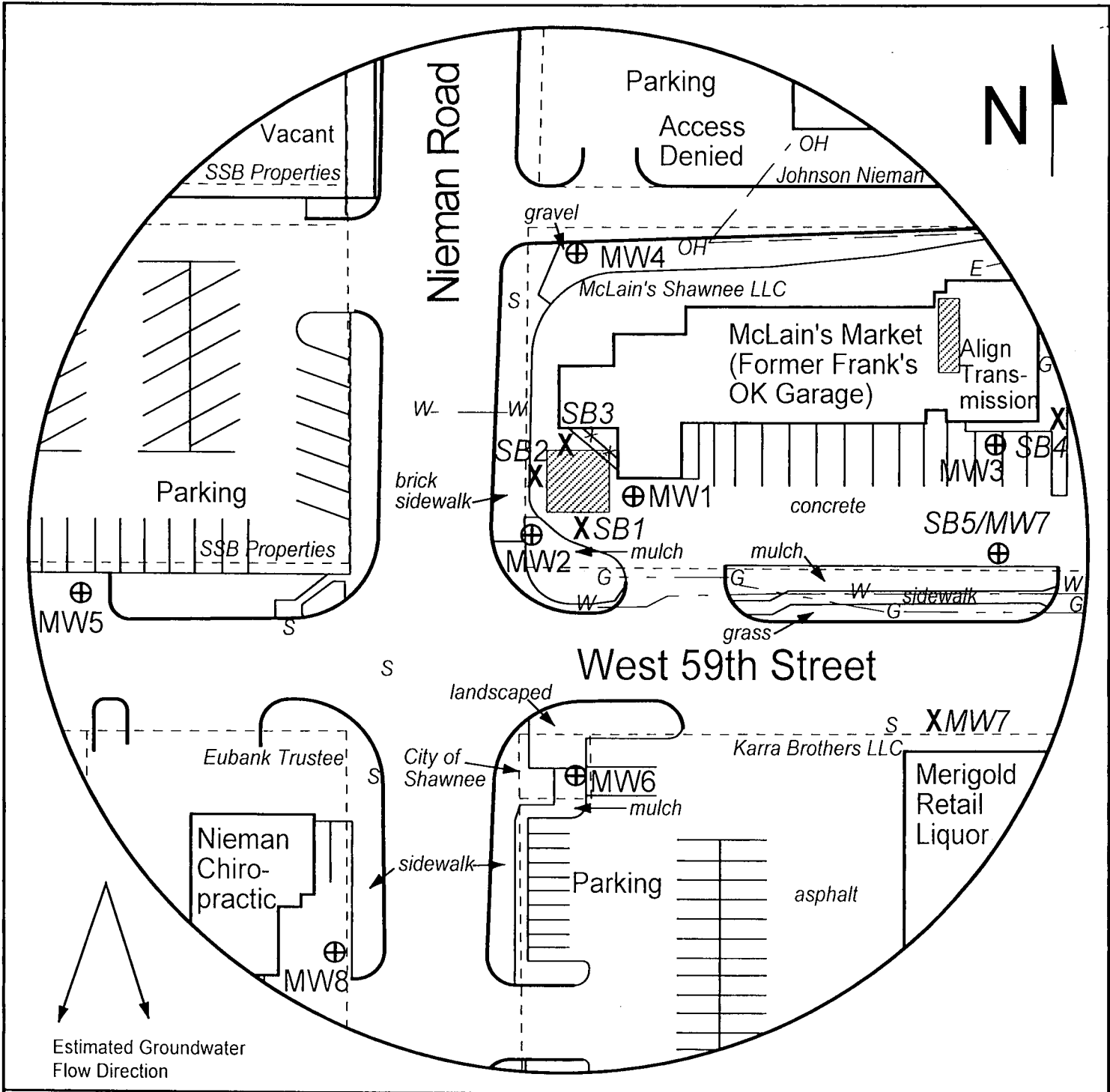

FIGURE 2.2 - DETAILED SITE BASE MAP

LEGEND

- Approximate Location of Former UST Basin
- Approximate Location of Property Line
- Monitoring Well (Installed 1/25-27/22)
- Soil Boring (Drilled 1/26-27/22)
- Sewer Inlet
- Electric Lines (2-6 ft bgs)
- Gas Lines (2-6 ft bgs)
- Overhead Lines (25'-40' high)
- Water Lines (2-6 ft bgs)

NOTE: MW7 was plugged due to utilities. SB5 drilled as MW7.
 NOTE: SB5 & SB6 will be drilled to collect hydrologic samples.
 NOTE: Utility depths, heights and locations are approximate.



PROJECT:
 Frank's OK Garage
 5833 Nieman Rd.
 Shawnee, KS
 KDHE ID: U4-046-13752
 Date: 2/25/22



1311 E 25th St., Suite B (785) 841-8707 office
 Lawrence, KS 66046 (785) 865-4282 fax