

**WATER WELL RECORD**

**Form WWC-5**

Division of Water Resources App. No.  

|  |  |  |                               |  |
|--|--|--|-------------------------------|--|
| <b>1 LOCATION OF WATER WELL:</b><br>County: Johnson  | Fraction<br><u>SE 1/4 SE 1/4 SE 1/4 NE 1/4</u> | Section Number<br><u>8</u>   | Township No.<br>T <u>12</u> S | Range Number<br>R <u>25</u> <input checked="" type="checkbox"/> E <input type="checkbox"/> W |
| Street/Rural Address of Well Location; if unknown, distance & direction from nearest town or intersection: If at owner's address, check here <input type="checkbox"/><br><br>5500 Johnson Drive<br>Mission, Kansas |  | <b>Global Positioning System (GPS) information:</b><br>Latitude: <u>N39.1.21.1"</u> (in decimal degrees)<br>Longitude: <u>W94.38.57.7"</u> (in decimal degrees)<br>Elevation: .....<br>Datum: <input type="checkbox"/> WGS 84, <input type="checkbox"/> NAD 83, <input type="checkbox"/> NAD 27<br>Collection Method:<br><input checked="" type="checkbox"/> GPS unit (Make/Model: <u>Garmin Nuvi 760</u> )<br><input type="checkbox"/> Digital Map/Photo, <input type="checkbox"/> Topographic Map, <input type="checkbox"/> Land Survey<br>Est. Accuracy: <input type="checkbox"/> <3 m, <input type="checkbox"/> 3-5 m, <input type="checkbox"/> 5-15 m, <input type="checkbox"/> >15 m |                               |  |
| <b>2 WATER WELL OWNER:</b><br>RR#, Street Address, Box #: <u>BP Products North America</u><br>City, State, ZIP Code: <u>28100 Torch Pkwy</u><br><u>Warrenville, IL 60555</u>                                       |  |  |                               |  |

|   |    |    |    |    |   |
|---|----|----|----|----|---|
| <b>3 LOCATE WELL WITH AN "X" IN SECTION BOX:</b><br>N<br><table style="width: 100%; text-align: center; border-collapse: collapse;"> <tr> <td style="border: 1px solid black; padding: 5px;">NW</td> <td style="border: 1px solid black; padding: 5px;">NE</td> </tr> <tr> <td style="border: 1px solid black; padding: 5px;">SW</td> <td style="border: 1px solid black; padding: 5px;">SE</td> </tr> </table> S<br> -----  mile ----- | NW | NE | SW | SE | <b>4 DEPTH OF COMPLETED WELL <u>18.12</u></b> ft.<br>Depth(s) Groundwater Encountered (1) <u>10</u> ft. (2) ..... ft. (3) ..... ft.<br>WELL'S STATIC WATER LEVEL <u>4.20</u> ft. below land surface measured on mo/day/yr. <u>12/05/09</u><br>Pump test data: Well water was ..... ft. after ..... hours pumping ..... gpm<br>EST. YIELD ..... gpm. Well water was ..... ft. after ..... hours pumping ..... gpm<br>Bore Hole Diameter <u>8.25</u> in. to <u>18.12</u> ft., and ..... in. to ..... ft.<br>WELL WATER TO BE USED AS: <input type="checkbox"/> Public water supply <input type="checkbox"/> Geothermal <input type="checkbox"/> Injection well<br><input type="checkbox"/> Domestic <input type="checkbox"/> Feedlot <input type="checkbox"/> Oil field water supply <input type="checkbox"/> Dewatering <input type="checkbox"/> Other (Specify below)<br><input type="checkbox"/> Irrigation <input type="checkbox"/> Industrial <input type="checkbox"/> Domestic-lawn & garden <input checked="" type="checkbox"/> Monitoring well <u>MW-3</u><br>Was a chemical/bacteriological sample submitted to Department? <input type="checkbox"/> Yes <input checked="" type="checkbox"/> No<br>If yes, mo/day/yr sample was submitted .....<br>Water well disinfected? <input type="checkbox"/> Yes <input checked="" type="checkbox"/> No |
| NW  | NE |    |    |    |   |
| SW  | SE |    |    |    |   |

**5 TYPE OF CASING USED:**  Steel  PVC  Other .....  
**CASING JOINTS:**  Glued  Clamped  Welded  Threaded  
 Casing diameter 2 in. to 18.12 ft., Diameter ..... in. to ..... ft., Diameter ..... in. to ..... ft.  
 Casing height above land surface 0 in., Weight ..... lbs./ft., Wall thickness or gauge No. Sch. 40  
**TYPE OF SCREEN OR PERFORATION MATERIAL:**  
 Steel  Stainless Steel  PVC  Other (Specify) .....  
 Brass  Galvanized Steel  None used (open hole)  
**SCREEN OR PERFORATION OPENINGS ARE:**  
 Continuous slot  Mill slot  Gauze wrapped  Torch cut  Drilled holes  None (open hole)  
 Louvered shutter  Key punched  Wire wrapped  Saw cut  Other (specify) .....  
**SCREEN-PERFORATED INTERVALS:** From 4 ft. to 18.12 ft., From ..... ft. to ..... ft.  
 From ..... ft. to ..... ft., From ..... ft. to ..... ft.  
**GRAVEL PACK INTERVALS:** From 3 ft. to 18.12 ft., From ..... ft. to ..... ft.  
 From ..... ft. to ..... ft., From ..... ft. to ..... ft.

**6 GROUT MATERIAL:**  Neat cement  Cement grout  Bentonite  Other Concrete from 0 to 1ft.  
 Grout Intervals: From 1 ft. to 3 ft., From ..... ft. to ..... ft., From ..... ft. to ..... ft.  
 What is the nearest source of possible contamination:  
 Septic tank  Lateral lines  Pit privy  Livestock pens  Insecticide storage  Other (specify below)  
 Sewer lines  Cesspool  Sewage lagoon  Fuel storage  Abandoned water well  
 Watertight sewer lines  Seepage pit  Feedyard  Fertilizer storage  Oil well/gas well .....  
 Direction from well ..... Distance from well .....

| FROM | TO | LITHOLOGIC LOG   | FROM | TO | LITHO. LOG (cont.) or PLUGGING INTERVALS |
|------|----|------------------|------|----|--|
| 0    | 1  | Asphalt          |      |    |  |
| 1    | 12 | Grey, silty CLAY |      |    |  |
|      |    |                  |      |    |  |
|      |    |                  |      |    |  |
|      |    |                  |      |    |  |
|      |    |                  |      |    |  |
|      |    |                  |      |    |  |

CORRECTED

**7 CONTRACTOR'S OR LANDOWNER'S CERTIFICATION:** This water well was  constructed,  reconstructed, or  plugged under my jurisdiction and was completed on (mo/day/year) 12-4-09 and this record is true to the best of my knowledge and belief.  
 Kansas Water Well Contractor's License No. 759 This Water Well Record was completed on (mo/day/year) 12-13-09  
 under the business name of RAZEK Environmental, LLC by (signature) [Signature]  
**INSTRUCTIONS:** Use typewriter or ball point pen. PLEASE PRESS FIRMLY and PRINT clearly. Please fill in blanks and check the correct answers. Send three copies (white, blue, pink) to Kansas Department of Health and Environment, Bureau of Water, Geology Section, 1000 SW Jackson St., Suite 420, Topeka, Kansas 66612-1367. Telephone 785-296-5522. Send one copy to WATER WELL OWNER and retain one for your records. Include fee of \$5.00 for each constructed well. Visit us at <http://www.kdheks.gov/waterwell/index.html>.

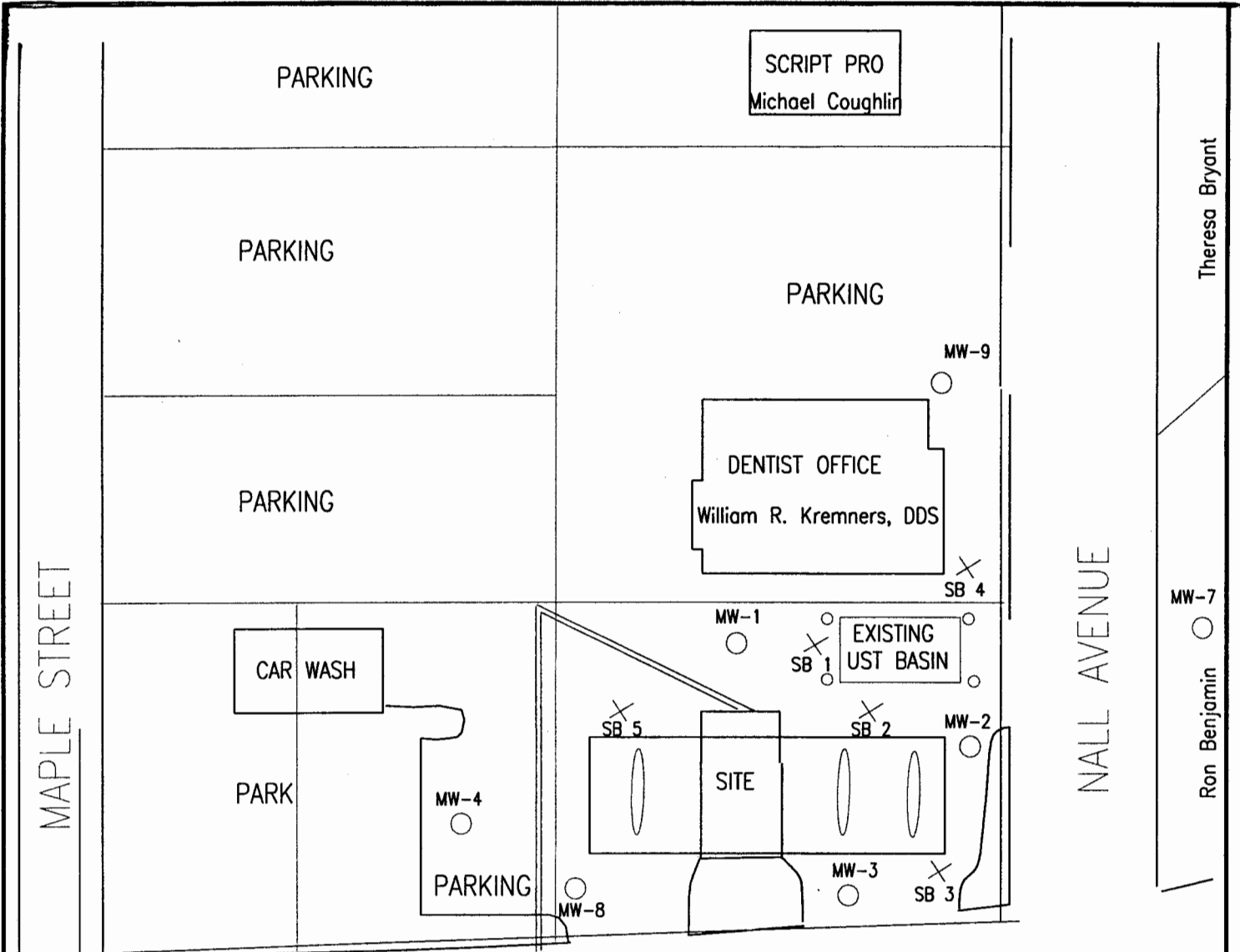

JOHNSON DRIVE

ANTICIPATED GROUNDWATER FLOW DIRECTION



- EXISTING OBSERVATION WELL
- × SOIL BORING
- MONITORING WELL
- WATER/GAS/ELECTRIC/SEWER SUBSURFACE (1-4 FT BGS) UTILITIES
- PROPERTY BOUNDARIES
- EXISTING PUMP ISLAND

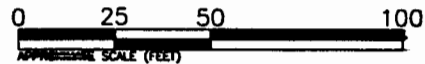
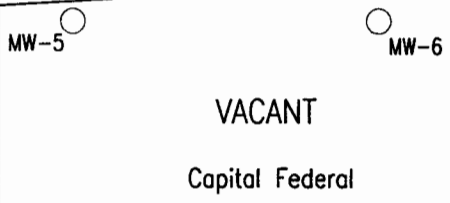

|                  |              |
|------------------|--------------|
| PROJ. # 17102596 | PAGE #       |
| SCALE: AS SHOWN  | DRAWN BY: RB |
| FILE NO.         | DESIGNED BY: |
| DATE: 9-30-09    | APPROVED BY: |



FIGURE 2  
SITE PLAN  
JOHNSON DRIVE BP  
5500 JOHNSON DRIVE  
MISSION, KS  
U4-046-14020