

# WATER WELL PLUGGING RECORD Form WWC-5P

KSA 82a-1212

ID NO.

MW-8

<b>1 LOCATION OF WATER WELL:</b> County: Johnson	Fraction $\frac{1}{4}$ SE $\frac{1}{4}$ SE $\frac{1}{4}$ NE $\frac{1}{4}$	Section Number 30	Township Number T 12 S	Range Number 25 <input checked="" type="checkbox"/> E <input type="checkbox"/> W
---	--	----------------------	---------------------------	---

Street/Rural Address of Well Location; if unknown, distance & direction from nearest town or intersection: If at owner's address, check here ☐ Former TPI #4166  
8212 Metcalf  
Overland Park, KS 66204

## Global Positioning Systems (GPS) information:

Latitude: 38.97920 (in decimal degrees)  
Longitude: -94.66803 (in decimal degrees)  
Elevation: 1146  
Horizontal Datum: ☒ WGS84, ☐ NAD83, ☐ NAD27  
Collection Method:

**2 WATER WELL OWNER:** The Valero Company  
RR#, St. Address, Box #: PO Box 278  
City, State ZIP Code: Eastlake, CO 80614

☐ GPS unit (Make/Model: \_\_\_\_\_)  
☐ Digital Map/Photo, ☒ Topographic Map, ☐ Land Survey  
Est. Accuracy: ☒ < 3 m, ☐ 3-5 m, ☐ 5-15 m, ☐ > 15 m

## 3 MARK WELL'S LOCATION WITH AN "X" IN SECTION BOX:

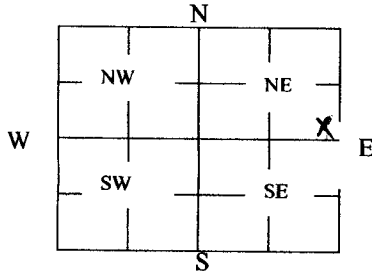

## 4 DEPTH OF WELL 9.0 ft.

WELL'S STATIC WATER LEVEL Dry \_\_\_\_\_ ft

WELL WAS USED AS:

<input type="checkbox"/> Domestic	<input type="checkbox"/> Public Water Supply	<input type="checkbox"/> Dewatering
<input type="checkbox"/> Irrigation	<input type="checkbox"/> Oil Field Water Supply	<input checked="" type="checkbox"/> Monitoring
<input type="checkbox"/> Feedlot	<input type="checkbox"/> Domestic (Lawn & Garden)	<input type="checkbox"/> Injection Well
<input type="checkbox"/> Industrial	<input type="checkbox"/> Air Conditioning	<input type="checkbox"/> Other MW-8

Was a chemical/bacteriological sample submitted to Department? Yes ☐ No ☒

## 5 TYPE OF BLANK CASING USED:

☐ Steel ☐ RMP (SR) ☐ Wrought ☐ Fiberglass ☐ Other (Specify below)  
☒ PVC ☐ ABS ☐ Asbestos-Cement ☐ Concrete Tile

Blank casing diameter 2 in. Was casing pulled? Yes ☒ No ☐ If yes, how much 9.0  
Casing height above or below land surface 0 in.

## 6 GROUT PLUG MATERIAL: ☐ Neat cement ☐ Cement grout ☐ Bentonite ☐ Other \_\_\_\_\_

Grout Plug Intervals: From N/A ft. to N/A ft., From N/A ft. to N/A ft., From N/A ft. to N/A ft.

What is the nearest source of possible contamination:

<input type="checkbox"/> Septic tank	<input type="checkbox"/> Seepage pit	<input checked="" type="checkbox"/> Fuel storage	<input type="checkbox"/> Other (specify below) _____
<input type="checkbox"/> Sewer lines	<input type="checkbox"/> Pit privy	<input type="checkbox"/> Fertilizer storage	
<input type="checkbox"/> Watertight sewer lines	<input type="checkbox"/> Sewage lagoon	<input type="checkbox"/> Insecticide storage	
<input type="checkbox"/> Lateral lines	<input type="checkbox"/> Feedyard	<input type="checkbox"/> Abandoned water well	
<input type="checkbox"/> Cess pool	<input type="checkbox"/> Livestock pens	<input type="checkbox"/> Oil well/Gas well	

Direction from well? North  
How many feet? 200

FROM	TO	PLUGGING MATERIALS	FROM	TO	PLUGGING MATERIALS
0	9.0	Well was drilled deeper in same boring.			

**7 CONTRACTOR'S OR LANDOWNER'S CERTIFICATION:** This water well was plugged under my jurisdiction and was completed on (mo/day/year) 8/29/2022 and this record is true to the best of my knowledge and belief. Kansas Water Well Contractor's License No. 759. This Water Well Record was completed on (mo/day/year) 9/15/2022 under the business name of RAZEK Environmental, LLC by (signature) \_\_\_\_\_

Send one white copy to Kansas Department of Health & Environment, Geology Section, 1000 SW Jackson Street, Ste. 420, Topeka, KS 66612-1367. Send one copy to WATER WELL OWNER and retain one for your records.  
Visit us at <http://www.kdheks.gov/waterwell/index.html> Telephone 785-296-5524.

KSA82a-1212

Revised 1/20/2015

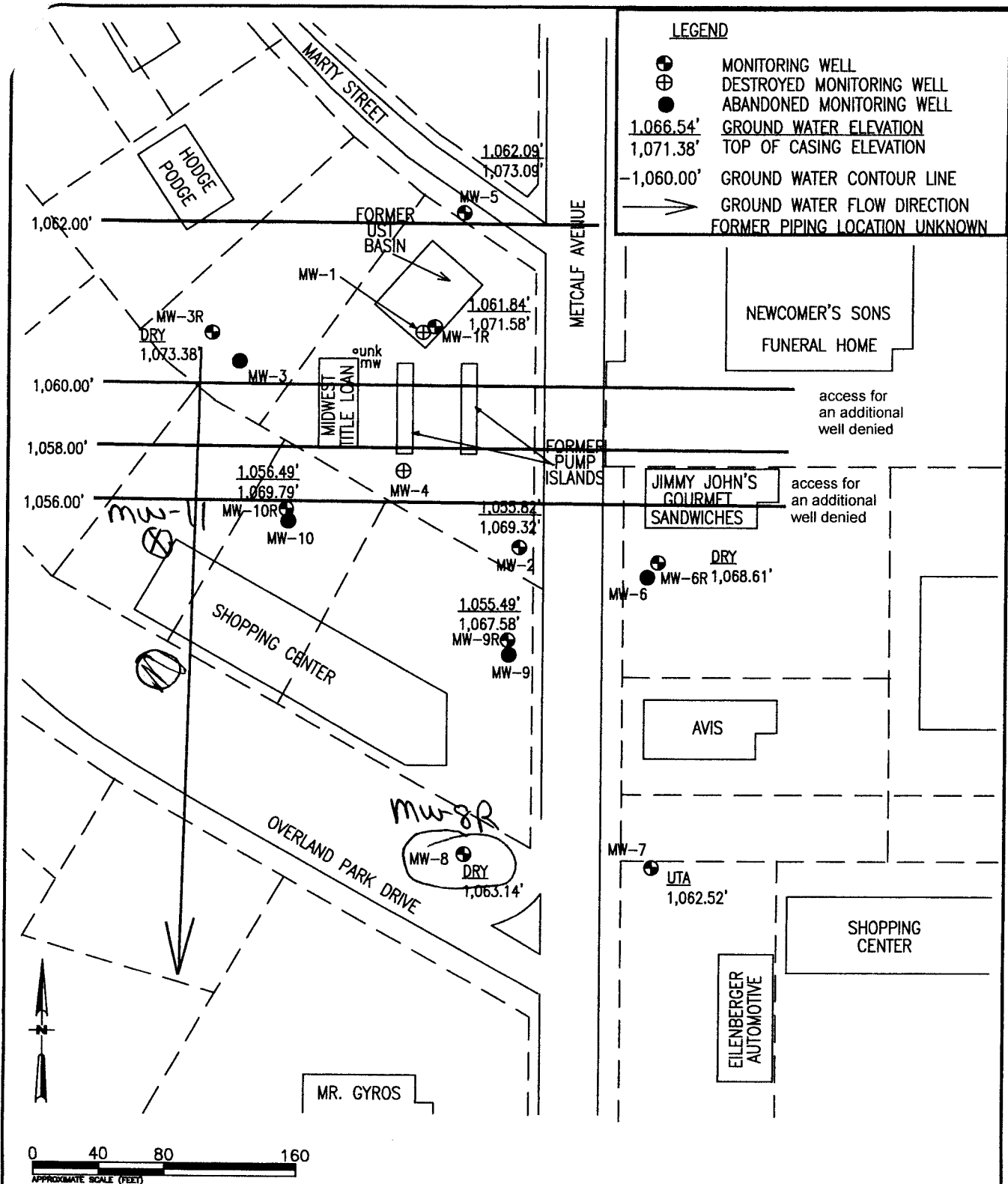

PROJ.# 17102398	PAGE#
SCALE: AS SHOWN	DRAWN BY:
FILE NO. 2398-F1	DESIGNED BY:
DATE:	APPROVED BY:

Terranext

FIGURE 1  
GROUNDWATER FLOW MAP  
SEPTEMBER 17, 2021  
TOTAL #4166 (U4-046-13341)  
8212 METCALF AVENUE  
OVERLAND PARK, KANSAS