

MW-8R

☒ Original Record ☐ Correction ☐ Change in Well Use

Well ID

1 LOCATION OF WATER WELL: County: Johnson		Fraction $\frac{1}{4}$ SE $\frac{1}{4}$ SE $\frac{1}{4}$ NE $\frac{1}{4}$	Section Number 30	Township Number T 12 S	Range Number R 25 E W																																																																								
2 WELL OWNER: Last Name: Business: The Valero Company (Former TPI #4166) Address: PO Box 278 City: Eastlake State: CO ZIP: 80614		Street or Rural Address where well is located (if unknown, distance and direction from nearest town or intersection): If at owner's address, check here: <input type="checkbox"/> 8212 Metcalf Avenue Overland Park, KS 66204																																																																											
3 LOCATE WELL WITH "X" IN SECTION BOX: N W E S 1 mile	4 DEPTH OF COMPLETED WELL: 20.0 ft. Depth(s) Groundwater Encountered: 1) 10 ft. 2) N/A ft. 3) N/A ft., or 4) <input type="checkbox"/> Dry Well WELL'S STATIC WATER LEVEL: 9.94 ft. <input checked="" type="checkbox"/> below land surface, measured on (mo-day-yr)..... <input type="checkbox"/> above land surface, measured on (mo-day-yr)..... Pump test data: Well water was N/A ft. after N/A hours pumping N/A gpm Well water was N/A ft. after N/A hours pumping N/A gpm Estimated Yield: N/A gpm Bore Hole Diameter: 8.25 in. to 8.5 ft. and 6.0 in. to 20.0 ft.		5 Latitude: 38.97920(decimal degrees) Longitude: -94.66803(decimal degrees) <u>Horizontal Datum:</u> <input checked="" type="checkbox"/> WGS 84 <input checked="" type="checkbox"/> NAD 83 <input type="checkbox"/> NAD 27 <u>Source for Latitude/Longitude:</u> <input type="checkbox"/> GPS (unit make/model:) (WAAS enabled? <input type="checkbox"/> Yes <input type="checkbox"/> No) <input type="checkbox"/> Land Survey <input type="checkbox"/> Topographic Map <input checked="" type="checkbox"/> Online Mapper: KGS Mapper																																																																										
	6 Elevation: 1146.00 ft. <input checked="" type="checkbox"/> Ground Level <input type="checkbox"/> TOC <u>Source:</u> <input type="checkbox"/> Land Survey <input type="checkbox"/> GPS <input type="checkbox"/> Topographic Map <input checked="" type="checkbox"/> Other Google Earth																																																																												
7 WELL WATER TO BE USED AS: 1. Domestic: <input type="checkbox"/> Household <input type="checkbox"/> Lawn & Garden <input type="checkbox"/> Livestock 2. <input type="checkbox"/> Irrigation 3. <input type="checkbox"/> Feedlot 4. <input type="checkbox"/> Industrial 5. <input type="checkbox"/> Public Water Supply: well ID 6. <input type="checkbox"/> Dewatering: how many wells? 7. <input type="checkbox"/> Aquifer Recharge: well ID 8. <input checked="" type="checkbox"/> Monitoring: well ID MW-8R 9. Environmental Remediation: well ID <input type="checkbox"/> Air Sparge <input type="checkbox"/> Soil Vapor Extraction <input type="checkbox"/> Recovery <input type="checkbox"/> Injection 10. <input type="checkbox"/> Oil Field Water Supply: lease 11. Test Hole: well ID <input type="checkbox"/> Cased <input type="checkbox"/> Uncased <input type="checkbox"/> Geotechnical 12. Geothermal: how many bores? a) Closed Loop <input type="checkbox"/> Horizontal <input type="checkbox"/> Vertical b) Open Loop <input type="checkbox"/> Surface Discharge <input type="checkbox"/> Inj. of Water 13. <input type="checkbox"/> Other (specify):																																																																													
Was a chemical/bacteriological sample submitted to KDHE? <input type="checkbox"/> Yes <input checked="" type="checkbox"/> No If yes, date sample was submitted: Water well disinfected? <input type="checkbox"/> Yes <input checked="" type="checkbox"/> No																																																																													
8 TYPE OF CASING USED: <input type="checkbox"/> Steel <input checked="" type="checkbox"/> PVC <input type="checkbox"/> Other CASING JOINTS: <input type="checkbox"/> Glued <input type="checkbox"/> Clamped <input type="checkbox"/> Welded <input checked="" type="checkbox"/> Threaded Casing diameter 2 in. to 10 ft., Diameter N/A in. to N/A ft., Diameter N/A in. to N/A ft. Casing height above land surface 0 in. Weight N/A lbs./ft. Wall thickness or gauge No. Sch. 40 TYPE OF SCREEN OR PERFORATION MATERIAL: <input type="checkbox"/> Steel <input type="checkbox"/> Stainless Steel <input type="checkbox"/> Fiberglass <input checked="" type="checkbox"/> PVC <input type="checkbox"/> Other (Specify) <input type="checkbox"/> Brass <input type="checkbox"/> Galvanized Steel <input type="checkbox"/> Concrete tile <input type="checkbox"/> None used (open hole) SCREEN OR PERFORATION OPENINGS ARE: <input type="checkbox"/> Continuous Slot <input checked="" type="checkbox"/> Mill Slot <input type="checkbox"/> Gauze Wrapped <input type="checkbox"/> Torch Cut <input type="checkbox"/> Drilled Holes <input type="checkbox"/> Other (Specify) <input type="checkbox"/> Louvered Shutter <input type="checkbox"/> Key Punched <input type="checkbox"/> Wire Wrapped <input type="checkbox"/> Saw Cut <input type="checkbox"/> None (Open Hole) SCREEN-PERFORATED INTERVALS: From 10.0 ft. to 20.0 ft., From N/A ft. to N/A ft., From N/A ft. to N/A ft. GRAVEL PACK INTERVALS: From 8.0 ft. to 20.0 ft., From N/A ft. to N/A ft., From N/A ft. to N/A ft.																																																																													
9 GROUT MATERIAL: <input type="checkbox"/> Neat cement <input type="checkbox"/> Cement grout <input checked="" type="checkbox"/> Bentonite <input checked="" type="checkbox"/> Other Concrete 0 to 2 Grout intervals: From 2 ft. to 8.0 ft., From N/A ft. to N/A ft., From N/A ft. to N/A ft. Nearest source of possible contamination: <input type="checkbox"/> Septic Tank <input type="checkbox"/> Lateral Lines <input type="checkbox"/> Pit Privy <input type="checkbox"/> Livestock Pens <input type="checkbox"/> Insecticide Storage <input type="checkbox"/> Sewer Lines <input type="checkbox"/> Cess Pool <input type="checkbox"/> Sewage Lagoon <input type="checkbox"/> Fuel Storage <input type="checkbox"/> Abandoned Water Well <input type="checkbox"/> Watertight Sewer Lines <input type="checkbox"/> Seepage Pit <input type="checkbox"/> Feedyard <input type="checkbox"/> Fertilizer Storage <input type="checkbox"/> Oil Well/Gas Well <input type="checkbox"/> Other (Specify) Direction from well? North Distance from well? 200 ft.																																																																													
<table border="1" style="width:100%;"> <thead> <tr> <th>FROM</th> <th>TO</th> <th>LITHOLOGIC LOG</th> <th>FROM</th> <th>TO</th> <th>LITHO. LOG (cont.) or PLUGGING INTERVALS</th> </tr> </thead> <tbody> <tr> <td>0</td> <td>1</td> <td>Concrete well pad/manhole cover</td> <td></td> <td></td> <td></td> </tr> <tr> <td>1</td> <td>8.5</td> <td>clay</td> <td></td> <td></td> <td></td> </tr> <tr> <td>8.5</td> <td>20.0</td> <td>Limestone</td> <td></td> <td></td> <td></td> </tr> <tr><td> </td><td> </td><td> </td><td> </td><td> </td><td> </td></tr> <tr><td> </td><td> </td><td> </td><td> </td><td> </td><td> </td></tr> <tr><td> </td><td> </td><td> </td><td> </td><td> </td><td> </td></tr> <tr><td> </td><td> </td><td> </td><td> </td><td> </td><td> </td></tr> <tr><td> </td><td> </td><td> </td><td> </td><td> </td><td> </td></tr> <tr><td> </td><td> </td><td> </td><td> </td><td> </td><td> </td></tr> <tr><td> </td><td> </td><td> </td><td> </td><td> </td><td> </td></tr> <tr><td> </td><td> </td><td> </td><td> </td><td> </td><td> </td></tr> </tbody> </table>		FROM	TO	LITHOLOGIC LOG	FROM	TO	LITHO. LOG (cont.) or PLUGGING INTERVALS	0	1	Concrete well pad/manhole cover				1	8.5	clay				8.5	20.0	Limestone																																																				Notes: <div style="height: 100px;"></div>			
FROM	TO	LITHOLOGIC LOG	FROM	TO	LITHO. LOG (cont.) or PLUGGING INTERVALS																																																																								
0	1	Concrete well pad/manhole cover																																																																											
1	8.5	clay																																																																											
8.5	20.0	Limestone																																																																											
11 CONTRACTOR'S OR LANDOWNER'S CERTIFICATION: This water well was <input checked="" type="checkbox"/> constructed, <input type="checkbox"/> reconstructed, or <input type="checkbox"/> plugged under my jurisdiction and was completed on (mo-day-year) 8/29/2022 and this record is true to the best of my knowledge and belief. Kansas Water Well Contractor's License No. 759 This Water Well Record was completed on (mo-day-year) 9/15/2022 under the business name of RAZEK Environmental, LLC Signature _____ Mail 1 white copy along with a fee of \$5.00 for each constructed well to: Kansas Department of Health and Environment, Bureau of Water, GWTS Section, 1000 SW Jackson St., Suite 420, Topeka, Kansas 66612-1367. Mail one to Water Well Owner and retain one for your records. Telephone 785-296-5524. Visit us at http://www.kdheks.gov/waterwell/index.html KSA 82a-1212 Revised 7/10/2015																																																																													

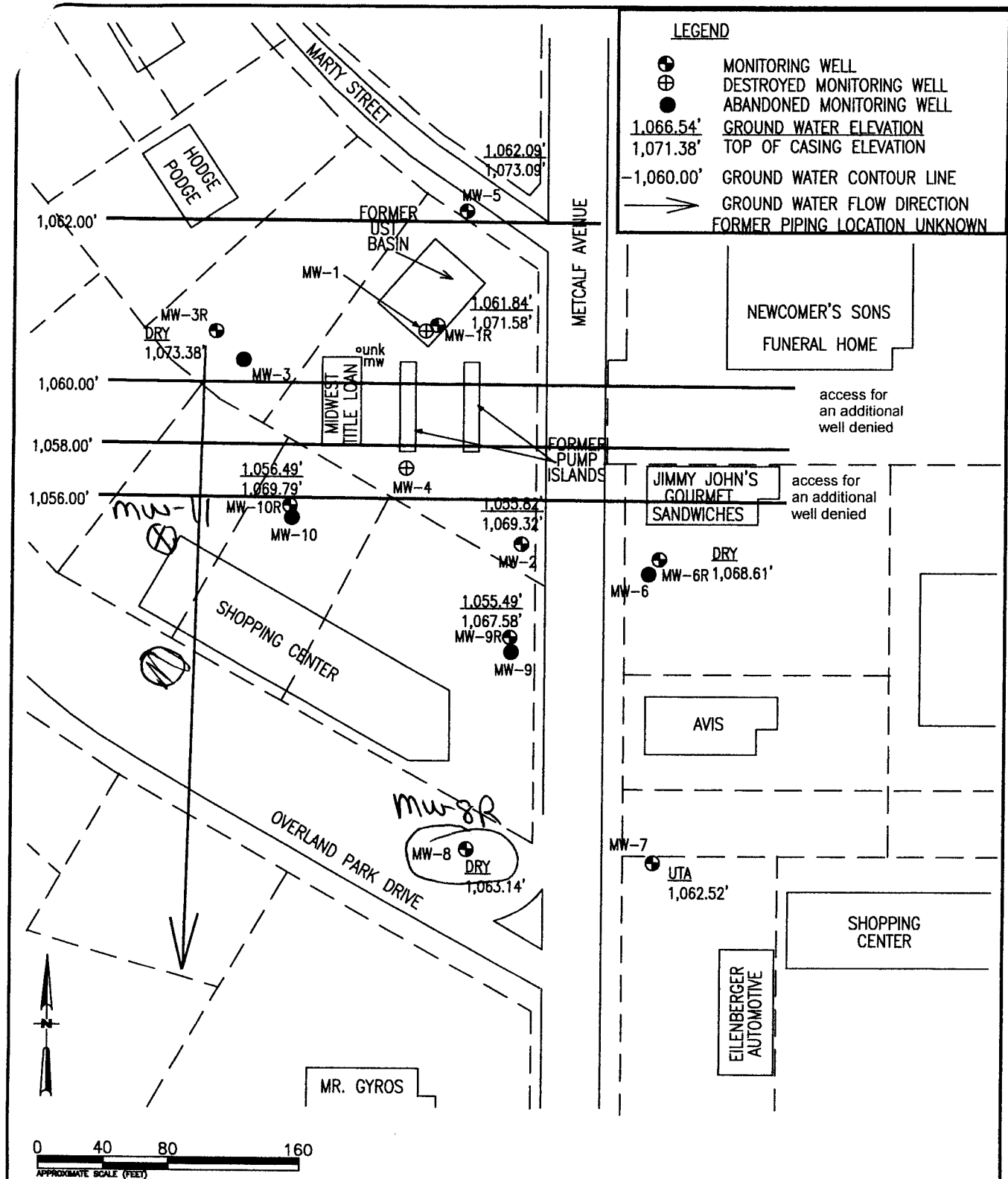

PROJ.# 17102398	PAGE#
SCALE: AS SHOWN	DRAWN BY:
FILE NO. 2398-F1	DESIGNED BY:
DATE:	APPROVED BY:

Terranext

FIGURE 1
GROUNDWATER FLOW MAP
SEPTEMBER 17, 2021
TOTAL #4166 (U4-046-13341)
8212 METCALF AVENUE
OVERLAND PARK, KANSAS