

☒ Original Record      ☐ Correction      ☐ Change in Well Ust

Division of Water  
Resources App. No.

Well ID

**MW15**[illegible]

# DENNIS L HANDKE

1820 NW 59th Terrace  
TOPEKA, KANSAS 66618  
785-286-4047 Home

Jess Chapman  
Larsen & Associates  
1311 E. 25<sup>th</sup> Street, Suite B  
Lawrence, Kansas, 66046

September 17, 2022

RE: Monitor Well Elevation Survey  
7414 W. 63<sup>rd</sup> St., Overland Park, Kansas

Proj. 22-00ZZ  
McCall Service Station #21  
KDHE ID U4-046-01596

Bench Mark: Chisled Sq. on NW corner of concrete storm inlet near SE corner of property.  
Elev: 1042.06      North 161      West 971      (from SE Cor. Sec.7-12-25E)

MW-14	rim	1034.82	North	458	NE1/4, SW1/4, SE1/4, SE1/4
	top pipe	1034.25	West	883	Lat= 39.01607   Long = 94.67089
MW-15	rim	1038.05	North	287	SE1/4, SW1/4, SE1/4, SE1/4
	top pipe	1037.72	West	916	Lat= 39.01560   Long = 94.67100

Elevation derived from existing project. NAVD 88

Lat & Long derived from Shawnee 7.5 Quad Map NAVD 29

If you have any questions, please feel free to call me. Thank you for the opportunity to be of service to you.

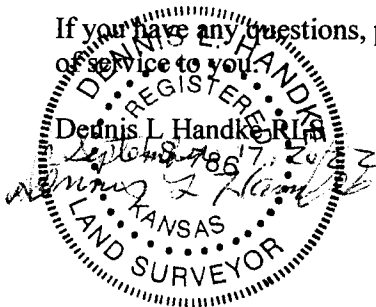

RECEIVED  
OCT 04 2022  
BUREAU OF WATER

NOTE: Figures exhibited within this report are only to be used within the context of this report. Placement of property lines, wells, structures, and roads is based on the available information from county appraiser maps, surveys, site visits, and/or previous vendor reports and should be considered approximate. Estimated concentration lines represent estimated contaminant concentrations based on data collected during the sampling event. Actual extent or concentration of contamination beyond the sample point is unknown.

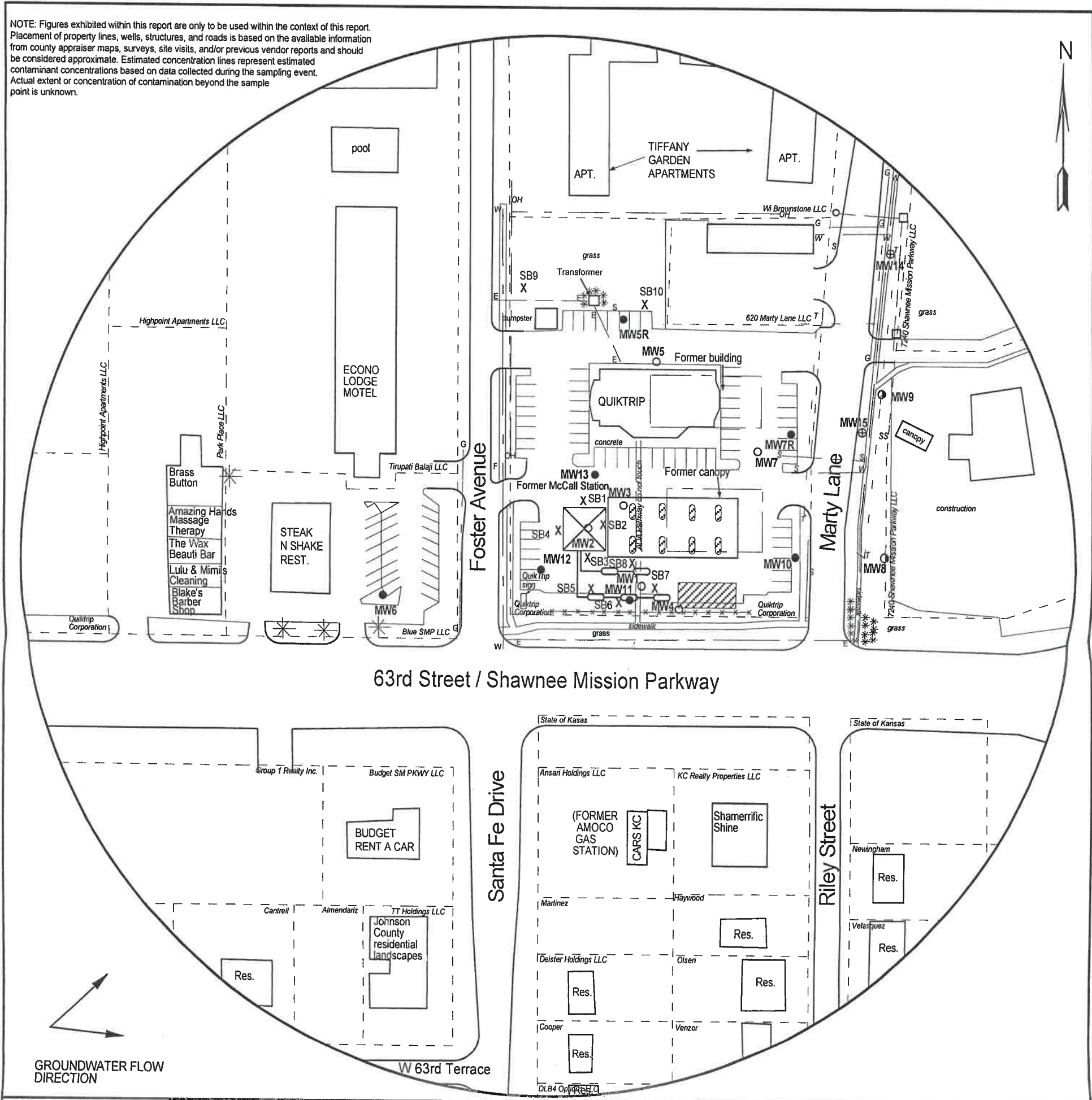

FIGURE 2.2 - 500 FT RADIUS AREA BASE MAP



1311 E. 25th St., Suite B (785) 841-8707  
Lawrence, KS 66046 (785) 865-4282

**PROJECT:**

McCall Service Station # 21  
7414 W. 63rd Street  
Overland Park, KS  
KDHE ID: U4-046-01596  
Date: 9/1/22

0 100 FT  
SCALE

**LEGEND:**

- Former Pump Island/Product Line
- Former UST
- Active UST Basin and Pump Islands
- Approximate Location of Property Line
- Existing Monitoring Well
- Plugged Monitoring Well
- Destroyed Monitoring Well
- New Monitoring Well (Installed 8/30/22)
- Soil Boring (Drilled 8/29-30/22)
- Gas Lines 1.5-3 ft bgs
- Water Lines (2-6 ft bgs)
- Overhead Lines (25-40 ft high)
- Electric Lines (2-6 ft bgs)
- Telephone Lines (2-6 ft bgs)
- Sewer Lines (2-6 ft bgs)

NOTE: SB9 & SB10 were drilled to collect hydrologic samples.

Shawnee

7-12-25E