

LOCATION OF WATER WELL: Fraction N¹/₂ W. 1/4 N.W. 1/4 Section Number Sec. 3 Township Number T 12 S S Range Number R 5 E. E/W
 County: Greay

Distance and direction from nearest town or city street address of well if located within city?
1 mile West from Junction City on highway 18 then 1 mile North on highway 77

WATER WELL OWNER: Mr. Curtis Johnson
 RR#, St. Address, Box #: 1408 Rucker Co. Board of Agriculture, Division of Water Resources
 City, State, ZIP Code: Junction City, Kansas 66441 Application Number:

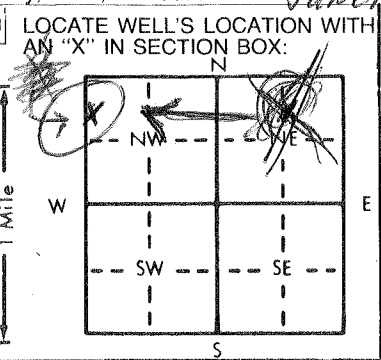

DEPTH OF COMPLETED WELL: 110' ft. ELEVATION: ft.
 Depth(s) Groundwater Encountered 1. 75'-80' ft. 2. ft. 3. ft.
 WELL'S STATIC WATER LEVEL: 70' ft. below land surface measured on mo/day/yr
 Pump test data: Well water was ft. after hours pumping gpm
 Est. Yield: 5-8 gpm: Well water was ft. after hours pumping gpm
 Bore Hole Diameter: 8" in. to 110' ft., and in. to ft.
 WELL WATER TO BE USED AS:
 1 Domestic 3 Feedlot 6 Oil field water supply 9 Dewatering 12 Other (Specify below)
 2 Irrigation 4 Industrial 7 Lawn and garden only 10 Observation well
 Was a chemical/bacteriological sample submitted to Department? Yes.....No If yes, mo/day/yr sample was submitted
 Water Well Disinfected? Yes No

TYPE OF BLANK CASING USED:
 1 Steel 3 RMP (SR) 5 Wrought iron 8 Concrete tile CASING JOINTS: Glued Clamped
 2 PVC Sc 40 4 ABS 6 Asbestos-Cement 9 Other (specify below) Welded Threaded
 7 Fiberglass
 Blank casing diameter: 5" in. to 110' 80' ft., Dia. 5 in. to 110 ft., Dia. in. to ft.
 Casing height above land surface: 16" in., weight Sc 40 lbs./ft. Wall thickness or gauge No.

TYPE OF SCREEN OR PERFORATION MATERIAL:
 1 Steel 3 Stainless steel 5 Fiberglass 8 RMP (SR) 10 Asbestos-cement
 2 Brass 4 Galvanized steel 6 Concrete tile 9 ABS 12 None used (open hole)
 7 Torch cut

SCREEN OR PERFORATION OPENINGS ARE:
 1 Continuous slot 3 Mill slot 3/1000 5 Gauzed wrapped 8 Saw cut 11 None (open hole)
 2 Louvered shutter 4 Key punched 6 Wire wrapped 9 Drilled holes
 7 Torch cut 10 Other (specify)
 SCREEN-PERFORATED INTERVALS: From 95' ft. to 80' ft., From ft. to ft.
 From ft. to ft., From ft. to ft.
 GRAVEL PACK INTERVALS: From 20' ft. to 110' ft., From ft. to ft.
 From ft. to ft., From ft. to ft.

GROUT MATERIAL: 1 Neat cement 2 Cement grout 3 Bentonite 4 Other
 Grout Intervals: From 20' ft. to 5' ft., From ft. to ft., From ft. to ft.
 What is the nearest source of possible contamination: None close
 1 Septic tank 4 Lateral lines 7 Pit privy 10 Livestock pens 14 Abandoned water well
 2 Sewer lines 5 Cess pool 8 Sewage lagoon 11 Fuel storage 15 Oil well/Gas well
 3 Watertight sewer lines 6 Seepage pit 9 Feedyard 12 Fertilizer storage 16 Other (specify below)
 13 Insecticide storage

Direction from well? How many feet?

FROM	TO	LITHOLOGIC LOG	FROM	TO	LITHOLOGIC LOG
0'	1'	Black Dirt or Top Soil			
1'	5'	Brown Clay			
5'	12'	28 SOFT Rock			
12'	24'	01 Brown Clay			
24'	27'	28 SOFT Rock			
27'	32'	Gray Clay			
32'	45'	01 Yellow Clay			
45'	68'	19 Blue Shale			
68'	101'	28 Hard Rock			
101'	110'	19 Hard Shale			

CONTRACTOR'S OR LANDOWNER'S CERTIFICATION: This water well was (1) constructed, (2) reconstructed, or (3) plugged under my jurisdiction and was completed on (mo/day/year) 4/20/84 and this record is true to the best of my knowledge and belief. Kansas Water Well Contractor's License No. 451 This Water Well Record was completed on (mo/day/year) 4/21/84 under the business name of Haldeman Well Drilling & Pump Service by (signature) Craig Haldeman
 INSTRUCTIONS: Use typewriter or ball point pen, PLEASE PRESS FIRMLY and PRINT clearly. Please fill in blanks, underline or circle the correct answers. Send top three copies to Kansas Department of Health and Environment, Division of Environment, Environmental Geology Section, Topeka, KS 66620. Send one to WATER WELL OWNER and retain one for your records.