

WATER WELL RECORD Form WWC-5

Division of Water Resources App. No.

MW11

Original Record Correction Change in Well Use

Well ID

1 LOCATION OF WATER WELL: County: GEARY Fraction NE 1/4 NW 1/4 SW 1/4 NW 1/4 Section Number 12 Township Number T 12 S Range Number R 5 E

2 WELL OWNER: Last Name: SANDERS First: MARK Street or Rural Address where well is located (if unknown, distance and direction from nearest town or intersection):

3 LOCATE WELL WITH 'X' IN SECTION BOX: 4 DEPTH OF COMPLETED WELL: 25 ft. 5 Latitude: 39.02567 Longitude: 96.82886

7 WELL WATER TO BE USED AS: 1. Domestic 2. Irrigation 3. Feedlot 4. Industrial 5. Public Water Supply 6. Dewatering 7. Aquifer Recharge 8. Monitoring 9. Environmental Remediation 10. Oil Field Water Supply 11. Test Hole 12. Geothermal 13. Other

Was a chemical/bacteriological sample submitted to KDHE? Water well disinfected?

8 TYPE OF CASING USED: Steel PVC Other CASING JOINTS: Glued Clamped Welded Threaded Casing diameter 2 in. to 25 ft. TYPE OF SCREEN OR PERFORATION MATERIAL: Steel Stainless Steel Fiberglass PVC Other

9 GROUT MATERIAL: Neat cement Cement grout Bentonite Other Concrete Surface Completion 0-1 Grout Intervals: From 0 ft. to 1 ft. Nearest source of possible contamination: Septic Tank Lateral Lines Pit Privy Livestock Pens Insecticide Storage

Table with 6 columns: 10 FROM, TO, LITHOLOGIC LOG, FROM, TO, LITHO. LOG (cont.) or PLUGGING INTERVALS. Rows include TOPSOIL, SILTY CLAY (CL), SAND(SW).

11 CONTRACTOR'S OR LANDOWNER'S CERTIFICATION: This water well was constructed, reconstructed, or plugged under my jurisdiction and was completed on (mo-day-year) 9/11/18 and this record is true to the best of my knowledge and belief.

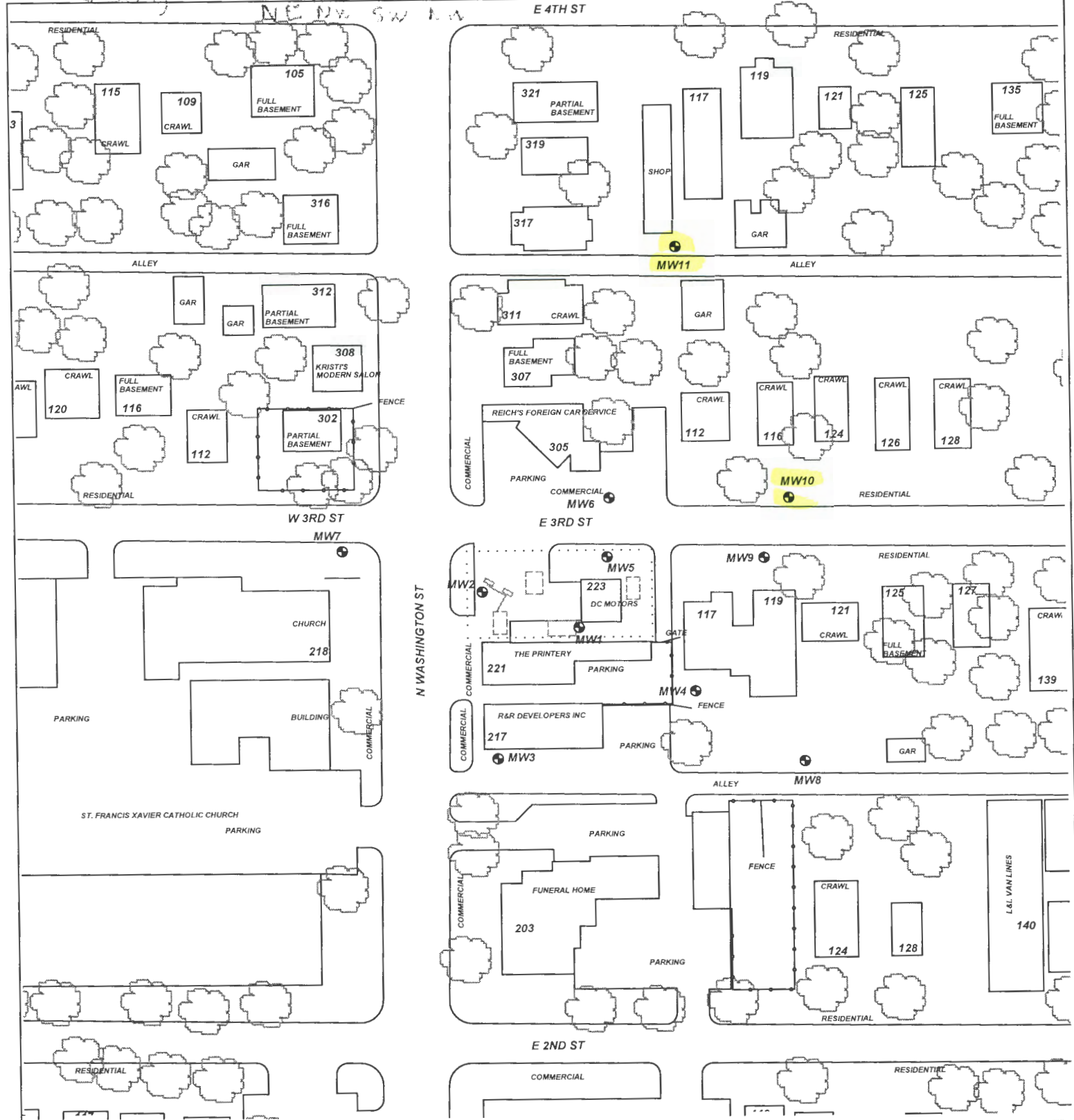

PROJECT: **CNC CONSTRUCTION**

ADDRESS: **223 N. WASHINGTON**

LOCATION: **JUNCTION CITY, KS**

DRAWN BY: **B. STALNAKER** DATE: **5/02/17**

REVISED BY: **B. STALNAKER** DATE: **10/2/18**

AEI JOB #: **TF502** KDHE JOB #: **U5-031-14778**

TITLE:

**ASSOCIATED ENVIRONMENTAL INC.**

- LEGEND:
- = FORMER UST BASIN/EXCAVATION
  - = FORMER PUMP ISLAND
  - = MONITOR WELL
  - = PROPOSED MONITOR WELL
  - = SUBJECT PROPERTY

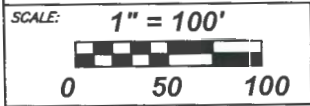

NOTES: