

WATER WELL RECORD

Form WWC-5

Division of Water Resources App. No.

1 LOCATION OF WATER WELL: Fraction SW 1/4 NW 1/4 NW 1/4 NW 1/4 Section Number 4 Township No. T 13 S Range Number R 14 E W
 County: Shawnee
 Street/Rural Address of Well Location; if unknown, distance & direction from nearest town or intersection: If at owner's address, check here
6230 SW Valencia Rd Topeka, KS
2 WATER WELL OWNER: RR#, Street Address, Box #: Jay BarreH
4613 NW County Park Dr
 City, State, ZIP Code: Topeka, KS 66618
Global Positioning System (GPS) information:
 Latitude: (in decimal degrees)
 Longitude: (in decimal degrees)
 Elevation:
 Datum: WGS 84, NAD 83, NAD 27
 Collection Method:
 GPS unit (Make/Model:)
 Digital Map/Photo, Topographic Map, Land Survey
 Est. Accuracy: <3 m, 3-5 m, 5-15 m, >15 m

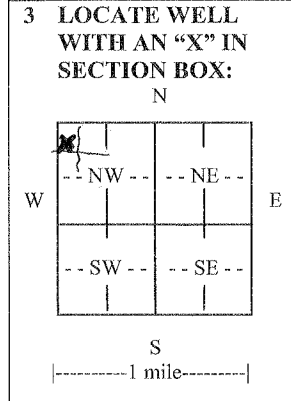

4 DEPTH OF COMPLETED WELL ft. 4-200' Bores
 Depth(s) Groundwater Encountered (1).....None.. ft. (2)..... ft. (3)..... ft.
 WELL'S STATIC WATER LEVEL None..... ft. below land surface measured on mo/day/yr.....
 Pump test data: Well water was.....ft. after..... hours pumping..... gpm
 EST. YIELD.....0.....gpm. Well water was.....ft. after..... hours pumping..... gpm
 Bore Hole Diameter6.....in. to200.....ft., andin. toft.
 WELL WATER TO BE USED AS: Public water supply Geothermal Injection well
 Domestic Feedlot Oil field water supply Dewatering Other (Specify below)
 Irrigation Industrial Domestic-lawn & garden Monitoring well Closed...100'p....
 Was a chemical/bacteriological sample submitted to Department? Yes No
 If yes, mo/day/yr sample was submitted.....
 Water well disinfected? Yes No

5 TYPE OF CASING USED: Steel PVC Other H.D. Polyethylene
 CASING JOINTS: Glued Clamped Welded Threaded Fusion
 Casing diameter 3/4..... in. to ft., Diameter in. to ft., Diameter in. to ft.
 Casing height above land surface.....36..... in., Weight SDR11.....lbs./ft., Wall thickness or gauge No. 160 PSI
 TYPE OF SCREEN OR PERFORATION MATERIAL: Steel Stainless Steel PVC Other (Specify)
 Brass Galvanized Steel None used (open hole)
 SCREEN OR PERFORATION OPENINGS ARE: None
 Continuous slot Mill slot Gauze wrapped Torch cut Drilled holes None (open hole)
 Louvered shutter Key punched Wire wrapped Saw cut Other (specify)
 SCREEN-PERFORATED INTERVALS: From..... ft. to ft., From..... ft. to ft.
 From..... ft. to ft., From..... ft. to ft.
 GRAVEL PACK INTERVALS: From..... ft. to ft., From..... ft. to ft.
 From..... ft. to ft., From..... ft. to ft.

6 GROUT MATERIAL: Neat cement Cement grout Bentonite Other
 Grout Intervals: From 200..... ft. to3..... ft., From..... ft. to ft., From..... ft. to ft.
 What is the nearest source of possible contamination:
 Septic tank Lateral lines Pit privy Livestock pens Insecticide storage Other (specify below)
 Sewer lines Cesspool Sewage lagoon Fuel storage Abandoned water well
 Watertight sewer lines Seepage pit Feedyard Fertilizer storage Oil well/gas well
 Direction from well East..... Distance from well 100.....

FROM	TO	LITHOLOGIC LOG	FROM	TO	LITHO. LOG (cont.) or PLUGGING INTERVALS
0	9	Soil + clay			
9	23	sand			
23	61	Sandy Shale			
61	65	lime			
65	79	Shale	200	3	4-200' Bores plugged with High Solid Bentonite
79	84	lime			
84	87	Shale			
87	93	lime			
93	106	Shale			
106	110	lime			

7 CONTRACTOR'S OR LANDOWNER'S CERTIFICATION: This water well was constructed, reconstructed, or plugged under my jurisdiction and was completed on (mo/day/year) 9-23-11 and this record is true to the best of my knowledge and belief.
 Kansas Water Well Contractor's License No. 561..... This Water Well Record was completed on (mo/day/year) 9-23-11 under the business name of Evans Energy Dev. Inc by (signature) [Signature]

INSTRUCTIONS: Use typewriter or ball point pen. PLEASE PRESS FIRMLY and PRINT clearly. Please fill in blanks and check the correct answers. Send three copies (white, blue, pink) to Kansas Department of Health and Environment, Bureau of Water, Geology Section, 1000 SW Jackson St., Suite 420, Topeka, Kansas 66612-1367. Telephone 785-296-5524. Send one copy to WATER WELL OWNER and retain one for your records. Include fee of \$5.00 for each constructed well. Visit us at <http://www.kdheks.gov/waterwell/index.html>.