

WATER WELL RECORD

Form WWC-5

Division of Water Resources App. No.

1 LOCATION OF WATER WELL: County: <u>Shawnee</u>	Fraction $\frac{1}{4}$ <u>NE</u> $\frac{1}{4}$ <u>SE</u> $\frac{1}{4}$ <u>SE</u> $\frac{1}{4}$	Section Number <u>34</u>	Township No. T <u>13</u> S	Range Number R <u>16</u> <input checked="" type="checkbox"/> E <input type="checkbox"/> W
--	---	-----------------------------	-------------------------------	--

Street/Rural Address of Well Location; if unknown, distance & direction from nearest town or intersection: If at owner's address, check here .

11301 S. Crow Rd Berryton, KS. 66409

Global Positioning System (GPS) information:

Latitude: (in decimal degrees)
 Longitude: (in decimal degrees)
 Elevation:
 Datum: WGS 84, NAD 83, NAD 27
 Collection Method:
 GPS unit (Make/Model:)
 Digital Map/Photo, Topographic Map, Land Survey
 Est. Accuracy: <3 m, 3-5 m, 5-15 m, >15 m

2 WATER WELL OWNER: Dan Warren
 RR#, Street Address, Box #: 520 SW Saline St.
 City, State, ZIP Code: Topeka, KS. 66606

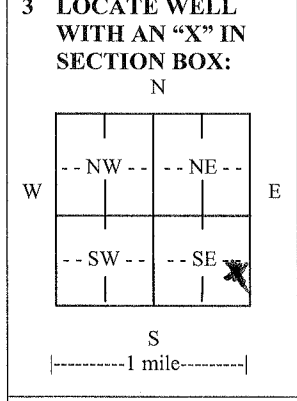

4 DEPTH OF COMPLETED WELL 200' ft. 5-200' Bores

Depth(s) Groundwater Encountered (1) None ft. (2) ft. (3) ft.
 WELL'S STATIC WATER LEVEL None ft. below land surface measured on mo/day/yr.....
 Pump test data: Well water was ft. after hours pumping gpm
 EST. YIELD 0 gpm. Well water was ft. after hours pumping gpm
 Bore Hole Diameter 6" in. to 200 ft., and in. to ft.
 WELL WATER TO BE USED AS: Public water supply Geothermal Injection well
 Domestic Feedlot Oil field water supply Dewatering Other (Specify below)
 Irrigation Industrial Domestic-lawn & garden Monitoring well Closed Loop
 Was a chemical/bacteriological sample submitted to Department? Yes No
 If yes, mo/day/yr sample was submitted.....
 Water well disinfected? Yes No

5 TYPE OF CASING USED: Steel PVC Other H.D. Polyethylene

CASING JOINTS: Glued Clamped Welded Threaded
 Casing diameter 3/4 in. to 200 ft., Diameter in. to ft., Diameter in. to ft.
 Casing height above land surface 36 in., Weight 502.4 lbs./ft., Wall thickness or gauge No. 160851

TYPE OF SCREEN OR PERFORATION MATERIAL: None
 Steel Stainless Steel PVC Other (Specify)
 Brass Galvanized Steel None used (open hole)

SCREEN OR PERFORATION OPENINGS ARE: None
 Continuous slot Mill slot Gauze wrapped Torch cut Drilled holes None (open hole)
 Louvered shutter Key punched Wire wrapped Saw cut Other (specify)

SCREEN-PERFORATED INTERVALS: From ft. to ft., From ft. to ft.
 From ft. to ft., From ft. to ft.
 GRAVEL PACK INTERVALS: From ft. to ft., From ft. to ft.
 From ft. to ft., From ft. to ft.

6 GROUT MATERIAL: Neat cement Cement grout Bentonite Other

Grout Intervals: From 200 ft. to 3 ft., From ft. to ft., From ft. to ft.

What is the nearest source of possible contamination:
 Septic tank Lateral lines Pit privy Livestock pens Insecticide storage Other (specify below)
 Sewer lines Cesspool Sewage lagoon Fuel storage Abandoned water well
 Watertight sewer lines Seepage pit Feedyard Fertilizer storage Oil well/gas well

Direction from well West Distance from well 100

FROM	TO	LITHOLOGIC LOG	FROM	TO	LITHO. LOG (cont.) or PLUGGING INTERVALS
0	4	Soil + clay			
4	10	Sandstone	200	3	
10	33	Shale			5-200' bores plugged with High Solids Bentonite
33	42	Sandstone			
42	45	lime			
45	51	Sandstone			
51	67	Shale			
67	75	lime			
75	80	Shale			
80	84	lime			

7 CONTRACTOR'S OR LANDOWNER'S CERTIFICATION: This water well was constructed, reconstructed, or plugged under my jurisdiction and was completed on (mo/day/year) 9-20-10 and this record is true to the best of my knowledge and belief. Kansas Water Well Contractor's License No. 561..... This Water Well Record was completed on (mo/day/year) 9-21-10 under the business name of Evans Energy Drilling by (signature) [Signature]

INSTRUCTIONS: Use typewriter or ball point pen. PLEASE PRESS FIRMLY and PRINT clearly. Please fill in blanks and check the correct answers. Send three copies (white, blue, pink) to Kansas Department of Health and Environment, Bureau of Water, Geology Section, 1000 SW Jackson St., Suite 420, Topeka, Kansas 66612-1367. Telephone 785-296-5522. Send one copy to WATER WELL OWNER and retain one for your records. Include fee of \$5.00 for each constructed well. Visit us at <http://www.kdheks.gov/waterwell/index.html>.