

1 LOCATION OF WATER WELL:	Fraction	Section Number	Township Number	Range Number
County: <u>Dickinson</u>	<u>NE SE SW</u>	<u>16</u>	<u>13</u>	<u>2</u> EW

Distance and direction from nearest town or city street address of well if located within city?
400 N. Buckeye, Abilene,

2 WATER WELL OWNER: <u>Buds Abilene (KDHE T+M) ZOOK</u>	Board of Agriculture, Division of Water Resources Application Number: <u>MW 1</u>
RR #, St. Address, Box #: <u>1000 SW Jackson</u>	City, State, ZIP Code: <u>Topeka, KS</u>

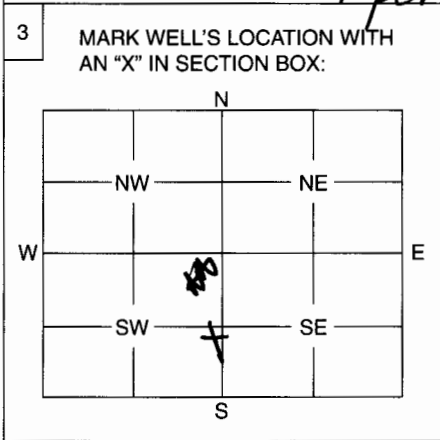

4 DEPTH OF WELL 19.11 ft.

WELL'S STATIC WATER LEVEL _____ ft.

WELL WAS USED AS:

1 Domestic	5 Public Water Supply	9 Dewatering
2 Irrigation	6 Oil Field Water Supply	10 Monitoring Well
3 Feedlot	7 Domestic (Lawn & Garden)	11 Injection Well
4 Industrial	8 Air Conditioning	12 Other _____

Was a chemical / bacteriological sample submitted to Department? Yes _____ No X

If yes, mo/day/yr sample was submitted _____

Water Well Disinfected: Yes _____ No X

5 TYPE OF BLANK CASING USED:

1 Steel	3 RMP (SR)	5 Wrought	7 Fiberglass	9 Other (Specify below)
2 PVC	4 ABS	6 Asbestos-Cement	8 Concrete Tile	

Blank casing diameter 2 in. Was casing pulled? Yes X No _____ If yes, how much 19.11

Casing height above or below land surface 0 in.

6 GROUT PLUG MATERIAL: 1 Neat cement 2 Cement grout 3 Bentonite 4 Other _____

Grout Plug Intervals: From 3 ft. to 20 ft., From _____ ft. to _____ ft., From _____ to _____ ft.

What is the nearest source of possible contamination:

1 Septic tank	6 Seepage pit	11 Fuel storage	16 Other (specify below)
2 Sewer lines	7 Pit privy	12 Fertilizer storage	
3 Watertight sewer lines	8 Sewage lagoon	13 Insecticide storage	
4 Lateral lines	9 Feedyard	14 Abandoned water well	
5 Cess pool	10 Livestock pens	15 Oil well/Gas well	

Direction from well? _____ How many feet? _____

FROM	TO	PLUGGING MATERIALS
<u>0</u>	<u>1</u>	<u>Concrete</u>
<u>1</u>	<u>3</u>	<u>Soil</u>
<u>3</u>	<u>20</u>	<u>Bentonite</u>

7 CONTRACTOR'S OR LANDOWNER'S CERTIFICATION: This water well was plugged under my jurisdiction and was completed on (mo/day/year) 1/27/06 and this record is true to the best of my knowledge and belief. Kansas Water Well Contractor's License No. 757 This Water Well Record was completed on (mo/day/year) 2/13/06 under the business name of Larsen + Associates by (signature) [Signature]

INSTRUCTIONS: Use typewriter or ballpoint pen. Please press firmly and print clearly. Please fill in blanks, underline or circle the correct answers. Send top three copies to Kansas Department of Health and Environment, Bureau of Water, Geology Section, 1000 SW Jackson St., Ste. 420, Topeka, Kansas 66612-1367. Telephone: 785/296-5522. Send one to Water Well Owner and retain one for your records.