

1 LOCATION OF WATER WELL: Fraction SW ¼ SW¼ SW ¼ SE ¼ Section Number 09 Township Number T 13 S Range Number 02 E W
 County: Dickinson

Street/Rural Address of Well Location; if unknown, distance & direction from nearest town or intersection: If at owner's address, check here 1401 N. Buckeye, Abilene, Kansas

Global Positioning Systems (GPS) information:
 Latitude: 38.92998 (in decimal degrees)
 Longitude: 97.21375 (in decimal degrees)
 Elevation: 1195.85 TOC
 Horizontal Datum: WGS84, NAD83, NAD27
 Collection Method:

2 WATER WELL OWNER: Tim Roark
 RR#, St. Address, Box #: 734 E. 4th
 City, State ZIP Code: Hutchinson, KS 67501

GPS unit (Make/Model: _____)
 Digital Map/Photo, Topographic Map, Land Survey
 Est. Accuracy: < 3 m, 3-5 m, 5-15 m, > 15 m

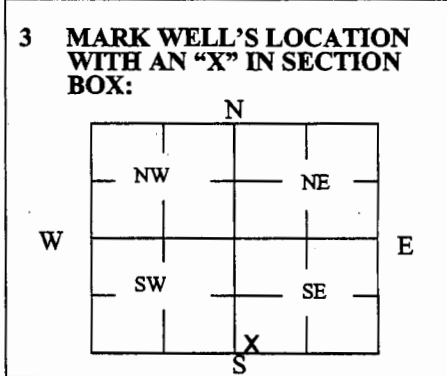

4 DEPTH OF WELL 19.99 ft.
 WELL'S STATIC WATER LEVEL 9.43 ft.
 WELL WAS USED AS:

Domestic Public Water Supply Dewatering
 Irrigation Oil Field Water Supply Monitoring
 Feedlot Domestic (Lawn & Garden) Injection Well
 Industrial Air Conditioning Other _____

Was a chemical/bacteriological sample submitted to Department? Yes No

5 TYPE OF BLANK CASING USED:

Steel RMP (SR) Wrought Fiberglass Other (Specify below) _____
 PVC ABS Asbestos-Cement Concrete Tile

Blank casing diameter 2 in. Was casing pulled? Yes No If yes, how much 3 ft
 Casing height above or below land surface 36 in.

6 GROUT PLUG MATERIAL: Neat cement Cement grout Bentonite Other _____

Grout Plug Intervals: From 3 ft. to 19.99 ft., From _____ ft. to _____ ft., From _____ ft. to _____ ft.

What is the nearest source of possible contamination:

Septic tank Seepage pit Fuel storage Other (specify below) U5-021-14670
 Sewer lines Pit privy Fertilizer storage
 Watertight sewer lines Sewage lagoon Insecticide storage
 Lateral lines Feedyard Abandoned water well Direction from well? On-site
 Cess pool Livestock pens Oil well/Gas well How many feet? _____

FROM	TO	PLUGGING MATERIALS	FROM	TO	PLUGGING MATERIALS
0	0.5	Concrete			
0.5	3	Compacted silt/clay			
3	19.99	Hydrated Bentonite chips			
					Kwik Shop #745, U5-021-14670

7 CONTRACTOR'S OR LANDOWNER'S CERTIFICATION: This water well was plugged under my jurisdiction and was completed on (mo/day/year) 4/1/19 and this record is true to the best of my knowledge and belief. Kansas Water Well Contractor's License No. 585. This Water Well Record was completed on (mo/day/year) 4/25/19 under the business name of Associated Environmental, Inc. by (signature) *[Signature]*

Send one white copy to Kansas Department of Health & Environment, Geology Section, 1000 SW Jackson Street, Ste. 420, Topeka, KS 66612-1367. Send one copy to WATER WELL OWNER and retain one for your records.
 Visit us at <http://www.kdheks.gov/waterwell/index.html> Telephone 785-296-5524.

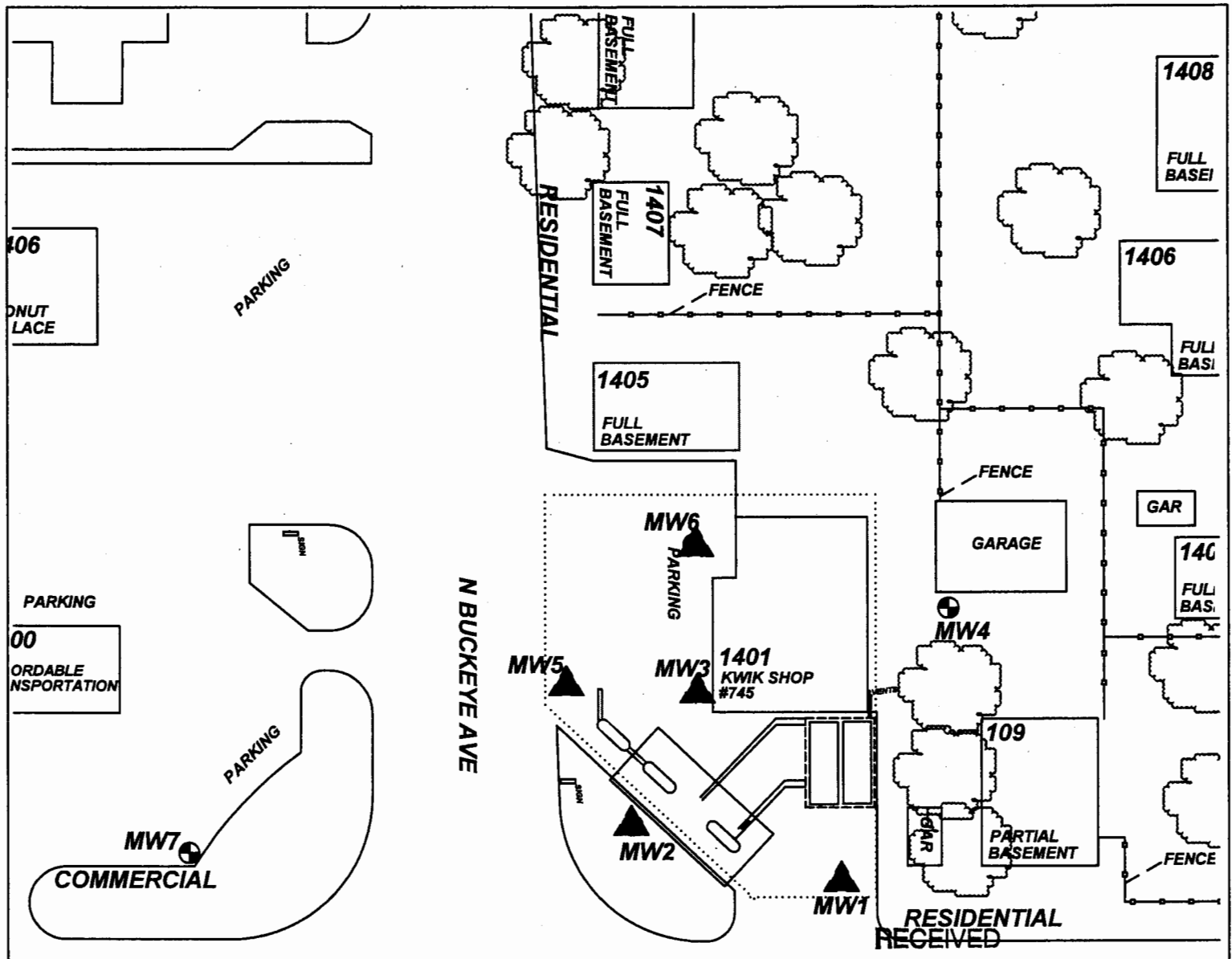

MAY 08 2019

BUREAU OF WATER

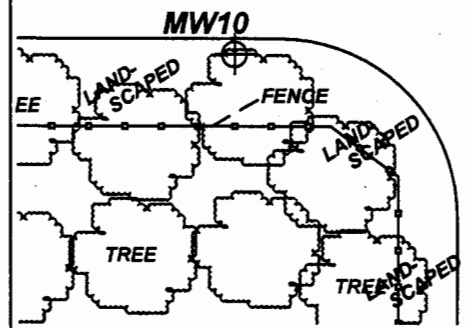

PROJECT:		KWIK SHOP #745	
ADDRESS:		1401 N. BUCKEYE	
LOCATION:		ABILENE, KS	
DRAWN BY:	DATE:	B. SCOTT	11/05/14
REVISED BY:	DATE:	B. STALNAKER	8/3/17
AEI JOB #:	KDHE JOB #:	TF475	U5-021-14670

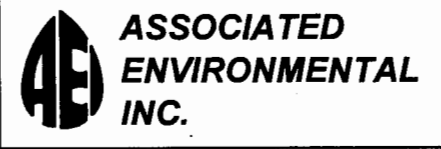

LEGEND:

- = (2) 10,000 G. GASOLINE USTS
- = PUMP ISLAND & CANOPY
- = MONITOR WELL
- = PRIVATE WELL
- = MONITOR WELL
- = SITE BOUNDARY
- = PLUGGED MONITOR WELL

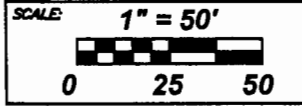

NOTES: