

<b>1 LOCATION OF WATER WELL:</b> County: Dickinson	Fraction SW ¼ SW¼ SW ¼ SE ¼	Section Number 09	Township Number T 13 S	Range Number 02 <input checked="" type="checkbox"/> E <input type="checkbox"/> W
---	--------------------------------	----------------------	---------------------------	---

Street/Rural Address of Well Location; if unknown, distance & direction from nearest town or intersection: If at owner's address, check here  1401 N. Buckeye, Abilene, Kansas

**Global Positioning Systems (GPS) information:**  
 Latitude: 38.93012 (in decimal degrees)  
 Longitude: 97.21367 (in decimal degrees)  
 Elevation: 1196.29 TOC  
 Horizontal Datum:  WGS84,  NAD83,  NAD27  
 Collection Method:

**2 WATER WELL OWNER:** Tim Roark  
 RR#, St. Address, Box #: 734 E. 4th  
 City, State ZIP Code: Hutchinson, KS 67501

GPS unit (Make/Model: \_\_\_\_\_)  
 Digital Map/Photo,  Topographic Map,  Land Survey  
 Est. Accuracy:  < 3 m,  3-5 m,  5-15 m,  > 15 m

<p><b>3 MARK WELL'S LOCATION WITH AN "X" IN SECTION BOX:</b></p> <div style="text-align: center;"> <p>N</p> <table border="1" style="margin: auto; border-collapse: collapse;"> <tr> <td style="width: 20px;">NW</td> <td style="width: 20px;"></td> <td style="width: 20px;">NE</td> </tr> <tr> <td style="width: 20px;">SW</td> <td style="width: 20px; text-align: center;">X</td> <td style="width: 20px;">SE</td> </tr> </table> <p>W <span style="margin-left: 100px;">E</span></p> <p style="text-align: center;">S</p> </div>	NW		NE	SW	X	SE	<p><b>4 DEPTH OF WELL</b> <u>13.98</u> ft.                  WELL'S STATIC WATER LEVEL <u>9.53</u> ft.                  WELL WAS USED AS:</p> <table style="width: 100%;"> <tr> <td><input type="checkbox"/> Domestic</td> <td><input type="checkbox"/> Public Water Supply</td> <td><input type="checkbox"/> Dewatering</td> </tr> <tr> <td><input type="checkbox"/> Irrigation</td> <td><input type="checkbox"/> Oil Field Water Supply</td> <td><input checked="" type="checkbox"/> Monitoring</td> </tr> <tr> <td><input type="checkbox"/> Feedlot</td> <td><input type="checkbox"/> Domestic (Lawn &amp; Garden)</td> <td><input type="checkbox"/> Injection Well</td> </tr> <tr> <td><input type="checkbox"/> Industrial</td> <td><input type="checkbox"/> Air Conditioning</td> <td><input type="checkbox"/> Other _____</td> </tr> </table> <p>Was a chemical/bacteriological sample submitted to Department? Yes <input type="checkbox"/> No <input checked="" type="checkbox"/></p>	<input type="checkbox"/> Domestic	<input type="checkbox"/> Public Water Supply	<input type="checkbox"/> Dewatering	<input type="checkbox"/> Irrigation	<input type="checkbox"/> Oil Field Water Supply	<input checked="" type="checkbox"/> Monitoring	<input type="checkbox"/> Feedlot	<input type="checkbox"/> Domestic (Lawn & Garden)	<input type="checkbox"/> Injection Well	<input type="checkbox"/> Industrial	<input type="checkbox"/> Air Conditioning	<input type="checkbox"/> Other _____
NW		NE																	
SW	X	SE																	
<input type="checkbox"/> Domestic	<input type="checkbox"/> Public Water Supply	<input type="checkbox"/> Dewatering																	
<input type="checkbox"/> Irrigation	<input type="checkbox"/> Oil Field Water Supply	<input checked="" type="checkbox"/> Monitoring																	
<input type="checkbox"/> Feedlot	<input type="checkbox"/> Domestic (Lawn & Garden)	<input type="checkbox"/> Injection Well																	
<input type="checkbox"/> Industrial	<input type="checkbox"/> Air Conditioning	<input type="checkbox"/> Other _____																	

**5 TYPE OF BLANK CASING USED:**

Steel  RMP (SR)  Wrought  Fiberglass  Other (Specify below) \_\_\_\_\_  
 PVC  ABS  Asbestos-Cement  Concrete Tile

Blank casing diameter 2 in. Was casing pulled? Yes  No  If yes, how much 3 ft  
 Casing height above or below land surface 36 in.

**6 GROUT PLUG MATERIAL:**  Neat cement  Cement grout  Bentonite  Other \_\_\_\_\_

Grout Plug Intervals: From 3 ft. to 13.98 ft., From \_\_\_\_\_ ft. to \_\_\_\_\_ ft., From \_\_\_\_\_ ft. to \_\_\_\_\_ ft.

What is the nearest source of possible contamination:

<input type="checkbox"/> Septic tank	<input type="checkbox"/> Seepage pit	<input checked="" type="checkbox"/> Fuel storage	<input checked="" type="checkbox"/> Other (specify below)
<input type="checkbox"/> Sewer lines	<input type="checkbox"/> Pit privy	<input type="checkbox"/> Fertilizer storage	<u>U5-021-14670</u>
<input type="checkbox"/> Watertight sewer lines	<input type="checkbox"/> Sewage lagoon	<input type="checkbox"/> Insecticide storage	
<input type="checkbox"/> Lateral lines	<input type="checkbox"/> Feedyard	<input type="checkbox"/> Abandoned water well	Direction from well? <u>On-site</u>
<input type="checkbox"/> Cess pool	<input type="checkbox"/> Livestock pens	<input type="checkbox"/> Oil well/Gas well	How many feet? _____

FROM	TO	PLUGGING MATERIALS	FROM	TO	PLUGGING MATERIALS
0	0.5	Concrete			
0.5	3	Compacted silt/clay			
3	13.98	Hydrated Bentonite chips			
					Kwik Shop #745, U5-021-14670

**7 CONTRACTOR'S OR LANDOWNER'S CERTIFICATION:** This water well was plugged under my jurisdiction and was completed on (mo/day/year) 4/1/19 and this record is true to the best of my knowledge and belief. Kansas Water Well Contractor's License No. 585. This Water Well Record was completed on (mo/day/year) 4/25/19 under the business name of Associated Environmental, Inc. by (signature) [Signature]

Send one white copy to Kansas Department of Health & Environment, Geology Section, 1000 SW Jackson Street, Ste. 420, Topeka, KS 66612-1367. Send one copy to WATER WELL OWNER and retain one for your records.  
 Visit us at <http://www.kdheks.gov/waterwell/index.html> Telephone 785-296-5524.

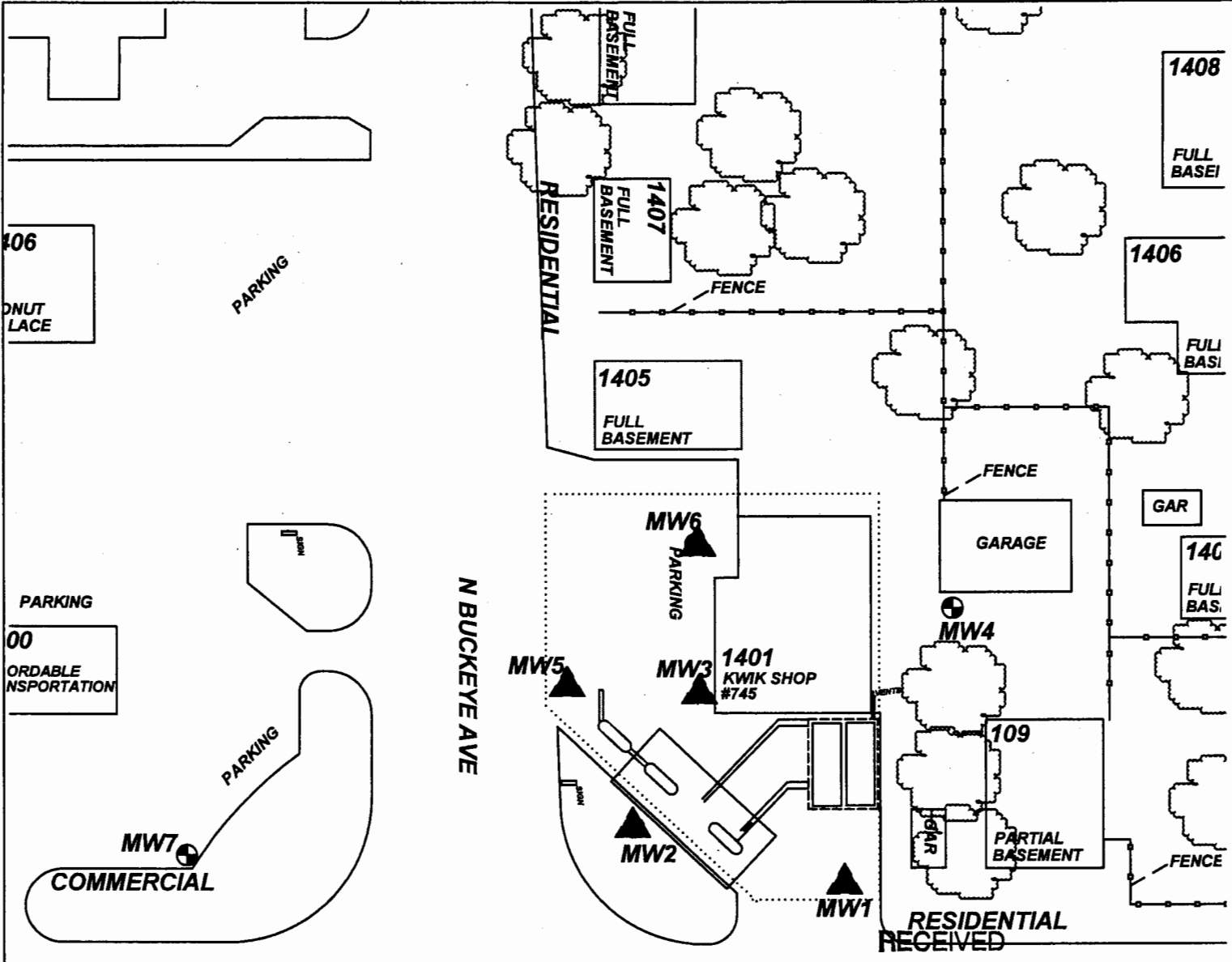

MAY 08 2019

BUREAU OF WATER

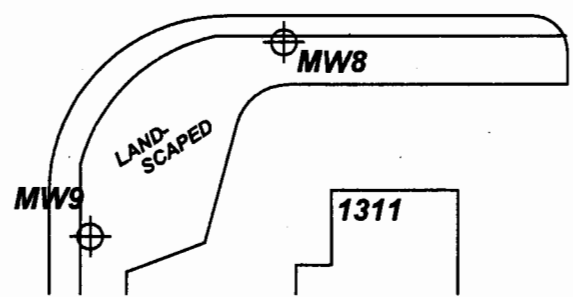
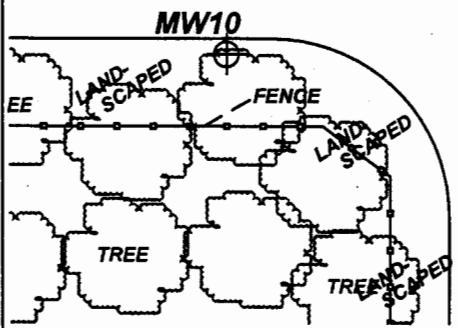

PROJECT: KWIK SHOP #745

ADDRESS: 1401 N. BUCKEYE

LOCATION: ABILENE, KS

DRAWN BY: B. SCOTT DATE: 11/05/14

REVISED BY: B. STALNAKER DATE: 8/3/17

AEI JOB #: TF475 KDH E JOB #: U5-021-14670

**ASSOCIATED ENVIRONMENTAL INC.**

LEGEND:

- = (2) 10,000 G. GASOLINE USTS
- = PUMP ISLAND & CANOPY
- = MONITOR WELL
- = PRIVATE WELL
- = MONITOR WELL
- = SITE BOUNDARY
- = PLUGGED MONITOR WELL

SCALE: 1" = 50'

0 25 50

NOTES: