

WATER WELL RECORD

Form WWC-5

Division of Water Resources App. No.

1 LOCATION OF WATER WELL: County: Douglas	Fraction SW 1/4 SW 1/4 NE 1/4	Section Number 31	Township No. T 13 S	Range Number R 22 E
Street/Rural Address of Well Location; if unknown, distance & direction from nearest town or intersection: If at owner's address, check here <input type="checkbox"/> . 1456 N. 956 Road Lawrence, KS		Global Positioning System (GPS) information: Latitude: (in decimal degrees) Longitude: (in decimal degrees) Elevation: Datum: <input type="checkbox"/> WGS 84, <input type="checkbox"/> NAD 83, <input type="checkbox"/> NAD 27 Collection Method: <input type="checkbox"/> GPS unit (Make/Model:) <input type="checkbox"/> Digital Map/Photo, <input type="checkbox"/> Topographic Map, <input type="checkbox"/> Land Survey Est. Accuracy: <input type="checkbox"/> <3 m, <input type="checkbox"/> 3-5 m, <input type="checkbox"/> 5-15 m, <input type="checkbox"/> >15 m		
2 WATER WELL OWNER: Ben Dennis RR#, Street Address, Box #: 1423 Montrev Hill Drive City, State, ZIP Code : Lawrence, KS 66049				

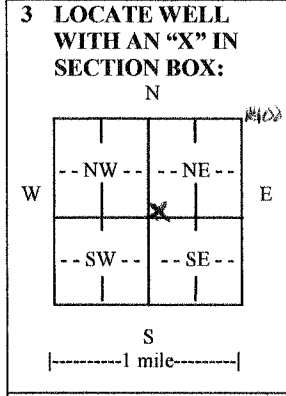

4 DEPTH OF COMPLETED WELL 200 ft. *4-200' Bores*

Depth(s) Groundwater Encountered (1) *91-166* ft. (2)..... ft. (3)..... ft.
 WELL'S STATIC WATER LEVEL..... *80* ft. below land surface measured on mo/day/yr. *7-27-13*
 Pump test data: Well water was ft. after hours pumping gpm
 EST. YIELD. *15* gpm. Well water was ft. after hours pumping gpm
 Bore Hole Diameter *6* in. to *200* ft., and in. to ft.
 WELL WATER TO BE USED AS: Public water supply Geothermal Injection well
 Domestic Feedlot Oil field water supply Dewatering Other (Specify below)
 Irrigation Industrial Domestic-lawn & garden Monitoring well closed loop
 Was a chemical/bacteriological sample submitted to Department? Yes No
 If yes, mo/day/yr sample was submitted.....
 Water well disinfected? Yes No

5 TYPE OF CASING USED: Steel PVC Other *HD Polyethylene*

CASING JOINTS: Glued Clamped Welded Threaded *Fusion*
 Casing diameter *3/4* in. to *200* ft., Diameter in. to ft., Diameter in. to ft.
 Casing height above land surface..... *36* in., Weight *SDR11* lbs./ft., Wall thickness or gauge No. *160 PSI*

TYPE OF SCREEN OR PERFORATION MATERIAL: *None*
 Steel Stainless Steel PVC Other (Specify)
 Brass Galvanized Steel None used (open hole)

SCREEN OR PERFORATION OPENINGS ARE: *None*
 Continuous slot Mill slot Gauze wrapped Torch cut Drilled holes None (open hole)
 Louvered shutter Key punched Wire wrapped Saw cut Other (specify)

SCREEN-PERFORATED INTERVALS: From..... ft. to ft., From ft. to ft.
 From..... ft. to ft., From ft. to ft.
 GRAVEL PACK INTERVALS: From..... ft. to ft., From ft. to ft.
 From..... ft. to ft., From ft. to ft.

6 GROUT MATERIAL: Neat cement Cement grout Bentonite Other

Grout Intervals: From *200* ft. to *3* ft., From ft. to ft., From ft. to ft.

What is the nearest source of possible contamination:
 Septic tank Lateral lines Pit privy Livestock pens Insecticide storage Other (specify below)
 Sewer lines Cesspool Sewage lagoon Fuel storage Abandoned water well
 Watertight sewer lines Seepage pit Feedyard Fertilizer storage Oil well/gas well

Direction from well *S* Distance from well *20*

FROM	TO	LITHOLOGIC LOG	FROM	TO	LITHO. LOG (cont.) or PLUGGING INTERVALS
0	18	soil/clay 183-192 lime			
18	20	sandstone 192-200 shale			
20	24	lime			
24	82	sandstone	200	3	4-200' Bores plugged with High Solid Bentonite
82	91	shale			
91	119	sandstone			
119	126	shale			
126	166	sandstone			
166	170	lime			
170	183	shale			

7 CONTRACTOR'S OR LANDOWNER'S CERTIFICATION: This water well was constructed, reconstructed, or plugged under my jurisdiction and was completed on (mo/day/year) *9/26/2013*..... and this record is true to the best of my knowledge and belief. Kansas Water Well Contractor's License No. *561*..... This Water Well Record was completed on (mo/day/year) *9/26/2013*..... under the business name of *Evans Energy Development, Inc.*..... by (signature) *[Signature]*

INSTRUCTIONS: Use typewriter or ball point pen. *PLEASE PRESS FIRMLY* and *PRINT* clearly. Please fill in blanks and check the correct answers. Send one copy to Kansas Department of Health and Environment, Bureau of Water, Geology Section, 1000 SW Jackson St., Suite 420, Topeka, Kansas 66612-1367. Telephone 785-296-5524. Send one copy to WATER WELL OWNER and retain one for your records. Include fee of \$5.00 for each constructed well. Visit us at <http://www.kdheks.gov/waterwell/index.html>