

MW-8

WATER WELL PLUGGING RECORD Form WWC-5P KSA 82a-1212 ID NO.

1 LOCATION OF WATER WELL: County: Douglas Fraction NW 1/4 SE 1/4 SW 1/4 Section Number 4 Township Number T 13 S Range Number 20 E W

Street/Rural Address of Well Location; if unknown, distance & direction from nearest town or intersection: Intersection at 2200 Blk of O'Connell & Venture Park Drive

Global Positioning Systems (GPS) information: Latitude: 38.947367 Longitude: 95.201556 Elevation: 860.33 Horizontal Datum: WGS84 Collection Method: Cell phone

2 WATER WELL OWNER: City of Lawrence RR#, St. Address, Box #: PO Box 708 City, State ZIP Code: Lawrence, KS 66044

GPS unit (Make/Model): Cell phone Digital Map/Photo, Topographic Map, Land Survey Est. Accuracy: < 3 m, 3-5 m, 5-15 m, > 15 m

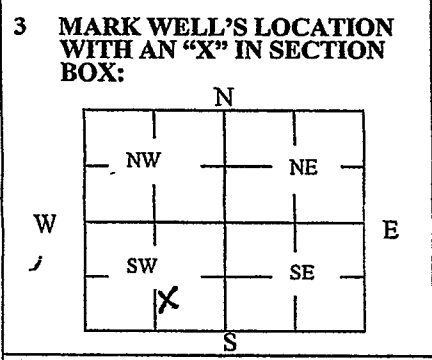

4 DEPTH OF WELL 44.9 ft. WELL'S STATIC WATER LEVEL 13 ft. WELL WAS USED AS: Domestic, Irrigation, Feedlot, Industrial, Public Water Supply, Oil Field Water Supply, Domestic (Lawn & Garden), Air Conditioning, Dewatering, Monitoring, Injection Well, Other. Was a chemical/bacteriological sample submitted to Department? Yes No X

5 TYPE OF BLANK CASING USED: Steel, RMP (SR), Wrought, Fiberglass, Other (Specify below), PVC, ABS, Asbestos-Cement, Concrete Tile. Blank casing diameter 2 in. Was casing pulled? Yes No X If yes, how much Casing height above or below land surface 3 FT in.

6 GROUT PLUG MATERIAL: Neat cement, Cement grout, Bentonite, Other. Grout Plug Intervals: From 44.9 ft. to 3 ft., From ft. to ft., From ft. to ft.

What is the nearest source of possible contamination: Septic tank, Sewer lines, Watertight sewer lines, Lateral lines, Cess pool, Seepage pit, Pit privy, Sewage lagoon, Feedyard, Livestock pens, Fuel storage, Fertilizer storage, Insecticide storage, Abandoned water well, Oil well/Gas well, Other (specify below) ROADS. Direction from well? EAST - North How many feet? 752 - 659

Table with columns: FROM, TO, PLUGGING MATERIALS. Row 1: 44.9 - 3, Bentonite Hole plug. Row 2: 3 - 0, Top Soil.

7 CONTRACTOR'S OR LANDOWNER'S CERTIFICATION: This water well was plugged under my jurisdiction and was completed on (mo/day/year) 11-12-2021 and this record is true to the best of my knowledge and belief. Kansas Water Well Contractor's License No. 536 This Water Well Record was completed on (mo/day/year) 12-1-2021 under the business name of Patcher Pump & Well Drilling, Inc. by (signature) Jay E. Patcher

Send one white copy to Kansas Department of Health & Environment, Geology Section, 1000 SW Jackson Street, Ste. 420, Topeka, KS 66612-1367. Send one copy to WATER WELL OWNER and retain one for your records. Visit us at http://www.kdheks.gov/waterwell/index.html Telephone 785-296-5524.