

MW-1

WATER WELL PLUGGING RECORD Form WWC-5P KSA 82a-1212 ID NO. []

1 LOCATION OF WATER WELL: County: Douglas Fraction SE 1/4 SW 1/4 SW 1/4 1/4 Section Number 4 Township Number T 13 S Range Number 20 [X] E [] W

Street/Rural Address of Well Location; if unknown, distance & direction from nearest town or intersection: Intersection at 2200 Blk of OConnell & Venture Park Drive Global Positioning Systems (GPS) information: Latitude: 38.94787 Longitude: 95.202483 Elevation: 867.84 Horizontal Datum: [X] WGS84, [] NAD83, [] NAD27 Collection Method: [] GPS unit (Make/Model: Cell phone [] Digital Map/Photo, [] Topographic Map, [] Land Survey Est. Accuracy: [] < 3 m, [] 3-5 m, [] 5-15 m, [] > 15 m

2 WATER WELL OWNER: City of Lawrence RR#, St. Address, Box #: PO Box 708 City, State ZIP Code: Lawrence, KS 66044

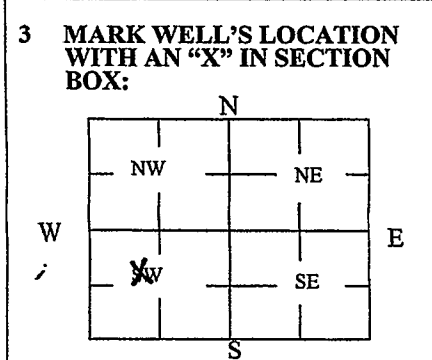

4 DEPTH OF WELL 26.8 ft. WELL'S STATIC WATER LEVEL 12' ft. WELL WAS USED AS: [] Domestic [] Irrigation [] Feedlot [] Industrial [] Public Water Supply [] Oil Field Water Supply [] Domestic (Lawn & Garden) [] Air Conditioning [] Dewatering [X] Monitoring [] Injection Well [] Other Was a chemical/bacteriological sample submitted to Department? Yes [] No [X]

5 TYPE OF BLANK CASING USED: [X] Steel [] RMP (SR) [] Wrought [] Fiberglass [] Other (Specify below) [] PVC [] ABS [] Asbestos-Cement [] Concrete Tile Blank casing diameter 5 in. Was casing pulled? Yes [] No [X] If yes, how much Casing height above or below land surface 3 FT in.

6 GROUT PLUG MATERIAL: [] Neat cement [] Cement grout [X] Bentonite [] Other Grout Plug Intervals: From 26.8 ft. to 3 ft., From ft. to ft., From ft. to ft. What is the nearest source of possible contamination: [] Septic tank [] Sewer lines [] Watertight sewer lines [] Lateral lines [] Cess pool [] Seepage pit [] Pit privy [] Sewage lagoon [] Feedyard [] Livestock pens [] Fuel storage [] Fertilizer storage [] Insecticide storage [] Abandoned water well [] Oil well/Gas well [] Other (specify below) Roads Direction from well? East & North How many feet? 495 - 693

Table with columns: FROM, TO, PLUGGING MATERIALS. Row 1: 26.8 - 3, Bentonite half plug. Row 2: 3 - 0, Top Soil.

7 CONTRACTOR'S OR LANDOWNER'S CERTIFICATION: This water well was plugged under my jurisdiction and was completed on (mo/day/year) 11-12-2021 and this record is true to the best of my knowledge and belief. Kansas Water Well Contractor's License No. 536. This Water Well Record was completed on (mo/day/year) 12-1-2021 under the business name of Patcher Pump & Well Drilling, Inc by (signature) Tom E. Patcher

Send one white copy to Kansas Department of Health & Environment, Geology Section, 1000 SW Jackson Street, Ste. 420, Topeka, KS 66612-1367. Send one copy to WATER WELL OWNER and retain one for your records. Visit us at http://www.kdheks.gov/waterwell/index.html Telephone 785-296-5524.