

MW-11R

WATER WELL PLUGGING RECORD Form WWC-5P KSA 82a-1212 ID NO.

1 LOCATION OF WATER WELL: County: Douglas Fraction NE 1/4 SW 1/4 SW 1/4 1/4 Section Number 4 Township Number T 13 S Range Number 20 [X] E [] W

Street/Rural Address of Well Location; if unknown, distance & direction from nearest town or intersection: Intersection at 2200 Blk of OConnell & Venture Park Drive Global Positioning Systems (GPS) information: Latitude: 38.947012 Longitude: 95.201887 Elevation: 864.29

2 WATER WELL OWNER: City of Lawrence RR#, St. Address, Box #: 101 Blk 708 City, State ZIP Code: Lawrence, KS 66084

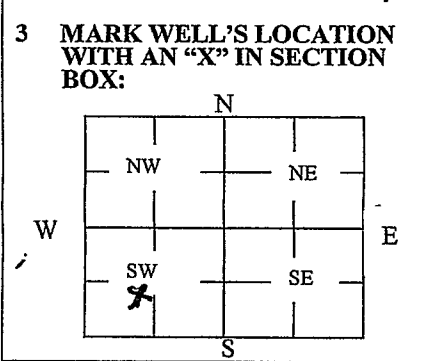

3 MARK WELL'S LOCATION WITH AN "X" IN SECTION BOX: 4 DEPTH OF WELL 27.49 ft. WELL'S STATIC WATER LEVEL 13.9 ft. WELL WAS USED AS: [] Domestic [] Irrigation [] Feedlot [] Industrial [] Public Water Supply [] Oil Field Water Supply [] Domestic (Lawn & Garden) [] Air Conditioning [] Dewatering [X] Monitoring [] Injection Well [] Other

5 TYPE OF BLANK CASING USED: [X] Steel PVC [] RMP (SR) ABS [] Wrought Asbestos-Cement [] Fiberglass Concrete Tile [] Other (Specify below) Blank casing diameter 2" in. Was casing pulled? Yes [] No [X] If yes, how much Casing height above or below land surface 3 FT in.

6 GROUT PLUG MATERIAL: [] Neat cement [] Cement grout [X] Bentonite [] Other Grout Plug Intervals: From 27.49 ft. to 3 ft., From ft. to ft., From ft. to ft. What is the nearest source of possible contamination: [] Septic tank [] Sewer lines [] Watertight sewer lines [] Lateral lines [] Cess pool [] Seepage pit [] Pit privy [] Sewage lagoon [] Feedyard [] Livestock pens [] Fuel storage [] Fertilizer storage [] Insecticide storage [] Abandoned water well [] Oil well/Gas well [] Other (specify below) ROADS Direction from well? EAST & North How many feet? 654 - 532

Table with columns: FROM, TO, PLUGGING MATERIALS, FROM, TO, PLUGGING MATERIALS. Row 1: 27.49 - 3, Bentonite 16lb plug. Row 2: 3 - 0, Top soil.

7 CONTRACTOR'S OR LANDOWNER'S CERTIFICATION: This water well was plugged under my jurisdiction and was completed on (mo/day/year) 11-13-2021 and this record is true to the best of my knowledge and belief. Kansas Water Well Contractor's License No. 536. This Water Well Record was completed on (mo/day/year) 12-1-2021 under the business name of Kaler Pump & Well Drilling Inc by (signature) Tom E. Kaler

Send one white copy to Kansas Department of Health & Environment, Geology Section, 1000 SW Jackson Street, Ste. 420, Topeka, KS 66612-1367. Visit us at http://www.kdheks.gov/waterwell/index.html Telephone 785-296-5524.