

WATER WELL RECORD

Form WWC-5

Division of Water Resources App. No.

1 LOCATION OF WATER WELL: County: JOHNSON	Fraction <i>NE 1/4 SW 1/4 NE 1/4 SE 1/4</i>	Section Number 18	Township No. T 13 S	Range Number R 25 <input checked="" type="checkbox"/> E <input type="checkbox"/> W
---	--	----------------------	------------------------	---

Street/Rural Address of Well Location; if unknown, distance & direction from nearest town or intersection: If at owner's address, check here .

Global Positioning System (GPS) information:
 Latitude: (in decimal degrees)
 Longitude: (in decimal degrees)
 Elevation:
 Datum: WGS 84, NAD 83, NAD 27
 Collection Method:
 GPS unit (Make/Model:)
 Digital Map/Photo, Topographic Map, Land Survey
 Est. Accuracy: <3 m, 3-5 m, 5-15 m, >15 m

2 WATER WELL OWNER: PAUL ERCK
 RR#, Street Address, Box #: 11633 RILEY STREET
 City, State, ZIP Code : OVERLAND PARK, KS 66210

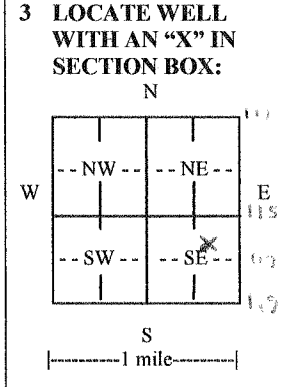

4 DEPTH OF COMPLETED WELL *Plugged* 400 ft. *2-400' Bores*

Depth(s) Groundwater Encountered (1) NONE ft. (2) ft. (3) ft.
 WELL'S STATIC WATER LEVEL *NONR* ft. below land surface measured on mo/day/yr.....
 Pump test data: Well water was ft. after hours pumping gpm
 EST. YIELD..... 0 gpm. Well water was ft. after hours pumping gpm
 Bore Hole Diameter ... 6 in. to 400 ft., and in. to ft.
 WELL WATER TO BE USED AS: Public water supply Geothermal Injection well
 Domestic Feedlot Oil field water supply Dewatering Other (Specify below)
 Irrigation Industrial Domestic-lawn & garden Monitoring well *CLOSED LOOP*
 Was a chemical/bacteriological sample submitted to Department? Yes No
 If yes, mo/day/yr sample was submitted.....
 Water well disinfected? Yes No

5 TYPE OF CASING USED: Steel PVC Other *H.D. POLYETHYLENE*.....
 CASING JOINTS: Glued Clamped Welded Threaded *Fusion*
 Casing diameter *1* in. to *400* ft., Diameter in. to ft., Diameter in. to ft.
 Casing height *above* land surface..... *36* in., Weight *SDR11* lbs./ft., Wall thickness or gauge No. *160 PSI*.....
 TYPE OF SCREEN OR PERFORATION MATERIAL: *None*
 Steel Stainless Steel PVC Other (Specify)
 Brass Galvanized Steel None used (open hole)
 SCREEN OR PERFORATION OPENINGS ARE: *None*
 Continuous slot Mill slot Gauze wrapped Torch cut Drilled holes None (open hole)
 Louvered shutter Key punched Wire wrapped Saw cut Other (specify)
 SCREEN-PERFORATED INTERVALS: From ft. to ft., From ft. to ft.
 From ft. to ft., From ft. to ft.
 GRAVEL PACK INTERVALS: From ft. to ft., From ft. to ft.
 From ft. to ft., From ft. to ft.

6 GROUT MATERIAL: Neat cement Cement grout Bentonite Other
 Grout Intervals: From *400* ft. to *3* ft., From ft. to ft., From ft. to ft.
 What is the nearest source of possible contamination:
 Septic tank Lateral lines Pit privy Livestock pens Insecticide storage Other (specify below)
 Sewer lines Cesspool Sewage lagoon Fuel storage Abandoned water well
 Watertight sewer lines Seepage pit Feedyard Fertilizer storage Oil well/gas well
 Direction from well Distance from well

FROM	TO	LITHOLOGIC LOG	FROM	TO	LITHO. LOG (cont.) or PLUGGING INTERVALS
0	12	SOIL/CLAY 168-173 LIME			
12	35	SANDSTONE 173-216 SHALE			
35	38	LIME 216-240 LIME			
38	42	SHALE 240-251 SHALE			
42	53	LIME 251-291 LIME	400	3	2-400' BORES PLUGGED
53	116	SHALE 291-300 SHALE			WITH HIGH SOLID BENTONITE
116	131	LIME 300-314 SANDSTONE			
131	155	SHALE 314-400 SHALE			
155	160	LIME			
160	168	SHALE			

7 CONTRACTOR'S OR LANDOWNER'S CERTIFICATION: This water well was constructed, reconstructed, or plugged under my jurisdiction and was completed on (mo/day/year) *5-1-14* and this record is true to the best of my knowledge and belief. Kansas Water Well Contractor's License No. *561* This Water Well Record was completed on (mo/day/year) *5-2-14* under the business name of *EVANS ENERGY DEVELOPMENT, INC.* by (signature) *[Signature]*

INSTRUCTIONS: Use typewriter or ball point pen. *PLEASE PRESS FIRMLY* and *PRINT* clearly. Please fill in blanks and check the correct answers. Send one copy to Kansas Department of Health and Environment, Bureau of Water, Geology Section, 1000 SW Jackson St., Suite 420, Topeka, Kansas 66612-1367. Telephone 785-296-5524. Send one copy to WATER WELL OWNER and retain one for your records. Include fee of \$5.00 for each constructed well. Visit us at <http://www.kdheks.gov/waterwell/index.html>