

WATER WELL RECORD

Form WWC-5

Division of Water Resources App. No.

Blank box for application number

1 LOCATION OF WATER WELL: County: Dickinson Co. SE 1/4 SE 1/4 SW 1/4 1/4 Section Number 21 Township No. T 13 R 3 Range Number 3

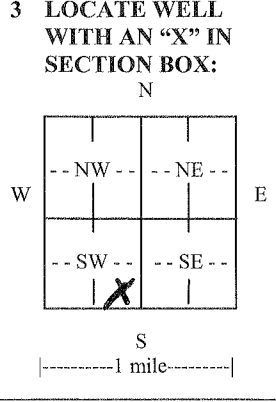

2 WATER WELL OWNER: Mark W. W... RR#, Street Address, Box #: 531 N.E. 673 City, State, ZIP Code: Abilene, KS 67410

3 LOCATE WELL WITH AN 'X' IN SECTION BOX: N, W, E, S. 4 DEPTH OF COMPLETED WELL: 120' ft. Depth(s) Groundwater Encountered (1) 68' ft. (2) ... (3) ... WELL'S STATIC WATER LEVEL: 60' ft. below land surface measured on mo/day/yr. EST. YIELD: 1.5 gpm. Bore Hole Diameter: 9" in. to 120' ft., and ... in. to ... ft.

5 TYPE OF CASING USED: Steel, PVC, Other. CASING JOINTS: Glued, Clamped, Welded, Threaded. Casing diameter: 5" in. to 100' ft., Diameter ... in. to ... ft., Diameter ... in. to ... ft. Casing height above land surface: 2 in., Weight 50 lbs./ft., Wall thickness or gauge No. ...

6 GROUT MATERIAL: Neat cement, Cement grout, Bentonite, Other. Grout Intervals: From 5' ft. to 32' ft., From ... ft. to ... ft., From ... ft. to ... ft. What is the nearest source of possible contamination: None Close. Direction from well ... Distance from well ...

7 CONTRACTOR'S OR LANDOWNER'S CERTIFICATION: This water well was constructed, reconstructed, or plugged under my jurisdiction and was completed on (mo/day/year) 3/14/2013 and this record is true to the best of my knowledge and belief. Kansas Water Well Contractor's License No. 451 This Water Well Record was completed on (mo/day/year) 4/10/2013 under the business name of Waldman Well Drilling by (signature) Craig W. Waldman