

WATER WELL RECORD Form WWC-5

Division of Water Resources App. No.

Well ID

Original Record Correction Change in Well Use

1 LOCATION OF WATER WELL: County: WABANSKI Co NE 1/4 SE 1/4 SE 1/4 Section Number 9 Township Number T14 S Range Number R12 E W

2 WELL OWNER: Last Name STEPHANSON First WAYNE Street or Rural Address where well is located (if unknown, distance and direction from nearest town or intersection): 163 Cedar Circle Alma KS ZIP 66401 From Eskridge Co 1 mile East on 8 mile Rd. Turn 8103 S on South on White Tail Rd.

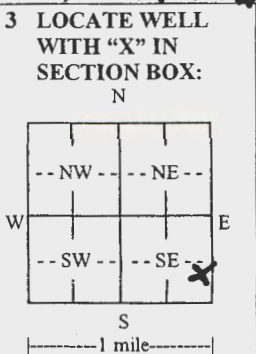

3 LOCATE WELL WITH 'X' IN SECTION BOX: N 4 DEPTH OF COMPLETED WELL: 100' ft. Depth(s) Groundwater Encountered: 1) 44' ft. 2) ... 3) ... or 4) Dry Well WELLS STATIC WATER LEVEL: 44' ft. 8/31/2022 below land surface, measured on (mo-day-yr) above land surface, measured on (mo-day-yr) Pump test data: Well water was ... after ... hours pumping ... gpm Well water was ... after ... hours pumping ... gpm Estimated Yield: 79 gpm Bore Hole Diameter: 7.9 in. to 100 ft. and ... in. to ... ft.

5 Latitude N 38° 50.628 (decimal degrees) Longitude W 096° 04.595 (decimal degrees) Horizontal Datum: WGS 84 NAD 83 NAD 27 Source for Latitude/Longitude: GPS (unit make/model GARMIN ETX 20 (WAAS enabled? Yes No) Land Survey Topographic Map Online Mapper: 6 Elevation: 1275' ft. Ground Level TOC Source: Land Survey GPS Topographic Map Other

7 WELL WATER TO BE USED AS: 1. Domestic: Household Lawn & Garden Livestock Irrigation Feedlot Industrial 2. Public Water Supply: well ID Dewatering: how many wells? Aquifer Recharge: well ID Monitoring: well ID Environmental Remediation: well ID Air Sparge Soil Vapor Extraction Recovery Injection 10. Oil Field Water Supply: lease 11. Test Hole: well ID Cased Uncased Geotechnical 12. Geothermal: how many bores? a) Closed Loop Horizontal Vertical b) Open Loop Surface Discharge Inj. of Water 13. Other (specify):

Was a chemical/bacteriological sample submitted to KDHE? Yes No If yes, date sample was submitted: Water well disinfected? Yes No

8 TYPE OF CASING USED: Steel PVC Other CASING JOINTS: Glued Clamped Welded Threaded Casing diameter 5 in. to 80 ft. Diameter 80 in. to ... ft. Diameter ... in. to ... ft. Casing height above land surface ... in. Weight 5ch 40 lbs./ft. Wall thickness or gauge No. TYPE OF SCREEN OR PERFORATION MATERIAL: Steel Stainless Steel Fiberglass PVC Other (Specify) Brass Galvanized Steel Concrete tile None used (open hole) SCREEN OR PERFORATION OPENINGS ARE: Continuous Slot Mill Slot Gauze Wrapped Torch Cut Drilled Holes Other (Specify) Louvered Shutter Key Punched Wire Wrapped Saw Cut None (Open Hole) SCREEN-PERFORATED INTERVALS: From 80 ft. to 100 ft. From ... ft. to ... ft. From ... ft. to ... ft. GRAVEL PACK INTERVALS: From 25 ft. to 100 ft. From ... ft. to ... ft. From ... ft. to ... ft.

9 GROUT MATERIAL: Neat cement Cement grout Bentonite Other Grout Intervals: From 5 ft. to 25 ft. From ... ft. to ... ft. From ... ft. to ... ft. Nearest source of possible contamination: Septic Tank Lateral Lines Pit Privy Livestock Pens Insecticide Storage Sewer Lines Cess Pool Sewage Lagoon Fuel Storage Abandoned Water Well Watertight Sewer Lines Seepage Pit Feedyard Fertilizer Storage Oil Well/Gas Well Other (Specify) Direction from well? North West Distance from well? 150' ft.

Table with columns: FROM, TO, LITHOLOGIC LOG, FROM, TO, LITHO. LOG (cont.) or PLUGGING INTERVALS. Rows include: 0-1 Top Soil, 1-6 Brown Clay, 6-44 Gray Shale Dark, 44-56 Limestone (water), 56-70 Argon Shale, 70-74 Limestone, 74-78 Limestone, 78-82 Limestone, 82-92 Grey Silty Shale.

11 CONTRACTOR'S OR LANDOWNER'S CERTIFICATION: This water well was constructed, reconstructed, or plugged under my jurisdiction and was completed on (mo-day-year) 8/31/2022 and this record is true to the best of my knowledge and belief. Kansas Water Well Contractor's License No. 451 This Water Well Record was completed on (mo-day-year) 9/7/2022 under the business name of Hallderson Well Drilling Co. W.D.P.S.

Mail 1 white copy along with a fee of \$3.00 for each constructed well to: Kansas Department of Health and Environment, Bureau of Water, GWTS Section, 1000 SW Jackson St., Suite 420, Topeka, Kansas 66612-1367. Mail one to Water Well Owner and retain one for your records. Telephone 785-296-5524.