



# DENNIS L HANDKE

T. 14 R. 15E Sec. 24

Osage County

1820 NW 59th Terrace  
TOPEKA, KANSAS 66618  
785-286-4047 Home  
785-286-1990 Fax

Jess Chapman  
Larsen & Assoc.  
1311 E. 25<sup>th</sup> St., Suite B  
Lawrence, Kansas 66046

June 23, 2023

RE: Monitor Well Elevation Survey  
106 N. Topeka Ave, Carbondale, Kansas

Proj. 23-00V  
Ramsdell Real Estate LLC  
KDHE ID U4-070-15276

Bench Mark: Chisled X on top South bolt of concrete sign base West of the building.  
Elev.: 1152.32      North 2772.63      West 5387.50      (from SE Cor. Sec. 19-14-16E)

|       |          |         |               |  |
|-------|----------|---------|---------------|--|
| MW-9  | rim      | 1135.86 | North 3042.52 | SE1/4,SE1/4,SE1/4,NE1/4 (Sec. 24-14-15E) |
|       | top pipe | 1135.40 | West 5440.77  | Lat = 38.81998      Long = 95.68698      |
| MW-11 | rim      | 1137.60 | North 3038.20 | SE1/4,SE1/4,SE1/4,N1/4 (Sec. 24-14-15E)  |
|       | top pipe | 1137.01 | West 5684.20  | Lat = 38.81996      Long = 95.68783      |

Lat & Long derived from Carbondale 7.5' quad map. WGS84.

Elevation derived from existing project, NAVD 88.

If you have any questions, please feel free to call me. Thank you for the opportunity to be of service to you.

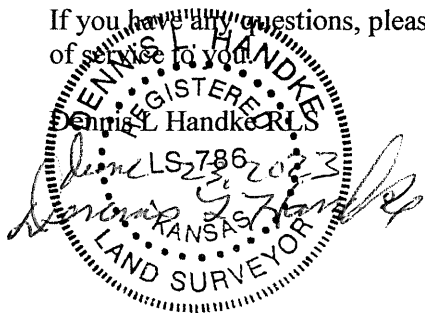

T. 14 R. 15E Sec. 24  
Osage County

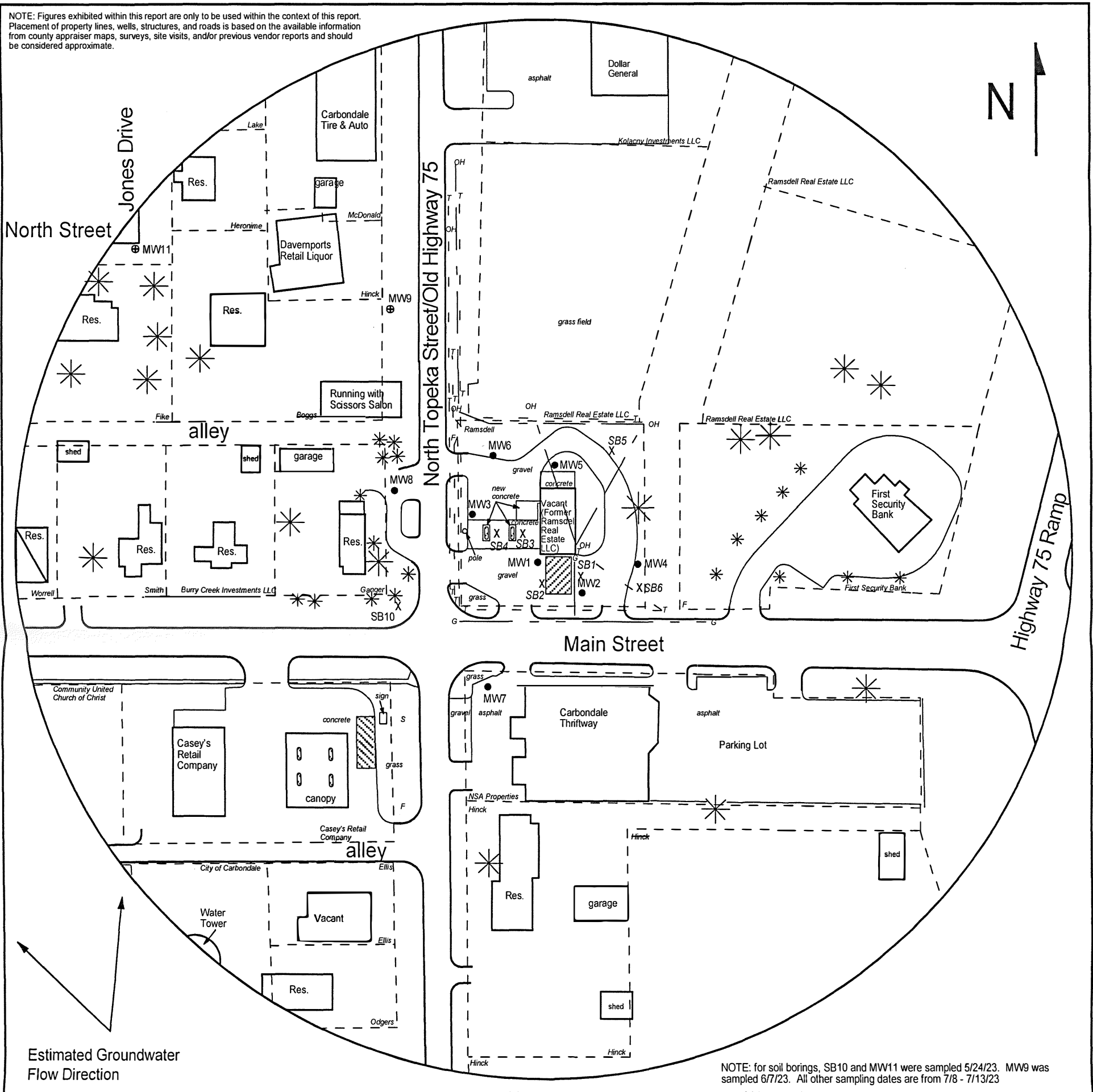

FIGURE 2.1 - 500 FT RADIUS AREA BASE MAP



1311 E 25th St., Suite B 785-841-8707 office  
Lawrence, KS 66046 785-865-4282 fax

PROJECT:  
Ramsdell Real Estate LLC  
106 N. Topeka Ave.  
Carbondale, KS  
KDHE ID: U4-070-15276  
Date: 6/8/23

0 100 ft

LEGEND

- Approximate Location of Former UST Basin Pump Islands
- Approximate Location of Active UST Basin Pump Islands
- Building with Basement
- Approximate Location of Property Line
- Existing Monitoring Well
- New Monitoring Well (Installed 5/24 and 6/7/23)
- Soil Boring (Drilled 7/8/21, 7/12-13/21, 5/24/23)
- Fire Hydrant
- Sewer Inlet
- Gas Lines (1.5 - 3 ft bgs)
- Overhead Lines (25'-40' high)
- Telephone Lines (2 - 6 ft bgs)

NOTE: SB5 & SB6 were drilled to collect hydrologic samples.  
NOTE: Utility depths, heights and locations are approximate.