

WATER WELL RECORD

Form WWC-5

Division of Water Resources App. No.

Well ID

MW4

[X] Original Record [ ] Correction [ ] Change in Well Use

1 LOCATION OF WATER WELL: County Osage, Fraction SW 1/4 SW 1/4 SW 1/4 NW 1/4, Section Number 19, Township Number T 14 S, Range Number R 16 E [X] [ ] W

2 WELL OWNER: Last Name: Business: Ramsdell Real Estate LLC, Address: 106 N Topeka Ave, City: Carbondale, State: KS, ZIP: 67330, Street or Rural Address where well is located: 106 N Topeka Ave, Carbondale, KS

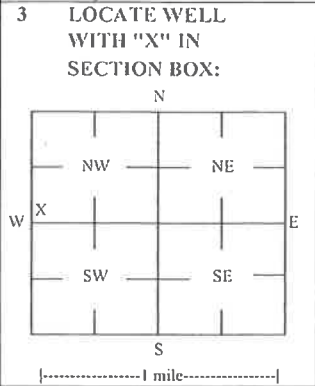

3 LOCATE WELL WITH 'X' IN SECTION BOX: 4 DEPTH OF COMPLETED WELL: 15 ft, Depth(s) Groundwater Encountered: 1) 15 ft, 2) ... ft, 3) ... ft, or 4) [ ] Dry Well, WELL'S STATIC WATER LEVEL: 9.25 ft, [X] below land surface, measured on (mo-day-yr) 8/12/2021, Pump test data: Well water was ... ft after ... hours pumping ... gpm, Water well was ... ft after ... hours pumping ... gpm, Estimated Yield: ... gpm, Bore Hole Diameter: 7.25 in to ... ft, ... in to ... ft

5 Latitude: 38.81928 (decimal degrees), Longitude: -95.68620 (decimal degrees), Horizontal Datum: [X] WGS 84 [ ] NAD 83 [ ] NAD 27, Source for Latitude/Longitude: [ ] GPS (unit make/model: ...), (WAAS enabled? [ ] Yes [ ] No), [X] Land Survey [ ] Topographic Map [ ] Online Mapper

6 Elevation: 1151.45 ft [ ] Ground Level [X] TOC, Source: [X] Land Survey [ ] GPS [ ] Topographic Map [ ] Other

7 WELL WATER TO BE USED AS: 1 Domestic: [ ] Household [ ] Lawn & Garden [ ] Livestock [ ] Irrigation [ ] Feedlot [ ] Industrial, 2 [ ] Public Water Supply: well ID, 3 [ ] Dewatering: how many wells?, 4 [ ] Aquifer Recharge: well ID, 5 [X] Monitoring: well ID MW4, 6 Environmental Remediation: well ID, 7 [ ] Air Sparge [ ] Soil Vapor Extractor [ ] Recovery [ ] Injection, 8 [ ] Oil Field Water Supply: lease, 9 Test Hole: well ID, [ ] Cased [ ] Uncased [ ] Geotechnical, 10 Geothermal: How many bores?, a) Closed Loop [ ] Horizontal [ ] Vertical, b) Open Loop [ ] Surface Discharge [ ] Inj. of Water, [ ] Other (specify):

Was a chemical/bacteriological sample submitted to KDHE? [ ] Yes [X] No, If yes, date sample was submitted: Water well disinfected? [ ] Yes [X] No

8 TYPE OF CASING USED: [ ] Steel [X] PVC [ ] Other, Casing diameter 2 in. to 5 ft, Diameter ... in. to ... ft, Casing height above land surface -0.51 in., Weight ... lbs./ft., Well thickness or gauge No, TYPE OF SCREEN OR PERFORATION MATERIAL: [ ] Steel [ ] Stainless Steel [ ] Fiberglass [X] PVC [ ] Brass [ ] Galvanized Steel [ ] Concrete tile [ ] None used (open hole), SCREEN OR PERFORATION OPENINGS ARE: [ ] Continuous Slot [X] Mill Slot [ ] Gauze Wrapped [ ] Torch Cut [ ] Drilled Holes [ ] Other (Specify), [ ] Louvered Shutter [ ] Key Punched [ ] Wire Wrapped [ ] Saw Cut [ ] None (Open Hole), SCREEN-PERFORATED INTERVALS: From 5 ft. to 15 ft., GRAVEL PACK INTERVALS: From 3 ft. to 15 ft.

9 GROUT MATERIAL: [ ] Neat cement [ ] Cement grout [X] Bentonite [X] Other Concrete: 0-0.5', Grout intervals: From 0.5 ft. to 3 ft., From ... ft. to ... ft., From ... ft. to ... ft.

Nearest source of possible contamination: [ ] Septic Tank [ ] Lateral Lines [ ] Pit Privy [ ] Livestock Pens [ ] Insecticide Storage, [ ] Sewer Lines [ ] Cess Pool [ ] Sewage Lagoon [X] Fuel Storage [ ] Abandoned Water Well, [ ] Watertight Sewer Lines [ ] Seepage Pit [ ] Feedyard [ ] Fertilizer Storage [ ] Oil Well / Gas Well, [ ] Other (Specify): Direction from well? W Distance from well? -65 ft

Table with 5 columns: FROM, TO, LITHOLOGIC LOG, FROM, TO, LITHO. LOG (cont.) or PLUGGING INTERVALS. Rows: 0-0.5 Soil, gravel, grass roots; 0.5-3 Clay; 3-4 Limestone, clay; 4-15 Weathered shale

Notes: KDHE ID: Ramsdell Real Estate LLC; U4-070-15276, Target of monitoring well is shallow groundwater, <20' of grout was installed at the direction of KDHE.

11 CONTRACTOR'S OR LANDOWNER'S CERTIFICATION: This water well was [X] constructed, [ ] reconstructed, or [ ] plugged under my jurisdiction and was completed on (mo-day-year) 7/12/21 and this record is true to the best of my knowledge and belief. Kansas Water Well Contractor's License No 757 This Water Well Record was completed on (mo-day-year) 8/13/21 under the business name of Larsen & Associates, Inc. Signature

# DENNIS L HANDKE

1820 NW 59th Terrace  
TOPEKA, KANSAS 66618  
785-286-4047 Home  
785-286-1990 Fax

Jess Chapman  
Larsen & Assoc.  
1311 E. 25<sup>th</sup> St., Suite B  
Lawrence, Kansas 66046

August 4, 2021

RE: Monitor Well Elevation Survey  
106 N. Topeka Ave, Carbondale, Kansas

Proj. 21-00X  
Ramsdell Real Estate LLC  
KDHE ID U4-070-15276

Bench Mark: Chisled X on top South bolt of concrete sign base West of the building.  
Elev.: 1152.32      North 2772.63      West 5387.50      (from SE Cor. Sec. 19-14-16E)

MW-1	rim	1151.89	North 2753.85	SW1/4,SW1/4,SW1/4,NW1/4
	top pipe	1151.57	West 5322.66	Lat = 38.81922    Long = 95.68654
MW-2	rim	1152.62	North 2721.98	SW1/4,SW1/4,SW1/4,NW1/4
	top pipe	1152.27	West 5276.73	Lat = 38.81913    Long = 95.68638
MW-3	rim	1151.32	North 2791.71	SW1/4,SW1/4,SW1/4,NW1/4
	top pipe	1150.65	West 5375.31	Lat = 38.81932    Long = 95.68672
MW-4	rim	1151.96	North 2758.41	SW1/4,SW1/4,SW1/4,NW1/4
	top pipe	1151.45	West 5225.68	Lat = 38.81928    Long = 95.68620
MW-5	rim	1150.85	North 2843.19	SW1/4,SW1/4,SW1/4,NW1/4
	top pipe	1150.59	West 5307.19	Lat = 38.81946    Long = 95.68648
MW-6	rim	1150.02	North 2847.12	SW1/4,SW1/4,SW1/4,NW1/4
	top pipe	1149.38	West 5355.55	Lat = 38.81947    Long = 95.68665
MW-7	rim	1154.10	North 2632.48	NW1/4,NW1/4,NW1/4,SW1/4
	top pipe	1153.67	West 5366.78	Lat = 38.81888    Long = 95.68669
MW-8	rim	1149.74	North 2820.03	SE1/4,SE1/4,SE1/4,NE1/4 (Sec. 24-14-15E)
	top pipe	1149.14	West 5460.16	Lat = 38.81940    Long = 95.68702

Lat & Long derived from Carbondale 7.5' quad map. WGS84.

Elevation derived from NGS BM U 12, NAVD 88.

If you have any questions, please feel free to call me. Thank you for the opportunity to be of service to you.

Dennis L Handke RL

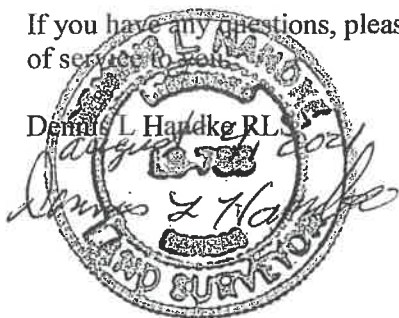

NOTE: Figures exhibited within this report are only to be used within the context of this report. Placement of property lines, wells, structures, and roads is based on the available information from county appraiser maps, surveys, site visits, and/or previous vendor reports and should be considered approximate.

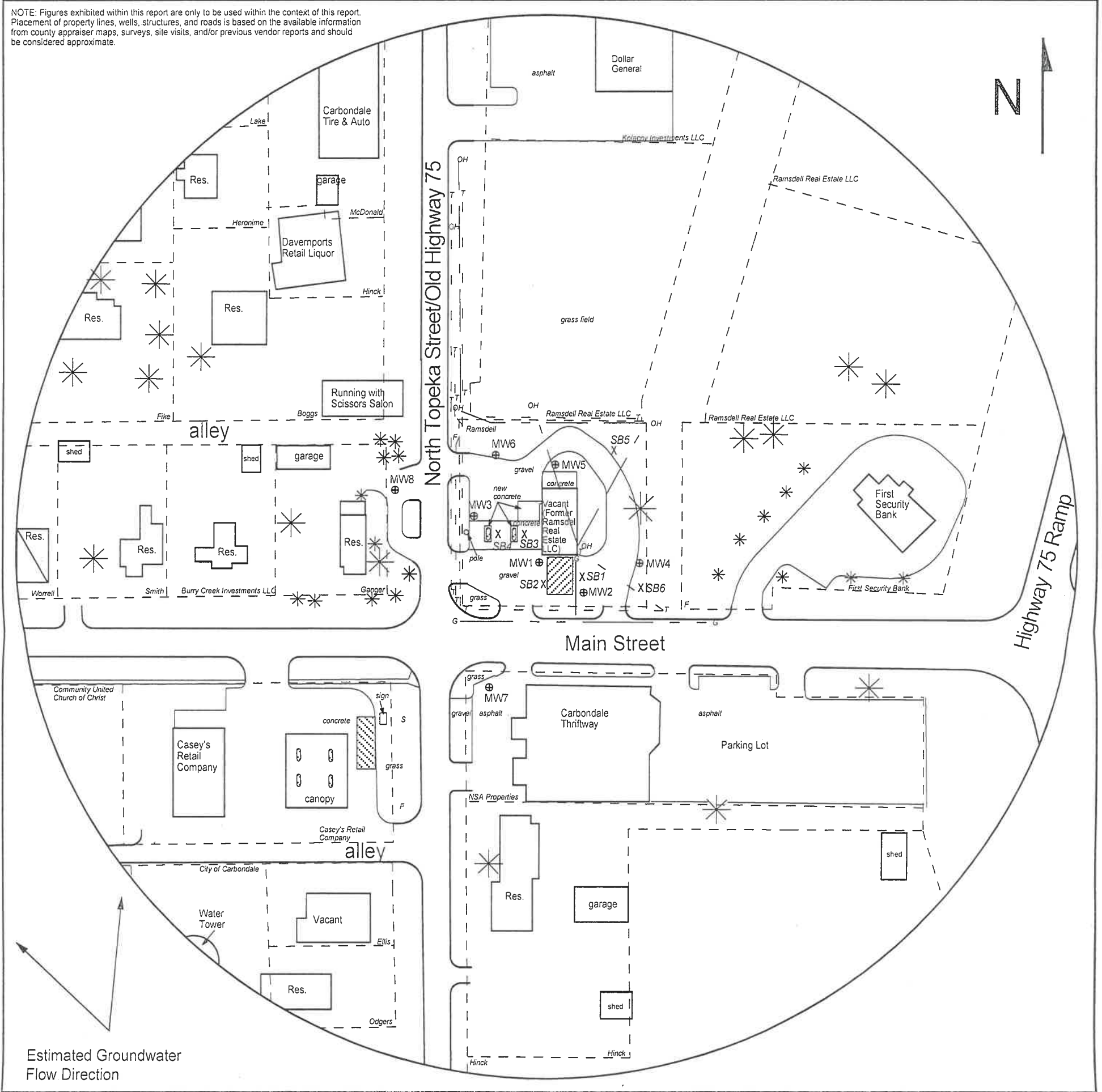

FIGURE 2.1 - 500 FT RADIUS AREA BASE MAP

**LEGEND**

- Approximate Location of Former UST Basin Pump Islands
- Approximate Location of Active UST Basin Pump Islands
- Building with Basement
- Approximate Location of Property Line
- Monitoring Well (Instaleld 7/8/21, 712-13/21)
- Soil Boring (Drilled 7/8/21, 712-13/21)
- Fire Hydrant
- Sewer Inlet
- Gas Lines (1.5 - 3 ft bgs)
- Overhead Lines (25'-40' high)
- Telephone Lines (2 - 6 ft bgs)

NOTE: SB5 & SB6 were drilled to collect hydrologic samples.  
NOTE: Utility depths, heights and locations are approximate.



**PROJECT:**

Ramsdell Real Estate LLC  
106 N. Topeka Ave.  
Carbondale, KS  
KDHE ID: U4-070-15276  
Date: 8/12/21



1311 E 25th St., Suite B 785-841-8707 office  
Lawrence, KS 66046 785-865-4282 fax

RECEIVED  
NOV 02 2021  
BUREAU OF WATER