

WATER WELL PLUGGING RECORD Form WWC-5P

KSA 82a-1212

ID NO.

MW-1

| | | | | |
|---|---|---------------------|---------------------------|---|
| 1 LOCATION OF WATER WELL: County: Johnson | Fraction NE 1/4 NE 1/4 NW 1/4 NW 1/4 | Section Number 2 | Township Number T 14 S | Range Number 23 <input checked="" type="checkbox"/> E <input type="checkbox"/> W |
|---|---|---------------------|---------------------------|---|

Street/Rural Address of Well Location; if unknown, distance & direction from nearest town or intersection: If at owner's address, check here 806 W. 56 Highway, Olathe, KS

Global Positioning Systems (GPS) information:
 Latitude: N 38.868154 (in decimal degrees)
 Longitude: W 94.827114 (in decimal degrees)
 Elevation: 1028.53
 Datum: WGS84, NAD83, NAD27
 Collection Method:
 GPS unit (Make/Model: _____)
 Digital Map/Photo, Topographic Map, Land Survey
 Est. Accuracy: < 3 m, 3-5 m, 5-15 m, > 15 m

2 WATER WELL OWNER: 7-Eleven, Inc
 RR#, St. Address, Box #: P.O. Box 711 (Loc. 0148)
 City, State ZIP Code: Dallas, TX 75221-0711

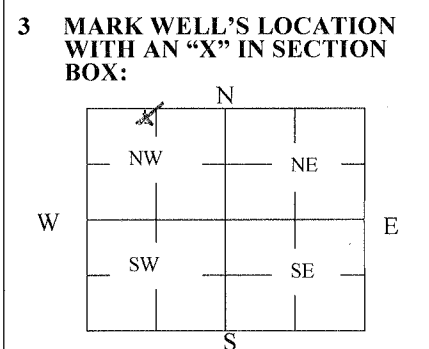

4 DEPTH OF WELL 11.99 ft.
 WELL'S STATIC WATER LEVEL 9.32 ft
 WELL WAS USED AS:
 Domestic Public Water Supply Dewatering
 Irrigation Oil Field Water Supply Monitoring
 Feedlot Domestic (Lawn & Garden) Injection Well
 Industrial Air Conditioning Other _____
 Was a chemical/bacteriological sample submitted to Department? Yes No

5 TYPE OF BLANK CASING USED:
 Steel RMP (SR) Wrought Fiberglass Other (Specify below)
 PVC ABS Asbestos-Cement Concrete Tile
 Blank casing diameter 2 in. Was casing pulled? Yes No If yes, how much 3-foot
 Casing height above or below land surface _____ in.

6 GROUT PLUG MATERIAL: Neat cement Cement grout Bentonite Other _____
 Grout Plug Intervals: From 0 ft. to 0.5 ft., From 0.5 ft. to 3 ft., From 3 to 11.99 ft.
 What is the nearest source of possible contamination:
 Septic tank Seepage pit Fuel Storage Other (specify below) UST basin
 Sewer lines Pit privy Fertilizer storage
 Watertight sewer lines Sewage lagoon Insecticide storage
 Lateral lines Feedyard Abandoned water well Direction from well? south
 Cess pool Livestock pens Oil well/Gas well How many feet? 1-foot

| FROM | TO | PLUGGING MATERIALS | FROM | TO | PLUGGING MATERIALS |
|------|-------|--------------------|------|----|--------------------|
| 0 | 0.5 | Asphalt | | | |
| 0.5 | 3 | Gravel | | | |
| 3 | 11.99 | Bentonite | | | |
| | | | | | |
| | | | | | |

7 CONTRACTOR'S OR LANDOWNER'S CERTIFICATION: This water well was plugged under my jurisdiction and was completed on (mo/day/year) 04/07/2011 and this record is true to the best of my knowledge and belief. Kansas Water Well Contractor's License No. N/A. This Water Well Record was completed on (mo/day/year) 05/11/2011 under the business name of AECOM as agent for 7-Eleven, Inc by (signature) [Signature]

INSTRUCTIONS: Use typewriter or ballpoint pen. Please press firmly and print clearly. Please fill in blanks, underline or circle the correct answers. Send top three copies to Kansas Department of Health and Environment, Bureau of Water, Geology Section, 1000 SW Jackson St., Ste. 420, Topeka, Kansas 66612-1367. Telephone: 785/296-5524. Send one to Water Well Owner and retain one for your records. Visit us at <http://www.kdheks.gov/waterwell/index.html>.

Check one: White Copy Blue Copy Pink Copy