

**1 LOCATION OF WATER WELL:** Fraction 1/4 SE 1/4 NE 1/4 NE 1/4 Section Number 3 Township Number T 14 S Range Number 23  E  W  
 County: Johnson  
 Street/Rural Address of Well Location; if unknown, distance & direction from nearest town or intersection: If at owner's address, check here  1001 W. Old 56 Highway Olathe, KS 66061  
**Global Positioning Systems (GPS) information:**  
 Latitude: 38.86588 (in decimal degrees)  
 Longitude: -94.83561 (in decimal degrees)  
 Elevation: 1056.61  
 Horizontal Datum:  WGS84,  NAD83,  NAD27  
 Collection Method:  GPS unit (Make/Model: Garmin etrek)  
 Digital Map/Photo,  Topographic Map,  Land Survey  
 Est. Accuracy:  < 3 m,  3-5 m,  5-15 m,  > 15 m

**2 WATER WELL OWNER:** Northrop Gunman  
 RR#, St. Address, Box #: 1480 Century Park East  
 City, State ZIP Code: Los Angeles CA 90067

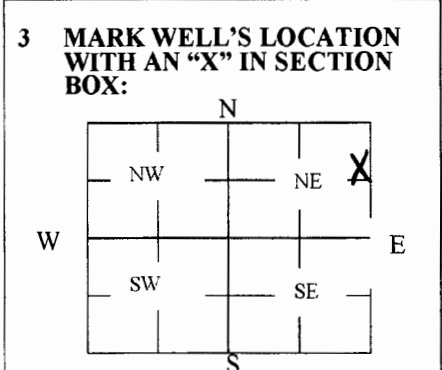

**4 DEPTH OF WELL** 30 ft.  
 WELL'S STATIC WATER LEVEL \_\_\_\_\_ ft  
 WELL WAS USED AS:  
 Domestic  Public Water Supply  Dewatering  
 Irrigation  Oil Field Water Supply  Monitoring MW-10  
 Feedlot  Domestic (Lawn & Garden)  Injection Well  
 Industrial  Air Conditioning  Other \_\_\_\_\_  
 Was a chemical/bacteriological sample submitted to Department? Yes  No

**5 TYPE OF BLANK CASING USED:**  
 Steel  RMP (SR)  Wrought  Fiberglass  Other (Specify below)  
 PVC  ABS  Asbestos-Cement  Concrete Tile  
 Blank casing diameter 2 in. Was casing pulled? Yes  No  If yes, how much Top 4.5 feet removed  
 Casing height above or below land surface -6 in.

**6 GROUT PLUG MATERIAL:**  Neat cement  Cement grout  Bentonite  Other Top Soil/Concrete  
 Grout Plug Intervals: From 0 ft. to 3 ft., From 3 ft. to 30 ft., From \_\_\_\_\_ ft. to \_\_\_\_\_ ft.  
 What is the nearest source of possible contamination:  
 Septic tank  Seepage pit  Fuel storage  Other (specify below) \_\_\_\_\_  
 Sewer lines  Pit privy  Fertilizer storage  unknown \_\_\_\_\_  
 Watertight sewer lines  Sewage lagoon  Insecticide storage \_\_\_\_\_  
 Lateral lines  Feedyard  Abandoned water well Direction from well? unknown  
 Cess pool  Livestock pens  Oil well/Gas well How many feet? unknown

FROM	TO	PLUGGING MATERIALS	FROM	TO	PLUGGING MATERIALS
0	3	Concrete			
3	30	Bentonite			

**7 CONTRACTOR'S OR LANDOWNER'S CERTIFICATION:** This water well was plugged under my jurisdiction and was completed on (mo/day/year) 02/26/2018 and this record is true to the best of my knowledge and belief. Kansas Water Well Contractor's License No. 710. This Water Well Record was completed on (mo/day/year) 02/28/2018 under the business name of Below Ground Surface, Inc. by (signature) Craig R. Hew

Send one white copy to Kansas Department of Health & Environment, Geology Section, 1000 SW Jackson Street, Ste. 420, Topeka, KS 66612-1367. Send one copy to WATER WELL OWNER and retain one for your records.  
 Visit us at <http://www.kdheks.gov/waterwell/index.html> Telephone 785-296-5524.

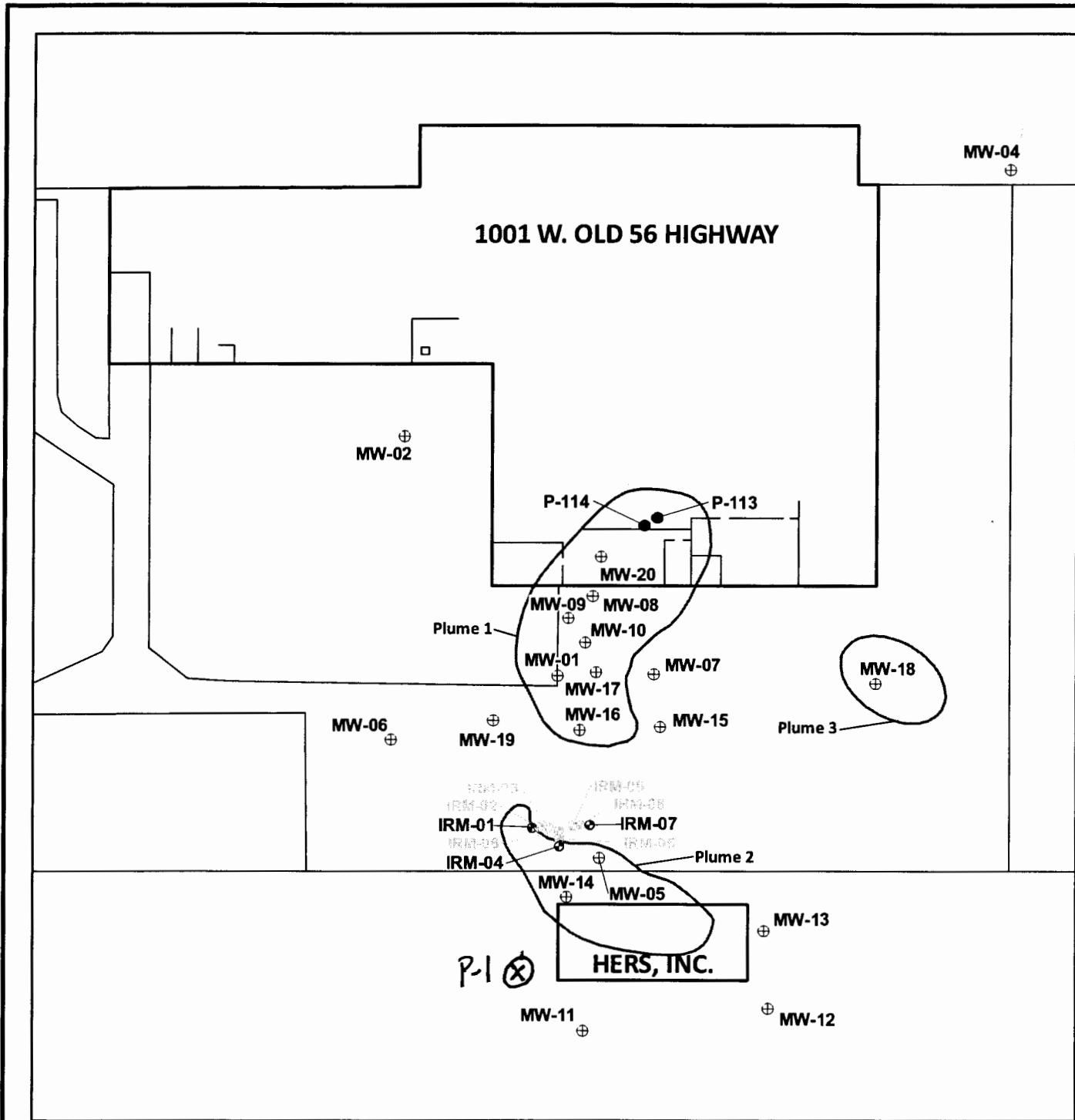

- ⊕ Permanent Monitoring Well
- Piezometer
- ⊕ IRM Test Well
- ⊕ Abandoned IRM Test Well
- ⊕ Groundwater Plume Boundary

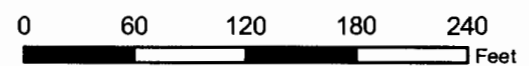

**AECOM**

VOC Groundwater Plume Map

Cresticon, Inc.  
Former Cresticon Twin City Tool Facility



Figure 4