

1 LOCATION OF WATER WELL: Fraction 1/4 SE 1/4 NE 1/4 NE 1/4 Section Number 3 Township Number T 14 S Range Number 23 E W
 County: Johnson

Street/Rural Address of Well Location; if unknown, distance & direction from nearest town or intersection: If at owner's address, check here 1001 W. Old 56 Highway Olathe, KS 66061

Global Positioning Systems (GPS) information:
 Latitude: 38.86550 (in decimal degrees)
 Longitude: -94.835638 (in decimal degrees)
 Elevation: 1055.89
 Horizontal Datum: WGS84, NAD83, NAD27
 Collection Method: _____

2 WATER WELL OWNER: Northrop Gunman
 RR#, St. Address, Box #: 1480 Century Park East
 City, State ZIP Code: Los Angeles CA 90067

GPS unit (Make/Model: Garmin etrek)
 Digital Map/Photo, Topographic Map, Land Survey
 Est. Accuracy: < 3 m, 3-5 m, 5-15 m, > 15 m

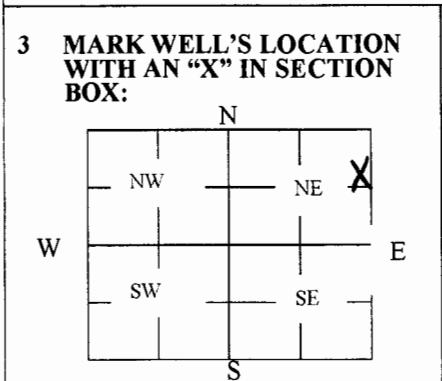

4 DEPTH OF WELL 30 ft.
 WELL'S STATIC WATER LEVEL _____ ft
 WELL WAS USED AS:
 Domestic Public Water Supply Dewatering
 Irrigation Oil Field Water Supply Monitoring IRM-7
 Feedlot Domestic (Lawn & Garden) Injection Well
 Industrial Air Conditioning Other _____
 Was a chemical/bacteriological sample submitted to Department? Yes No

5 TYPE OF BLANK CASING USED:

Steel RMP (SR) Wrought Fiberglass Other (Specify below)
 PVC ABS Asbestos-Cement Concrete Tile

Blank casing diameter 2 in. Was casing pulled? Yes No If yes, how much all _____
 Casing height above or below land surface -6 in.

6 GROUT PLUG MATERIAL: Neat cement Cement grout Bentonite Other Top Soil/Concrete

Grout Plug Intervals: From 0 ft. to 3 ft., From 3 ft. to 30 ft., From _____ ft. to _____ ft.

What is the nearest source of possible contamination:

Septic tank Seepage pit Fuel storage Other (specify below) _____
 Sewer lines Pit privy Fertilizer storage unknown
 Watertight sewer lines Sewage lagoon Insecticide storage
 Lateral lines Feedyard Abandoned water well Direction from well? unknown
 Cess pool Livestock pens Oil well/Gas well How many feet? unknown

FROM	TO	PLUGGING MATERIALS	FROM	TO	PLUGGING MATERIALS
0	3	Concrete			
3	30	Bentonite			

7 CONTRACTOR'S OR LANDOWNER'S CERTIFICATION: This water well was plugged under my jurisdiction and was completed on (mo/day/year) 02/26/2018 and this record is true to the best of my knowledge and belief. Kansas Water Well Contractor's License No. 710. This Water Well Record was completed on (mo/day/year) 02/28/2018 under the business name of Below Ground Surface, Inc. by (signature) Craig R. H...

Send one white copy to Kansas Department of Health & Environment, Geology Section, 1000 SW Jackson Street, Ste. 420, Topeka, KS 66612-1367. Send one copy to WATER WELL OWNER and retain one for your records.
 Visit us at <http://www.kdheks.gov/waterwell/index.html> Telephone 785-296-5524.

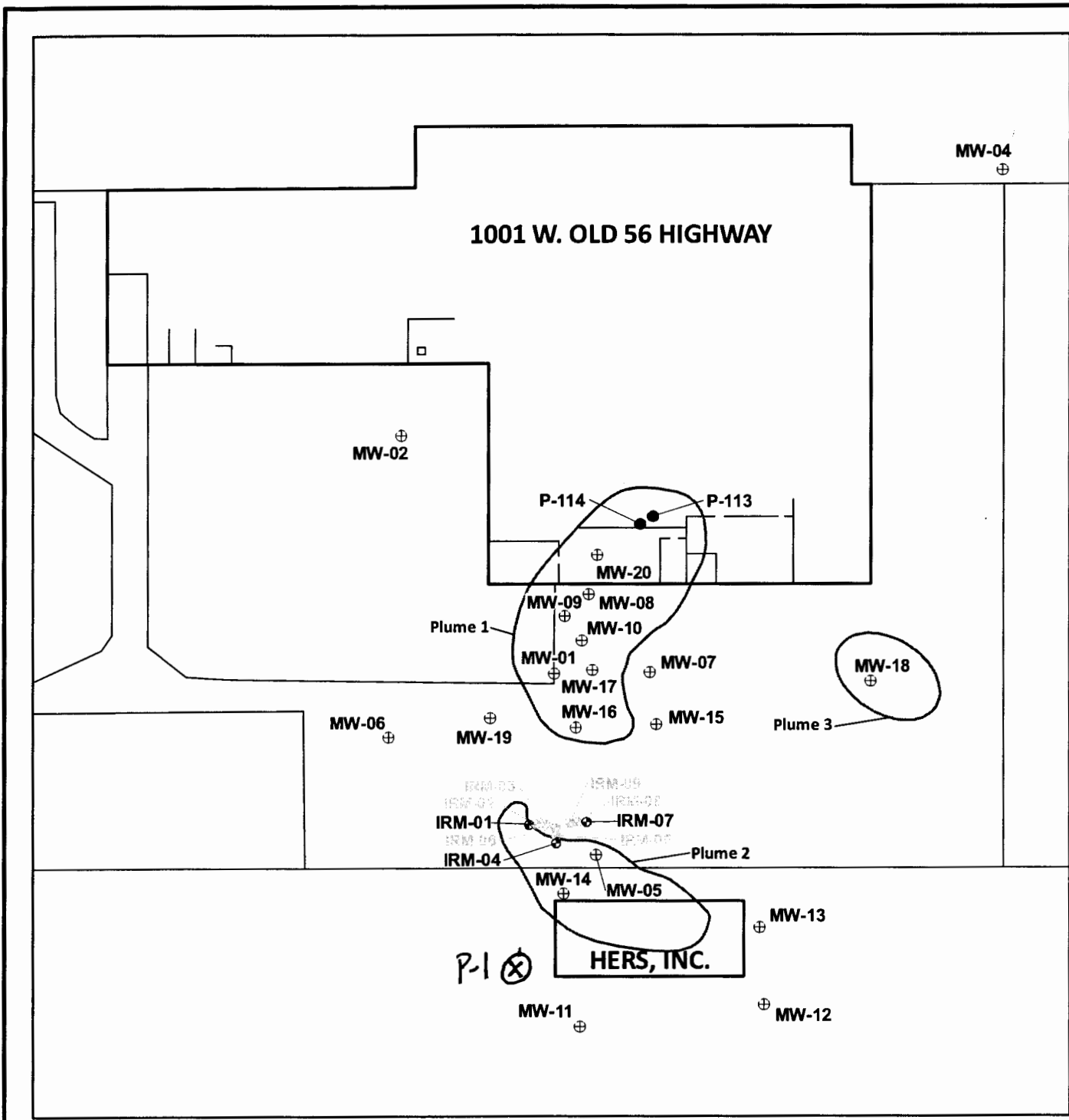

- ⊕ Permanent Monitoring Well
- Piezometer
- ⊗ IRM Test Well
- ⊕ Abandoned IRM Test Well
- ⊕ Groundwater Plume Boundary

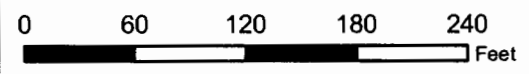

AECOM

VOC Groundwater Plume Map

Cresticon, Inc.
Former Cresticon Twin City Tool Facility



Figure 4