

1 LOCATION OF WATER WELL: Fraction NE 1/4 SW 1/4 SW 1/4 NW 1/4 Section Number 8 Township Number T 14 S Range Number 25 E W

Street/Rural Address of Well Location: if unknown, distance & direction from nearest town or intersection: If at owner's address, check here
 6869 West 153rd Street, Overland Park

Global Positioning Systems (GPS) information:
 Latitude: 38.84827 (in decimal degrees)
 Longitude: 94.66543 (in decimal degrees)
 Elevation: NA
 Horizontal Datum WGS84, NAD83, NAVD27
 Collection Method:

2 WATER WELL OWNER: City of Overland Park
 RR#, St. Address, Box #: 11300 W 91st St.
 City, State ZIP Code: Overland Park, KS 66214

GPS unit (Make/model: _____)
 Digital Map/Photo, Topographic Map Land Survey
 Est. Accuracy: <3 m, 3-5 m, 5-15 m, >15 m

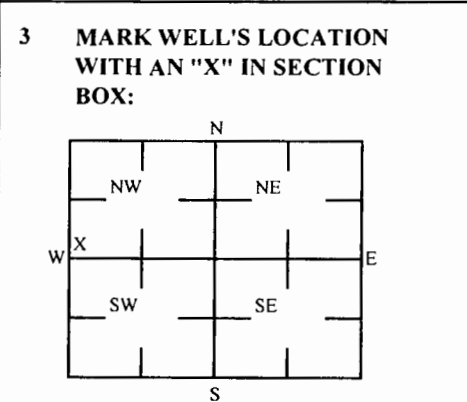

4 DEPTH OF WELL 17.4 ft. MW2
 WELL'S STATIC WATER LEVEL _____ ft
 WELL WAS USED AS:
 Domestic Public Water Supply Dewatering
 Irrigation Oil Field Water Supply Monitoring
 Feedlot Domestic (Lawn & Garden) Injection Well
 Industrial Air Conditioning Other _____
 Was a chemical/bacteriological sample submitted to Department? Yes No

5 TYPE OF BLANK CASING USED:

Steel RMP (SR) Wrought Fiberglass Other (Specific below)
 PVC ABS Asbestos-Cement Concrete Tile

Blank casing diameter 2 in. Was casing pulled? Yes No If yes, how much 3 ft
 Casing height above or below land surface NA in.

6 GROUT PLUG MATERIAL: Neat cement Cement grout Bentonite Other Asphalt: 0-0.5'; Soil: 0.5-3'

Grout Plug Intervals: From 3 ft to 17.4 ft, From _____ ft to _____ ft, From _____ ft to _____ ft.

What is the nearest source of possible contamination:

Septic tank Seepage pit Fuel storage Other (specify below) _____
 Sewer lines Pit privy Fertilizer storage _____
 Watertight sewer lines Sewage lagoon Insecticide storage _____
 Lateral lines Feed yard Abandoned water well _____
 Cess pool Livestock pens Oil well/Gas well _____

Direction from well? _____
 How many feet? _____

FROM	TO	PLUGGING MATERIALS	FROM	TO	PLUGGING MATERIALS
0	0.5	Asphalt			
0.5	3	Soil			
3	17.4	Bentonite			
KDHE ID: Public Works, Blue Valley; U4-046-15237					

7 CONTRACTOR'S OR LANDOWNER'S CERTIFICATION: This water well was plugged under my jurisdiction and was completed on (mo/day/year) 5/31/22 and this record is true to the best of my knowledge and belief. Kansas Water Contractor's License No. 757. This Water Well Record was completed on (mo/day/year) 6/9/22 under the business name of Larsen & Associates, Inc. By (signature) _____

Send one white copy to Kansas Department of Health & Environment, Geology Section, 1000 SW Jackson Street, Ste. 420, Topeka, KS 66612-1367. Send one copy to WATER WELL OWNER and retain one for your records
 Visit us at <http://www.kdheks.gov/waterwell/index.html> Telephone 785-296-5524.

NOTE: Figures exhibited within this report are only to be used within the context of this report. Placement of property lines, wells, structures, and roads is based on the available information from county appraiser maps, surveys, site visits, and/or previous vendor reports and should be considered approximate.

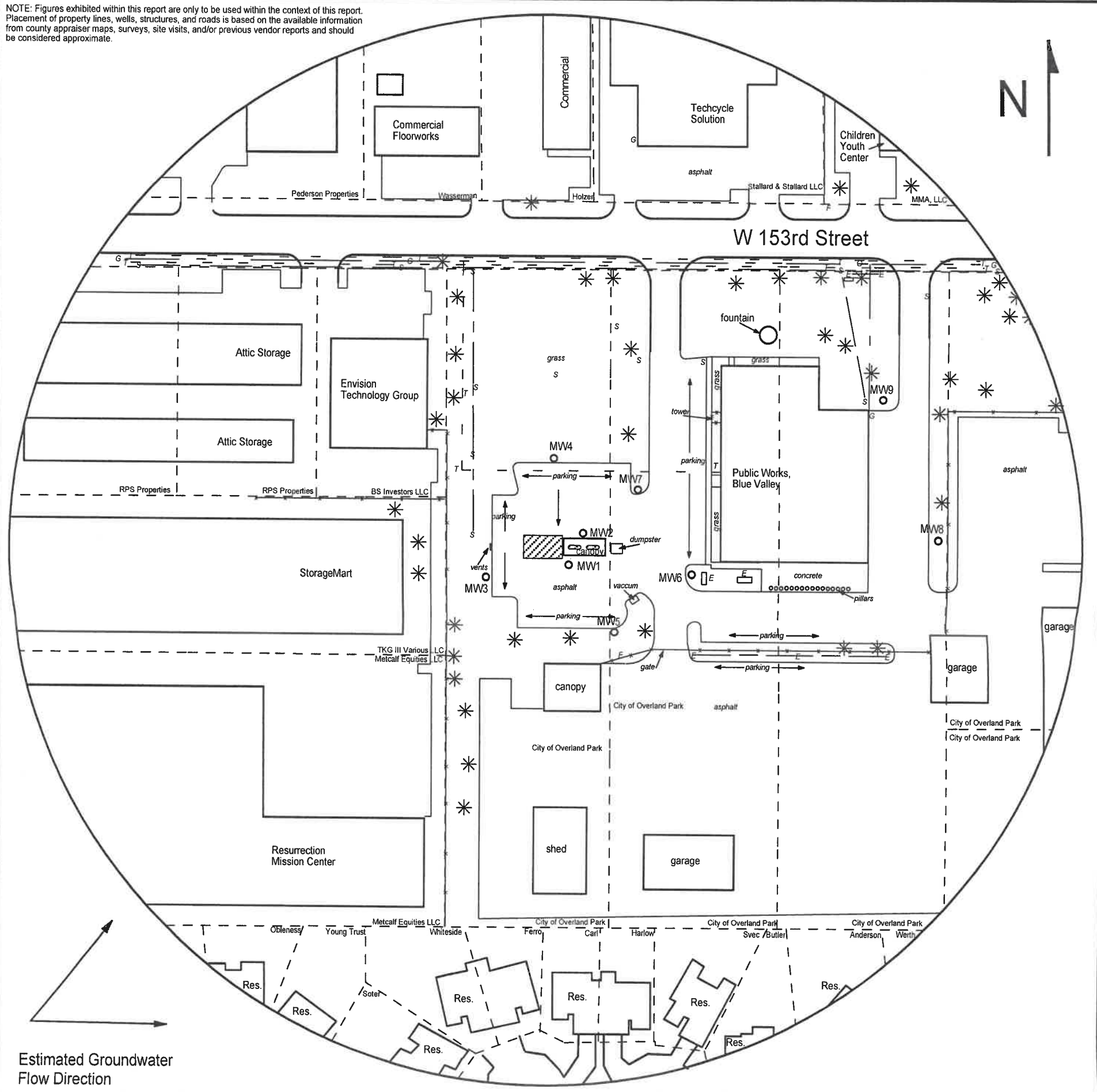

FIGURE 1 - 500 FT RADIUS AREA BASE MAP

LEGEND

- Approximate Location of Active UST Basin & Pump Islands
- - - Approximate Location of Property Line
- Plugged Monitoring Well
- x Soil Boring (SB1-SB6 drilled 2/3/21)
- x SB7-SB9 drilled 5/31/22)
- F Fire Hydrant
- E- Electric Lines (1.5 - 3 ft bgs)
- G- Gas Lines (1.5 - 3 ft bgs)
- S- Sewer Lines (2 - 6 ft bgs)
- T- Telephone Lines (2 - 6 ft bgs)

NOTE: Utility depths, heights and locations are approximate.
NOTE: WaterOne has no mains or services at this location.



PROJECT:
Public Works, Blue Valley
6869 West 153rd Street
Overland Park, KS
KDHE ID: U4-046-15237
Date: 5/31/22



1311 E 25th St., Suite B 785-841-8707 office
Lawrence, KS 66046 785-865-4282 fax