

**WATER WELL PLUGGING RECORD Form WWC-5P KSA 82a-1212 ID NO.**

MW6

<b>1 LOCATION OF WATER WELL:</b> County: Johnson	Fraction SW¼ SE¼ SW¼ NW¼	Section Number 8	Township Number T 14 S	Range Number 25 <input checked="" type="checkbox"/> E <input type="checkbox"/> W
---	-----------------------------	---------------------	---------------------------	---

Street/Rural Address of Well Location: if unknown, distance & direction from nearest town or intersection: If at owner's address, check here   
6869 West 153rd Street, Overland Park

**Global Positioning Systems (GPS) information:**  
 Latitude: 38.84847 (in decimal degrees)  
 Longitude: 94.66521 (in decimal degrees)  
 Elevation: NA  
 Horizontal Datum  WGS84,  NAD83,  NAVD27  
 Collection Method:  
 GPS unit (Make/model: \_\_\_\_\_)  
 Digital Map/Photo,  Topographic Map  Land Survey  
 Est. Accuracy:  <3 m,  3-5 m,  5-15 m,  >15 m

**2 WATER WELL OWNER:** City of Overland Park  
 RR#, St. Address, Box #: 11300 W 91st St.  
 City, State ZIP Code: Overland Park, KS 66214

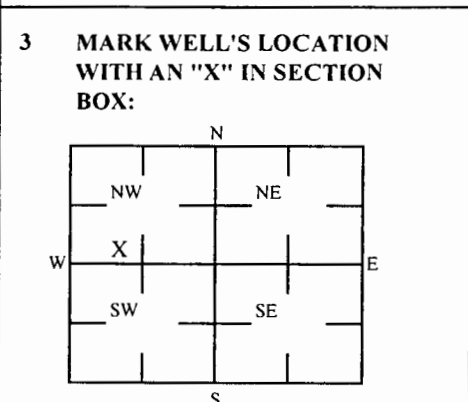

**4 DEPTH OF WELL** 15.9 ft. MW6  
 WELL'S STATIC WATER LEVEL \_\_\_\_\_ ft  
 WELL WAS USED AS:  
 Domestic  Public Water Supply  Dewatering  
 Irrigation  Oil Field Water Supply  Monitoring  
 Feedlot  Domestic (Lawn & Garden)  Injection Well  
 Industrial  Air Conditioning  Other \_\_\_\_\_  
 Was a chemical/bacteriological sample submitted to Department? Yes  No

**5 TYPE OF BLANK CASING USED:**

<input type="checkbox"/> Steel	<input type="checkbox"/> RMP (SR)	<input type="checkbox"/> Wrought	<input type="checkbox"/> Fiberglass	<input type="checkbox"/> Other (Specific below)
<input checked="" type="checkbox"/> PVC	<input type="checkbox"/> ABS	<input type="checkbox"/> Asbestos-Cement	<input type="checkbox"/> Concrete Tile	_____

Blank casing diameter 2 in. Was casing pulled? Yes  No  If yes, how much 3 ft  
 Casing height above or below land surface NA in.

**6 GROUT PLUG MATERIAL:**  Neat cement  Cement grout  Bentonite  Other Soil: 0-3'

Grout Plug Intervals: From 3 ft to 15.9 ft, From \_\_\_\_\_ ft to \_\_\_\_\_ ft, From \_\_\_\_\_ ft to \_\_\_\_\_ ft.

What is the nearest source of possible contamination:

<input type="checkbox"/> Septic tank	<input type="checkbox"/> Seepage pit	<input checked="" type="checkbox"/> Fuel storage	<input type="checkbox"/> Other (specify below)
<input type="checkbox"/> Sewer lines	<input type="checkbox"/> Pit privy	<input type="checkbox"/> Fertilizer storage	_____
<input type="checkbox"/> Watertight sewer lines	<input type="checkbox"/> Sewage lagoon	<input type="checkbox"/> Insecticide storage	_____
<input type="checkbox"/> Lateral lines	<input type="checkbox"/> Feed yard	<input type="checkbox"/> Abandoned water well	Direction from well? _____
<input type="checkbox"/> Cess pool	<input type="checkbox"/> Livestock pens	<input type="checkbox"/> Oil well/Gas well	How many feet? _____

FROM	TO	PLUGGING MATERIALS	FROM	TO	PLUGGING MATERIALS
0	3	Soil			
3	15.9	Bentonite			

KDHE ID: Public Works, Blue Valley; U4-046-15237

**7 CONTRACTOR'S OR LANDOWNER'S CERTIFICATION:** This water well was plugged under my jurisdiction and was completed on (mo/day/year) 5/31/22 and this record is true to the best of my knowledge and belief. Kansas Water Contractor's License No. 757. This Water Well Record was completed on (mo/day/year) 6/9/22 under the business name of Larsen & Associates, Inc. By (signature) \_\_\_\_\_

Send one white copy to Kansas Department of Health & Environment, Geology Section, 1000 SW Jackson Street, Ste. 420, Topeka, KS 66612-1367. Send one copy to WATER WELL OWNER and retain one for your records  
 Visit us at <http://www.kdheks.gov/waterwell/index.html> Telephone 785-296-5524.

NOTE: Figures exhibited within this report are only to be used within the context of this report. Placement of property lines, wells, structures, and roads is based on the available information from county appraiser maps, surveys, site visits, and/or previous vendor reports and should be considered approximate.

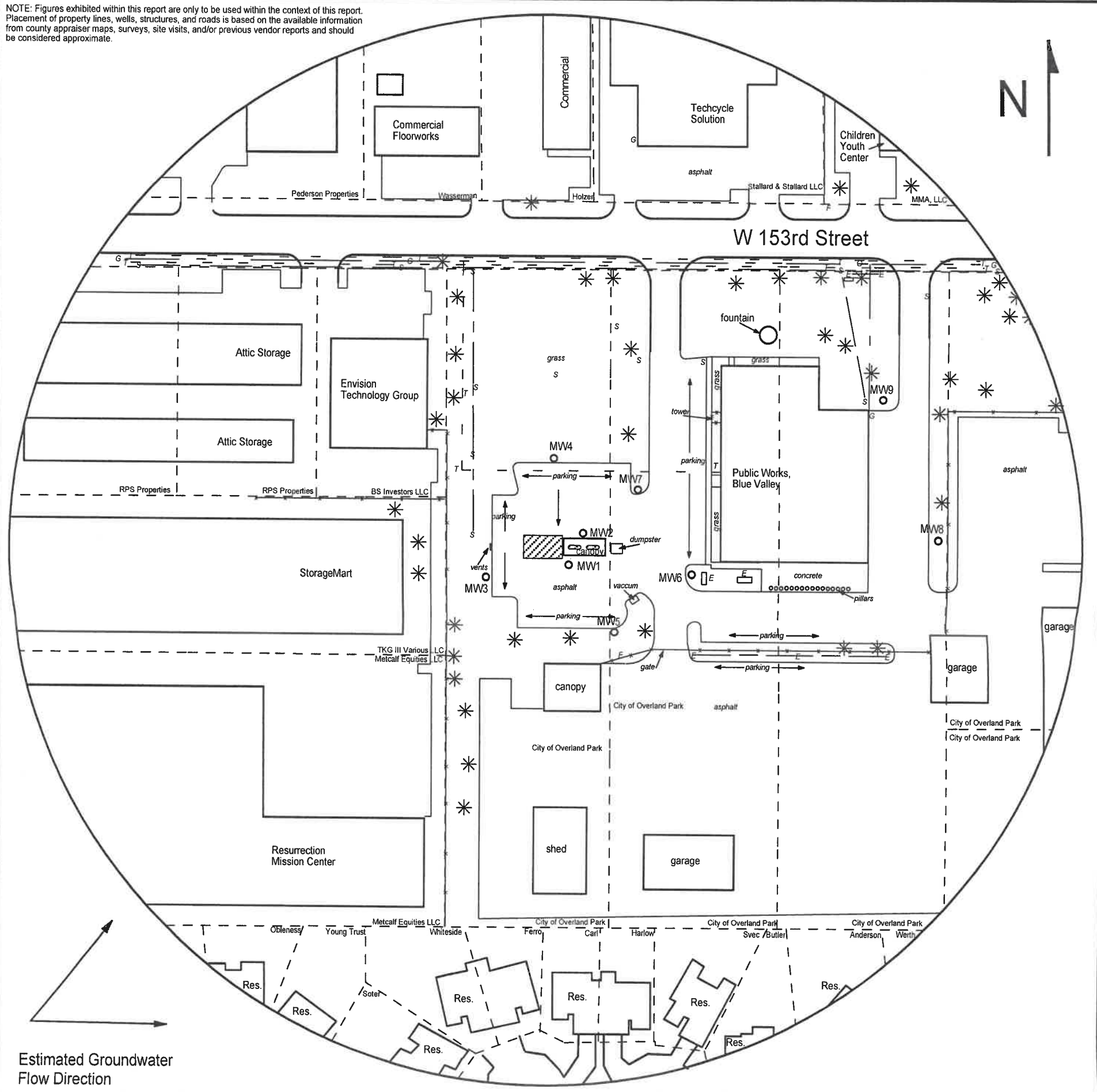

FIGURE 1 - 500 FT RADIUS AREA BASE MAP

**LEGEND**

- Approximate Location of Active UST Basin & Pump Islands
- - - Approximate Location of Property Line
- Plugged Monitoring Well
- x Soil Boring (SB1-SB6 drilled 2/3/21)
- x SB7-SB9 drilled 5/31/22)
- F Fire Hydrant
- E- Electric Lines (1.5 - 3 ft bgs)
- G- Gas Lines (1.5 - 3 ft bgs)
- S- Sewer Lines (2 - 6 ft bgs)
- T- Telephone Lines (2 - 6 ft bgs)

NOTE: Utility depths, heights and locations are approximate.  
NOTE: WaterOne has no mains or services at this location.



**PROJECT:**  
Public Works, Blue Valley  
6869 West 153rd Street  
Overland Park, KS  
KDHE ID: U4-046-15237  
Date: 5/31/22



1311 E 25th St., Suite B 785-841-8707 office  
Lawrence, KS 66046 785-865-4282 fax