

DENNIS L HANDKE

T. 14 R. 15E Sec. 24

Osage County

1820 NW 59th Terrace
TOPEKA, KANSAS 66618
785-286-4047 Home
785-286-1990 Fax

Jess Chapman
Larsen & Assoc.
1311 E. 25th St., Suite B
Lawrence, Kansas 66046

June 23, 2023

RE: Monitor Well Elevation Survey
106 N. Topeka Ave, Carbondale, Kansas

Proj. 23-00V
Ramsdell Real Estate LLC
KDHE ID U4-070-15276

Bench Mark: Chisled X on top South bolt of concrete sign base West of the building.
Elev.: 1152.32 North 2772.63 West 5387.50 (from SE Cor. Sec. 19-14-16E)

MW-9	rim	1135.86	North	3042.52	SE1/4,SE1/4,SE1/4,NE1/4 (Sec. 24-14-15E)
	top pipe	1135.40	West	5440.77	Lat = 38.81998 Long = 95.68698
MW-11	rim	1137.60	North	3038.20	SE1/4,SE1/4,SE1/4,N1/4 (Sec. 24-14-15E)
	top pipe	1137.01	West	5684.20	Lat = 38.81996 Long = 95.68783

Lat & Long derived from Carbondale 7.5' quad map. WGS84.

Elevation derived from existing project, NAVD 88.

If you have any questions, please feel free to call me. Thank you for the opportunity to be of service to you.

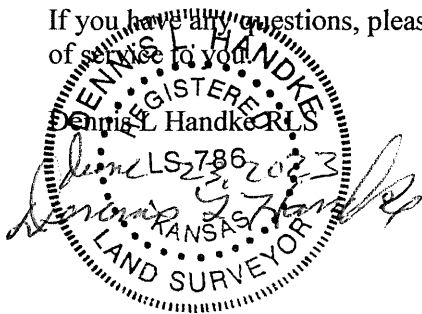

T. 14 R. 15E Sec. 24
Osage County

NOTE: Figures exhibited within this report are only to be used within the context of this report. Placement of property lines, wells, structures, and roads is based on the available information from county appraiser maps, surveys, site visits, and/or previous vendor reports and should be considered approximate.

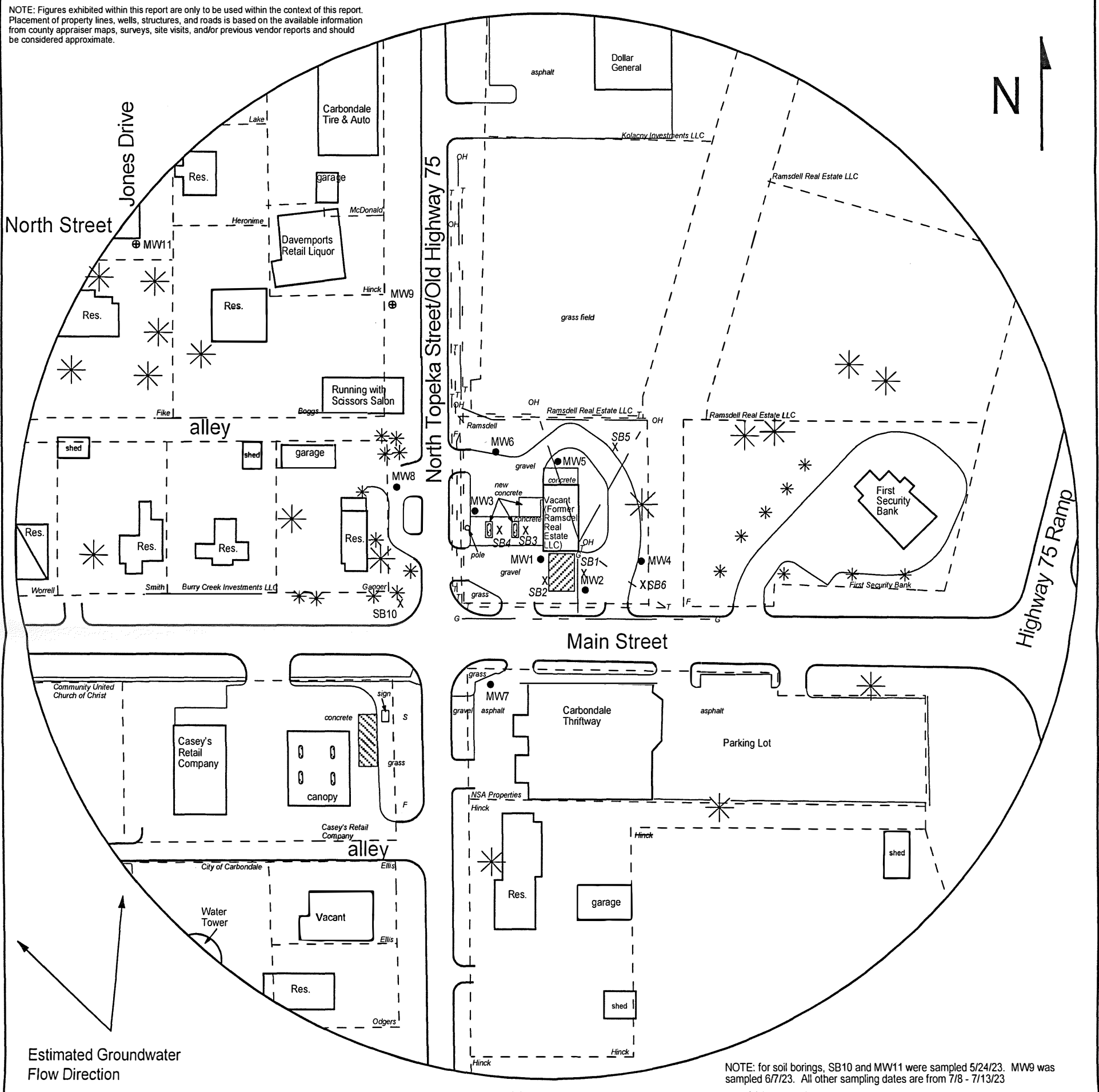

NOTE: for soil borings, SB10 and MW11 were sampled 5/24/23. MW9 was sampled 6/7/23. All other sampling dates are from 7/8 - 7/13/23

FIGURE 2.1 - 500 FT RADIUS AREA BASE MAP



1311 E 25th St., Suite B 785-841-8707 office
Lawrence, KS 66046 785-865-4282 fax

PROJECT:
Ramsdell Real Estate LLC
106 N. Topeka Ave.
Carbondale, KS
KDHE ID: U4-070-15276
Date: 6/8/23

0 100 ft

LEGEND

- Approximate Location of Former UST Basin Pump Islands
- Approximate Location of Active UST Basin Pump Islands
- Building with Basement
- Approximate Location of Property Line
- Existing Monitoring Well
- New Monitoring Well (Installed 5/24 and 6/7/23)
- Soil Boring (Drilled 7/8/21, 7/12-13/21, 5/24/23)
- Fire Hydrant
- Sewer Inlet
- Gas Lines (1.5 - 3 ft bgs)
- Overhead Lines (25'-40' high)
- Telephone Lines (2 - 6 ft bgs)

NOTE: SB5 & SB6 were drilled to collect hydrologic samples.
NOTE: Utility depths, heights and locations are approximate.