

1 LOCATION OF WATER WELL: Fraction NE 1/4 NE 1/4 Section Number 9 Township Number T 14 S Range Number 3 E W
 County: DICKINSON

Street/Rural Address of Well Location; if unknown, distance & direction from nearest town or intersection: If at owner's address, check here
3/8 South + 1/8 East
Global Positioning Systems (GPS) information:
 Latitude: N 38° 51' 25.6 (in decimal degrees)
 Longitude: W 097° 05' 69.8 (in decimal degrees)
 Elevation: 1191
 Horizontal Datum: WGS84, NAD83, NAD27
 Collection Method:

2 WATER WELL OWNER: MARLEE NOUSCHAFER
 RR#, St. Address, Box #: 1569 1800 AVE.
 City, State ZIP Code: ENTWISLE, MS 38744
 GPS unit (Make/Model: Garmin E-Trex 20)
 Digital Map/Photo, Topographic Map, Land Survey
 Est. Accuracy: < 3 m, 3-5 m, 5-15 m, > 15 m

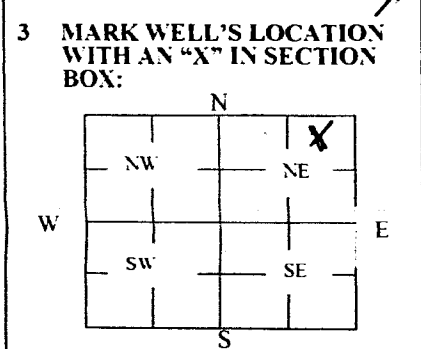

4 DEPTH OF WELL 119 ft.
WELL'S STATIC WATER LEVEL 40 ft.
WELL WAS USED AS:
 Domestic Public Water Supply Dewatering
 Irrigation Oil Field Water Supply Monitoring
 Feedlot Domestic (Lawn & Garden) Injection Well
 Industrial Air Conditioning Other LIVESTOCK
 Was a chemical/bacteriological sample submitted to Department? Yes No

5 TYPE OF BLANK CASING USED:
 Steel RMP (SR) Wrought Fiberglass Other (Specify below)
 PVC ABS Asbestos-Cement Concrete Tile
 Blank casing diameter 6" in. Was casing pulled? Yes No If yes, how much _____
 Casing height above or below land surface Cell OFF 3' Below Ground

6 GROUT PLUG MATERIAL: Neat cement Cement grout Bentonite Other _____
 Grout Plug Intervals: From 3 ft. to 40 ft., From _____ ft. to _____ ft., From _____ ft. to _____ ft.
 What is the nearest source of possible contamination:
 Septic tank Seepage pit Fuel storage Other (specify below)
 Sewer lines Pit privy Fertilizer storage
 Watertight sewer lines Sewage lagoon Insecticide storage
 Lateral lines Feedyard Abandoned water well
 Cess pool Livestock pens Oil well/Gas well
 Direction from well? Pond North
 How many feet? 50'

FROM	TO	PLUGGING MATERIALS	FROM	TO	PLUGGING MATERIALS
0	3	Compacted Clay			
3	40	Bentonite			
40	119	Chlorinated Lime Grout			

7 CONTRACTOR'S OR LANDOWNER'S CERTIFICATION: This water well was plugged under my jurisdiction and was completed on (mo/day/year) 11/6/2019 and this record is true to the best of my knowledge and belief. Kansas Water Well Contractor's License No. 451. This Water Well Record was completed on (mo/day/year) 11/8/2019 under the business name of Haldiman Well Drilling by (signature) Craig Haldiman

Send one white copy to Kansas Department of Health & Environment, Geology Section, 1000 SW Jackson Street, Ste. 420, Topeka, KS 66612-1367. Send one copy to WATER WELL OWNER and retain one for your records.
 Visit us at <http://www.kdheks.gov/waterwell/index.html> Telephone 785-296-5524.