

**WATER WELL PLUGGING RECORD Form WWC-5P** KSA 82a-1212 ID NO.

**1 LOCATION OF WATER WELL:** Fraction NW 1/4 SE 1/4 SE 1/4 1/4 Section Number 4 Township Number T 14 S Range Number 3  E  W  
 County: DICKINSON

Street/Rural Address of Well Location; if unknown, distance & direction from nearest town or intersection: If at owner's address, check here   
**Global Positioning Systems (GPS) information:**  
 Latitude: N 38° 51.607 (in decimal degrees)  
 Longitude: W 097° 05.831 (in decimal degrees)  
 Elevation: 1221  
 Horizontal Datum:  WGS84,  NAD83,  NAD27  
 Collection Method:

**2 WATER WELL OWNER:** MARY E. Neuschafar  
 RR#, St. Address, Box #: 1569 1800 AVE.  
 City, State ZIP Code: Emporia, KS 67441  
 GPS unit (Make/Model: Garmin E Teryx 20)  
 Digital Map/Photo.  Topographic Map.  Land Survey  
 Est. Accuracy:  < 3 m,  3-5 m,  5-15 m,  > 15 m

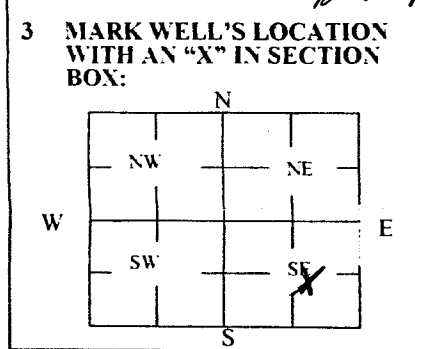

**4 DEPTH OF WELL** 57' ft. <sup>was</sup>  
 WELL'S STATIC WATER LEVEL was 56' ft.  
 WELL WAS USED AS:  
 Domestic  Public Water Supply  Dewatering  
 Irrigation  Oil Field Water Supply  Monitoring  
 Feedlot  Domestic (Lawn & Garden)  Injection Well  
 Industrial  Air Conditioning  Other NEVER USED & NO WATER  
 Was a chemical/bacteriological sample submitted to Department? Yes  No

**5 TYPE OF BLANK CASING USED:**  
 Steel  RMP (SR)  Wrought  Fiberglass  Other (Specify below)  
 PVC  ABS  Asbestos-Cement  Concrete Tile  
 Blank casing diameter was 6" in. Was casing pulled? Yes  No  If yes, how much \_\_\_\_\_  
 Casing height above or below land surface CUT OFF 3' BELOW SURFACE

**6 GROUT PLUG MATERIAL:**  Neat cement  Cement grout  Bentonite  Other \_\_\_\_\_  
 Grout Plug Intervals: From 3 ft. to 45 ft., From \_\_\_\_\_ ft. to \_\_\_\_\_ ft., From \_\_\_\_\_ ft. to \_\_\_\_\_ ft.  
 What is the nearest source of possible contamination:  
 Septic tank  Seepage pit  Fuel storage  Other (specify below) \_\_\_\_\_  
 Sewer lines  Pit privy  Fertilizer storage \_\_\_\_\_  
 Watertight sewer lines  Sewage lagoon  Insecticide storage \_\_\_\_\_  
 Lateral lines  Feedyard  Abandoned water well  Oil well/Gas well  
 Cess pool  Livestock pens  
 Direction from well? WEST  
 How many feet? 100'

FROM	TO	PLUGGING MATERIALS	FROM	TO	PLUGGING MATERIALS
0	3	COMPACTED CLAY			
3	45	BENTONITE			
45	57	CHLORINATED W/ GRAVEL			

**7 CONTRACTOR'S OR LANDOWNER'S CERTIFICATION:** This water well was plugged under my jurisdiction and was completed on (mo/day/year) 11/16/2019 and this record is true to the best of my knowledge and belief. Kansas Water Well Contractor's License No. 451. This Water Well Record was completed on (mo/day/year) 11/18/2019 under the business name of Halderman Well Drilling by (signature) [Signature]

Send one white copy to Kansas Department of Health & Environment, Geology Section, 1000 SW Jackson Street, Ste. 420, Topeka, KS 66612-1367. Send one copy to WATER WELL OWNER and retain one for your records.  
 Visit us at <http://www.kdheks.gov/waterwell/index.html> Telephone 785-296-5524.