

WATER WELL RECORD

Form WWC-5

Division of Water Resources App. No.

Well ID

MW7

Original Record Correction Change in Well Use

1 LOCATION OF WATER WELL: County Douglas Fraction NW 1/4 NE 1/4 NE 1/4 NE 1/4 Section Number 4 Township Number T 15 S Range Number R 20 E

2 WELL OWNER: Last Name: Business: KDHE (McMillian Oil) Address: 1000 SW Jackson City Topeka State: KS ZIP: 66612 Street or Rural Address where well is located (if unknown, distance and direction from nearest town or intersection): 719 Ames St., Baldwin, KS

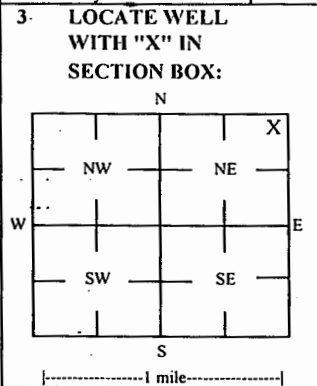

3 LOCATE WELL WITH 'X' IN SECTION BOX: 4 DEPTH OF COMPLETED WELL: 22.5 ft Depth(s) Groundwater Encountered: 1) 22.5 ft 2) 3) 4) Dry Well WELL'S STATIC WATER LEVEL: 11.37 ft

5 Latitude: 38.78177 (decimal degrees) Longitude: 95.18818 (decimal degrees) Horizontal Datum: X WGS 84 Source for Latitude/Longitude: X Land Survey

7 WELL WATER TO BE USED AS: 1 Domestic: Household, Lawn & Garden, Livestock, Irrigation, Feedlot, Industrial 5 Public Water Supply: well ID 6 Dewatering: how many wells? 7 Aquifer Recharge: well ID 8 Monitoring: well ID MW7 9 Environmental Remediation: well ID 10 Oil Field Water Supply: lease 11 Test Hole: well ID 12 Geothermal: How many bores?

Was a chemical/bacteriological sample submitted to KDHE? No Water well disinfected? No

8 TYPE OF CASING USED: Steel PVC Other CASING JOINTS: Glued Clamped Welded Threaded Casing diameter 2 in. to 12.5 ft Diameter in. to ft Casing height above land surface -0.28 in. Weight lbs./ft. Well thickness or gauge No

9 GROUT MATERIAL: Neat cement Cement grout Bentonite Other Concrete: 0-1' Grout intervals: From 1 ft. to 10.5 ft, From ft. to ft, From ft. to ft

Nearest source of possible contamination: Septic Tank Lateral Lines Pit Privy Livestock Pens Insecticide Storage Sewer Lines Cess Pool Sewage Lagoon Fuel Storage Abandoned Water Well Watertight Sewer Lines Seepage Pit Feedyard Fertilizer Storage Oil Well / Gas Well

Table with 6 columns: FROM, TO, LITHOLOGIC LOG, FROM, TO, LITHO. LOG (cont.) or PLUGGING INTERVALS. Rows show soil layers: Topsoil, gravel; Silt; Silty clay; Shale; Silty clay.

Notes: KDHE ID: McMillian Oil; A4-023-40177 Target of monitoring well is shallow groundwater, <20' of grout was installed at the direction of KDHE.

11 CONTRACTOR'S OR LANDOWNER'S CERTIFICATION: This water well was constructed, reconstructed, or plugged under my jurisdiction and was completed on (mo-day-year) 10/21/20 and this record is true to the best of my knowledge and belief.

NOTE: Figures exhibited within this report are only to be used within the context of this report. Placement of property lines, wells, structures, and roads is based on the available information from county appraiser maps, surveys, site visits, and/or previous vendor reports and should be considered approximate.

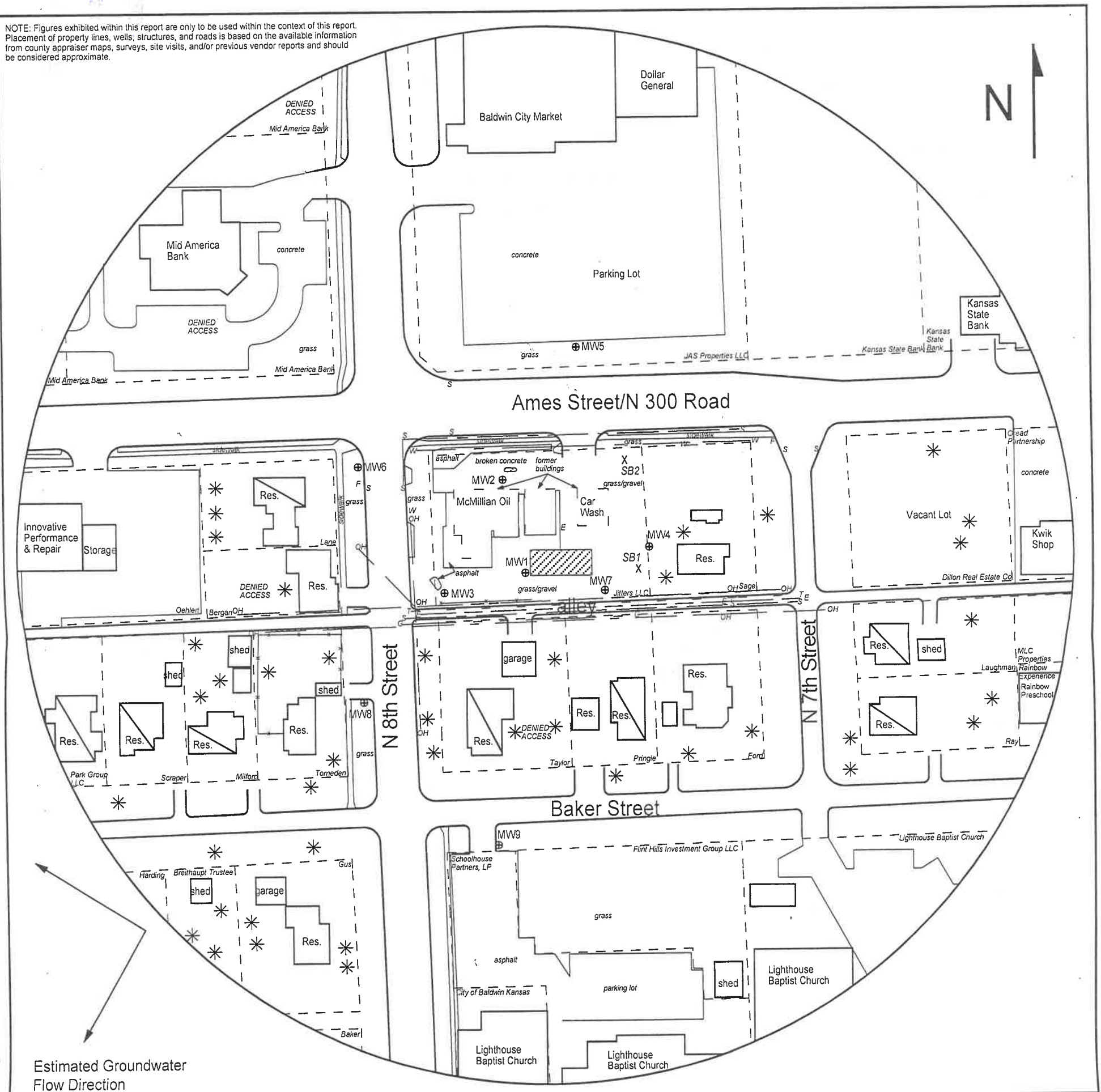

FIGURE 2.2 - 500 FT RADIUS AREA BASE MAP

**LEGEND**

- Approximate Location of Former AST Basins and Pump Island
- Building with Basement
- - - - - Approximate Location of Property Line
- ⊕ Monitoring Well (Installed 10/21-22/20)
- X Soil Boring (Drilled 10/22/20)
- F Fire Hydrant
- E - - - - - Electric Lines (1.5 - 3 ft bgs)
- OH - - - - - Overhead Lines (25'-40' high)
- S - - - - - Sewer Lines (2 - 6 ft bgs)
- T - - - - - Telephone Lines (2 - 6 ft bgs)
- W - - - - - Water Lines (2 - 6 ft bgs)

NOTE: SB1 & SB2 were drilled to collect hydrologic samples.  
NOTE: Utility depths, heights and locations are approximate.



1311 E 25th St., Suite B 785-841-8707 office  
Lawrence, KS 66046 785-865-4282 fax

**PROJECT:**

McMillian Oil  
719 Ames St.  
Baldwin, KS  
KDHE ID: A4-023-40177  
Date: 10/23/20



RECEIVED  
JAN 22 2021  
BUREAU OF WATER

# DENNIS L HANDKE

1820 NW 59th Terrace  
TOPEKA, KANSAS 66618  
785-286-4047 Home

Jess Chapman  
Larsen & Associates  
1311 E. 25<sup>th</sup> Street, Suite B  
Lawrence, Kansas, 66046

November 13, 2020

RE: Monitor Well Elevation Survey  
719 Ames St., Baldwin, Kansas

Proj. 20-00ZZ  
McMillian Oil  
A4-023-40177

Bench Mark: Rivet and washer on North center of concrete storm inlet near Northwest corner of property.  
Elev: 1049.92      North 5303.13      West 616.87      (from SE Cor. Sec. 4-15-20E)

|      |          |         |       |         |   |
|------|----------|---------|-------|---------|---|
| MW-1 | rim      | 1052.75 | North | 5173.80 | NW1/4,NE1/4,NE1/4,NE1/4                 |
|      | top pipe | 1052.40 | West  | 546.61  | Lat= 38.78181 Long = 95.18842           |
| MW-2 | rim      | 1051.88 | North | 5259.91 | NW1/4,NE1/4,NE1/4,NE1/4                 |
|      | top pipe | 1051.49 | West  | 563.06  | Lat= 38.78205 Long = 95.18848           |
| MW-3 | rim      | 1049.75 | North | 5158.45 | NW1/4,NE1/4,NE1/4,NE1/4                 |
|      | top pipe | 1049.39 | West  | 625.40  | Lat= 38.78177 Long = 95.18870           |
| MW-4 | rim      | 1056.47 | North | 5193.94 | NW1/4,NE1/4,NE1/4,NE1/4                 |
|      | top pipe | 1056.11 | West  | 432.85  | Lat= 38.78187 Long = 95.18803           |
| MW-5 | rim      | 1050.25 | North | 5387.22 | SW1/4,SE1/4,SE1/4,SE1/4 (Sec 33-14-20E) |
|      | top pipe | 1049.70 | West  | 494.15  | Lat= 38.78240 Long = 95.18825           |
| MW-6 | rim      | 1046.71 | North | 5276.23 | NE1/4,NW1/4,NE1/4,NE1/4                 |
|      | top pipe | 1046.30 | West  | 704.44  | Lat= 38.78209 Long = 95.18898           |
| MW-7 | rim      | 1055.70 | North | 5158.23 | NW1/4,NE1/4,NE1/4,NE1/4                 |
|      | top pipe | 1055.42 | West  | 478.22  | Lat= 38.78177 Long = 95.18818           |
| MW-8 | rim      | 1050.05 | North | 5055.12 | NE1/4,NW1/4,NE1/4,NE1/4                 |
|      | top pipe | 1049.69 | West  | 708.64  | Lat= 38.78148 Long = 95.18899           |
| MW-9 | rim      | 1056.60 | North | 4914.27 | SW1/4,NE1/4,NE1/4,NE1/4                 |
|      | top pipe | 1056.30 | West  | 579.12  | Lat= 38.78110 Long = 95.18853           |

Lat & Long derived from Baldwin City 7.5 quad map. WGS84.

Elevation established from USGS BM G 44 NAVD 88

If you have any questions, please feel free to call me. Thank you for the opportunity to be

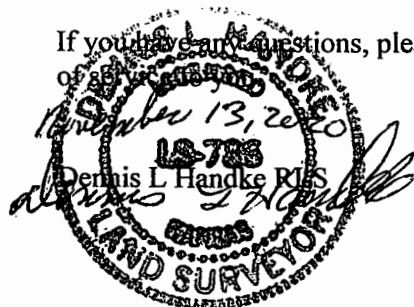

RECEIVED

JAN 22 2021

BUREAU OF WATER