

WATER WELL RECORD

Form WWC-5

Division of Water Resources App. No.

Well ID

MW8

[X] Original Record [] Correction [] Change in Well Ust

1 LOCATION OF WATER WELL: County Douglas, Fraction NE 1/4 NW 1/4 NE 1/4 NE 1/4, Section Number 4, Township Number T 15 S, Range Number R 20 E W. 2 WELL OWNER: Last Name: KDHE (McMillian Oil), Business: KDHE (McMillian Oil), Address: 1000 SW Jackson, City: Topeka, State: KS, ZIP: 66612, Street or Rural Address where well is located: 804 Baker St., Baldwin, KS. 3 LOCATE WELL WITH "X" IN SECTION BOX: [Diagram showing section box with 'X' in NE corner]. 4 DEPTH OF COMPLETED WELL: 20 ft, Depth(s) Groundwater Encountered: 1) 20 ft, 2) 7.93 ft, 3) Dry Well, WELL'S STATIC WATER LEVEL: 7.93 ft, [X] below land surface, measured on (mo-day-yr) 10/23/20. 5 Latitude: 38.78148, Longitude: 95.18899, Horizontal Datum: [X] WGS 84, Source for Latitude/Longitude: [X] GPS, [X] Land Survey. 6 Elevation: 1049.69 ft, Source: [X] Land Survey, [X] TOC.

7 WELL WATER TO BE USED AS: 1 Domestic: [] Household, [] Lawn & Garden, [] Livestock, [] Irrigation, [] Feedlot, [] Industrial. 2 Public Water Supply: well ID. 3 Dewatering: how many wells? 4 Aquifer Recharge: well ID. 5 Monitoring: well ID MW8. 6 Environmental Remediation: well ID. 7 Air Sparge, 8 Soil Vapor Extractor, 9 Recovery, 10 Injection. 10 Oil Field Water Supply: lease. 11 Test Hole: well ID. 12 Geothermal: How many bores? a) Closed Loop, b) Open Loop, [] Surface Discharge, [] Inj. of Water, [] Other (specify):

Was a chemical/bacteriological sample submitted to KDHE? [] Yes [X] No. If yes, date sample was submitted: Water well disinfected? [] Yes [X] No.

8 TYPE OF CASING USED: [] Steel [X] PVC [] Other, CASING JOINTS: [] Glued [] Clamped [] Welded [X] Threaded. Casing diameter 2 in. to 10 ft, Diameter in. to ft, Diameter in. to ft, Casing height above land surface -0.36 in. Weight lbs./ft. Well thickness or gauge No. TYPE OF SCREEN OR PERFORATION MATERIAL: [] Steel [] Stainless Steel [] Fiberglass [X] PVC [] Brass [] Galvanized Steel [] Concrete tile [] None used (open hole) [] Other (Specify). SCREEN OR PERFORATION OPENINGS ARE: [] Continuous Slot [X] Mill Slot [] Gauze Wrapped [] Torch Cut [] Drilled Holes [] Other (Specify) [] Louvered Shutter [] Key Punched [] Wire Wrapped [] Saw Cut [] None (Open Hole). SCREEN-PERFORATED INTERVALS: From 10 ft. to 20 ft, From ft. to ft, From ft. to ft. GRAVEL PACK INTERVALS: From 8 ft. to 20 ft, From ft. to ft, From ft. to ft.

9 GROUT MATERIAL: [] Neat cement [] Cement grout [X] Bentonite [X] Other Concrete: 0-1'. Grout intervals: From 1 ft. to 8 ft, From ft. to ft, From ft. to ft.

Nearest source of possible contamination: [] Septic Tank [] Lateral Lines [] Pit Privy [] Livestock Pens [] Insecticide Storage [] Sewer Lines [] Cess Pool [] Sewage Lagoon [X] Fuel Storage [] Abandoned Water Well [] Watertight Sewer Lines [] Seepage Pit [] Feedyard [] Fertilizer Storage [] Oil Well / Gas Well [] Other (Specify). Direction from well? NE Distance from well? ~200' ft

Table with 6 columns: 10 FROM, TO, LITHOLOGIC LOG, FROM, TO, LITHO. LOG (cont.) or PLUGGING INTERVALS. Rows: 0-2 Topsoil, silt, gravel chunks; 2-9 Clay; 9-20 Silty clay.

Notes: KDHE ID: McMillian Oil; A4-023-40177. Target of monitoring well is shallow groundwater, <20' of grout was installed at the direction of KDHE.

11 CONTRACTOR'S OR LANDOWNER'S CERTIFICATION: This water well was [X] constructed, [] reconstructed, or [] plugged under my jurisdiction and was completed on (mo-day-year) 10/21/20 and this record is true to the best of my knowledge and belief. License No 757 This Water Well Record was completed on (mo-day-year) 11/17/20 under the business name of Larsen & Associates, Inc. Signature

NOTE: Figures exhibited within this report are only to be used within the context of this report. Placement of property lines, wells, structures, and roads is based on the available information from county appraiser maps, surveys, site visits, and/or previous vendor reports and should be considered approximate.

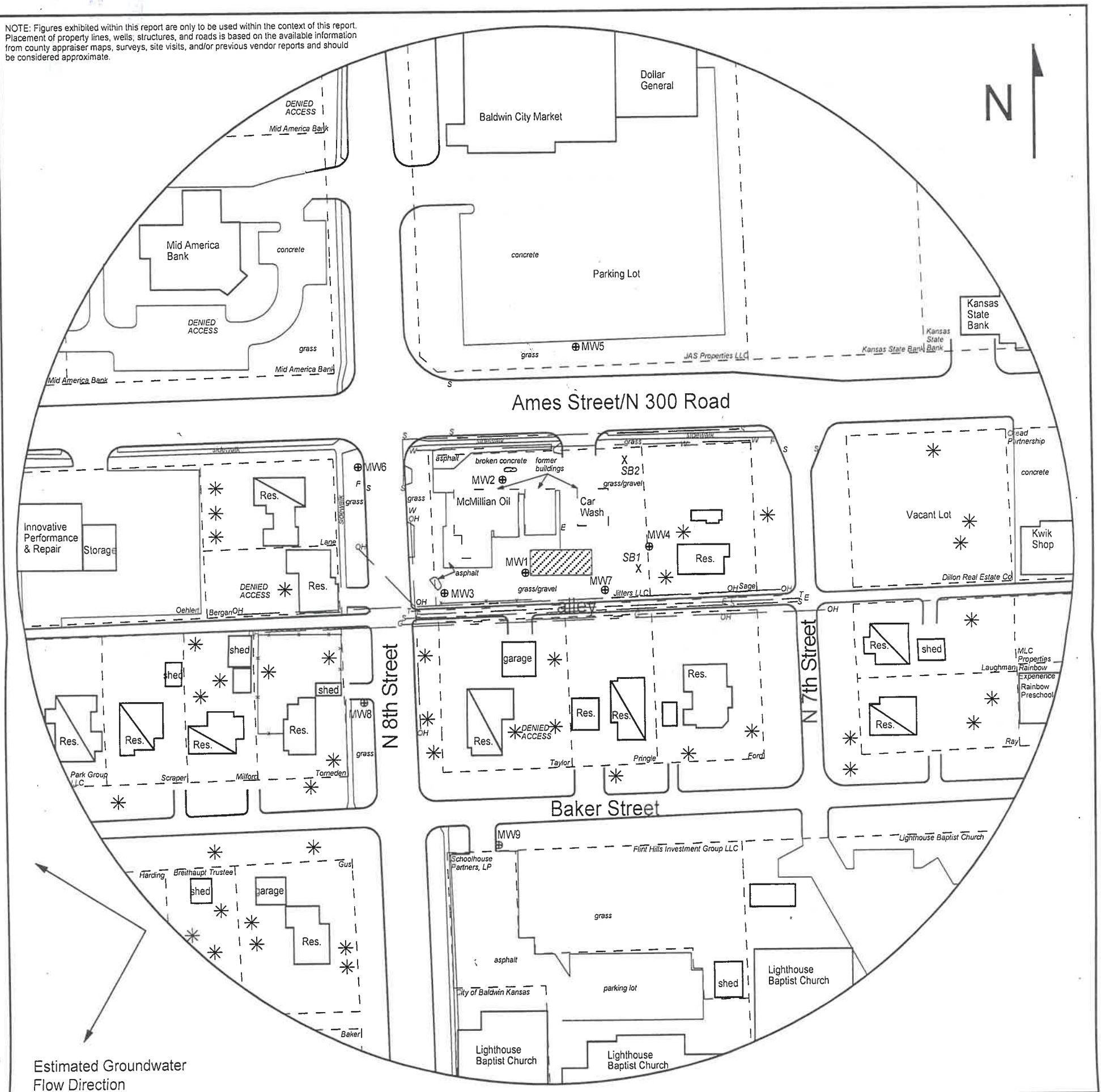

FIGURE 2.2 - 500 FT RADIUS AREA BASE MAP

LEGEND

- Approximate Location of Former AST Basins and Pump Island
- Building with Basement
- - - - - Approximate Location of Property Line
- ⊕ Monitoring Well (Installed 10/21-22/20)
- X Soil Boring (Drilled 10/22/20)
- F Fire Hydrant
- E - - - - - Electric Lines (1.5 - 3 ft bgs)
- OH - - - - - Overhead Lines (25'-40' high)
- S - - - - - Sewer Lines (2 - 6 ft bgs)
- T - - - - - Telephone Lines (2 - 6 ft bgs)
- W - - - - - Water Lines (2 - 6 ft bgs)

NOTE: SB1 & SB2 were drilled to collect hydrologic samples.
NOTE: Utility depths, heights and locations are approximate.



1311 E 25th St., Suite B 785-841-8707 office
Lawrence, KS 66046 785-865-4282 fax

PROJECT:

McMillian Oil
719 Ames St.
Baldwin, KS
KDHE ID: A4-023-40177
Date: 10/23/20

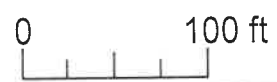

RECEIVED
JAN 22 2021
BUREAU OF WATER

DENNIS L HANDKE

1820 NW 59th Terrace
TOPEKA, KANSAS 66618
785-286-4047 Home

Jess Chapman
Larsen & Associates
1311 E. 25th Street, Suite B
Lawrence, Kansas, 66046

November 13, 2020

RE: Monitor Well Elevation Survey
719 Ames St., Baldwin, Kansas

Proj. 20-00ZZ
McMillian Oil
A4-023-40177

Bench Mark: Rivet and washer on North center of concrete storm inlet near Northwest corner of property.
Elev: 1049.92 North 5303.13 West 616.87 (from SE Cor. Sec. 4-15-20E)

MW-1	rim	1052.75	North	5173.80	NW1/4,NE1/4,NE1/4,NE1/4
	top pipe	1052.40	West	546.61	Lat= 38.78181 Long = 95.18842
MW-2	rim	1051.88	North	5259.91	NW1/4,NE1/4,NE1/4,NE1/4
	top pipe	1051.49	West	563.06	Lat= 38.78205 Long = 95.18848
MW-3	rim	1049.75	North	5158.45	NW1/4,NE1/4,NE1/4,NE1/4
	top pipe	1049.39	West	625.40	Lat= 38.78177 Long = 95.18870
MW-4	rim	1056.47	North	5193.94	NW1/4,NE1/4,NE1/4,NE1/4
	top pipe	1056.11	West	432.85	Lat= 38.78187 Long = 95.18803
MW-5	rim	1050.25	North	5387.22	SW1/4,SE1/4,SE1/4,SE1/4 (Sec 33-14-20E)
	top pipe	1049.70	West	494.15	Lat= 38.78240 Long = 95.18825
MW-6	rim	1046.71	North	5276.23	NE1/4,NW1/4,NE1/4,NE1/4
	top pipe	1046.30	West	704.44	Lat= 38.78209 Long = 95.18898
MW-7	rim	1055.70	North	5158.23	NW1/4,NE1/4,NE1/4,NE1/4
	top pipe	1055.42	West	478.22	Lat= 38.78177 Long = 95.18818
MW-8	rim	1050.05	North	5055.12	NE1/4,NW1/4,NE1/4,NE1/4
	top pipe	1049.69	West	708.64	Lat= 38.78148 Long = 95.18899
MW-9	rim	1056.60	North	4914.27	SW1/4,NE1/4,NE1/4,NE1/4
	top pipe	1056.30	West	579.12	Lat= 38.78110 Long = 95.18853

Lat & Long derived from Baldwin City 7.5 quad map. WGS84.

Elevation established from USGS BM G 44 NAVD 88

If you have any questions, please feel free to call me. Thank you for the opportunity to be

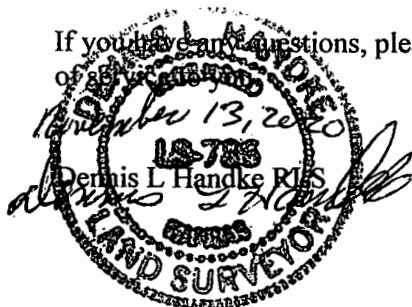

RECEIVED

JAN 22 2021

BUREAU OF WATER