

WATER WELL RECORD

Form WWC-5

Division of Water Resources App. No.

1 LOCATION OF WATER WELL: County: MIAMI	Fraction SW 1/4 ND 1/4 SW 1/4 NW 1/4	Section Number 31	Township No. T 15 S	Range Number R 23 E <input checked="" type="checkbox"/> W
---	---	----------------------	------------------------	--

Street/Rural Address of Well Location; if unknown, distance & direction from nearest town or intersection: If at owner's address, check here .
23367 SOUTH MOONLIGHT ROAD, SPRING HILL, KS 66083

Global Positioning System (GPS) information:
Latitude: 38.704369 (in decimal degrees)
Longitude: -94.907957 (in decimal degrees)
Elevation:
Datum: WGS 84, NAD 83, NAD 27
Collection Method:
 GPS unit (Make/Model:)
 Digital Map/Photo, Topographic Map, Land Survey
Est. Accuracy: <3 m, 3-5 m, 5-15 m, >15 m

2 WATER WELL OWNER: MIKE BROCK
RR#, Street Address, Box #: 2163 W. FOREST DRIVE
City, State, ZIP Code : OLATHE, KANSAS 66061

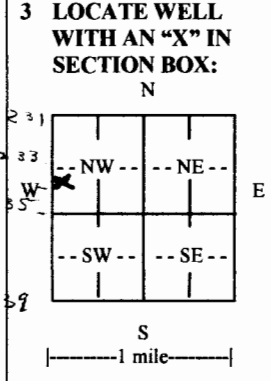

4 DEPTH OF COMPLETED WELL ... 200 ft. 7-200' BORES
Depth(s) Groundwater Encountered (1). 0 ft. (2)..... ft. (3)..... ft.
WELL'S STATIC WATER LEVEL.....ft. below land surface measured on mo/day/yr.....
Pump test data: Well water was.....ft. after..... hours pumping..... gpm
EST. YIELD. 0gpm. Well water was.....ft. after..... hours pumping..... gpm
Bore Hole Diameter 5 5/8in. to 200ft., andin. toft.
WELL WATER TO BE USED AS: Public water supply Geothermal Injection well
 Domestic Feedlot Oil field water supply Dewatering Other (Specify below)
 Irrigation Industrial Domestic-lawn & garden Monitoring well CLOSED LOOP
Was a chemical/bacteriological sample submitted to Department? Yes No
If yes, mo/day/yr sample was submitted.....
Water well disinfected? Yes No

5 TYPE OF CASING USED: Steel PVC Other H.D. POLYETHYLENE.....
CASING JOINTS: Glued Clamped Welded Threaded FUSION
Casing diameter 3/4 in. to 200 ft., Diameter in. to ft., Diameter in. to ft.
Casing height above land surface 36 in., Weight SDR11lbs./ft., Wall thickness or gauge No. 160 PSI
TYPE OF SCREEN OR PERFORATION MATERIAL: NONE
 Steel Stainless Steel PVC Other (Specify)
 Brass Galvanized Steel None used (open hole)
SCREEN OR PERFORATION OPENINGS ARE: NONE
 Continuous slot Mill slot Gauze wrapped Torch cut Drilled holes None (open hole)
 Louvered shutter Key punched Wire wrapped Saw cut Other (specify)
SCREEN-PERFORATED INTERVALS: From..... ft. to ft., From ft. to ft.
GRAVEL PACK INTERVALS: From..... ft. to ft., From ft. to ft.
From..... ft. to ft., From ft. to ft.

6 GROUT MATERIAL: Neat cement Cement grout Bentonite Other
Grout Intervals: From 200 ft. to 3 ft., From ft. to ft., From ft. to ft.
What is the nearest source of possible contamination:
 Septic tank Lateral lines Pit privy Livestock pens Insecticide storage Other (specify below)
 Sewer lines Cesspool Sewage lagoon Fuel storage Abandoned water well
 Watertight sewer lines Seepage pit Feedyard Fertilizer storage Oil well/gas well
Direction from well Distance from well

FROM	TO	LITHOLOGIC LOG	FROM	TO	LITHO. LOG (cont.) or PLUGGING INTERVALS
0	6	SOIL/CLAY			
6	11	LIME			
11	15	SHALE			
15	35	LIME	200	3	7-200' BORES PLUGGED WITH
35	58	SHALE			HIGH SOLID BENTONITE
58	76	LIME			
76	166	SHALE			
166	188	LIME			
188	200	SHALE			

7 CONTRACTOR'S OR LANDOWNER'S CERTIFICATION: This water well was constructed, reconstructed, or plugged under my jurisdiction and was completed on (mo/day/year) 05/28/2015.... and this record is true to the best of my knowledge and belief.
Kansas Water Well Contractor's License No. 561..... This Water Well Record was completed on (mo/day/year) 06/02/2015.....
under the business name of EVANS ENERGY DEVELOPMENT, INC. by (signature) *[Signature]*

INSTRUCTIONS: Use typewriter or ball point pen. PLEASE PRESS FIRMLY and PRINT clearly. Please fill in blanks and check the correct answers. Send one copy to Kansas Department of Health and Environment, Bureau of Water, Geology Section, 1000 SW Jackson St., Suite 420, Topeka, Kansas 66612-1367. Telephone 785-296-5524. Send one copy to WATER WELL OWNER and retain one for your records. Include fee of \$5.00 for each constructed well. Visit us at <http://www.kdheks.gov/waterwell/index.html>