

CORRECTION(S) TO WATER WELL RECORD (WWC-5)
(to rectify lacking or incorrect information)

County: Lyon

Location listed as:

Section-Township-Range: 7-15/16-? W

Fraction (1/4 1/4 1/4): NW NE NW

Location changed to:

7-16-13E

NW NE NW

Other changes: Initial statements: _____

Changed to: _____

Comments: _____

verification method: With the address, used Google Maps and the KGS interactive mapping system to find the correct S-T-R.

initials: PT date: 1/4/11

submitted by: Kansas Geological Survey, Data Resources Library, 1930 Constant Ave., Lawrence, KS 66047-3726
to: Kansas Dept of Health & Environment, Bureau of Water, 1000 SW Jackson, Suite 420, Topeka, KS 66612-1367.

1 LOCATION OF WATER WELL: Fraction 1/4 NW 1/4 NE 1/4 NW 1/4 Section Number 7 Township Number T 15-16S Range Number E W
 County: Lyon

Street/Rural Address of Well Location; if unknown, distance & direction from nearest town or intersection: If at owner's address, check here

Global Positioning Systems (GPS) information:
 Latitude: _____ (in decimal degrees)
 Longitude: _____ (in decimal degrees)
 Elevation: _____
 Datum: WGS84, NAD83, NAD27
 Collection Method:
 GPS unit (Make/Model: _____)
 Digital Map/Photo, Topographic Map, Land Survey
 Est. Accuracy: < 3 m, 3-5 m, 5-15 m, > 15 m

2 WATER WELL OWNER: JASON GIBSON
 RR#, St. Address, Box #: 1923 Rd 360
 City, State ZIP Code: Reading, KS 66868

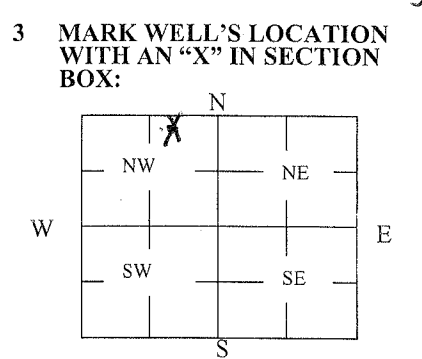

4 DEPTH OF WELL 27 ft.
 WELL'S STATIC WATER LEVEL 9 ft.
 WELL WAS USED AS:
 Domestic Public Water Supply Dewatering
 Irrigation Oil Field Water Supply Monitoring
 Feedlot Domestic (Lawn & Garden) Injection Well
 Industrial Air Conditioning Other _____
 Was a chemical/bacteriological sample submitted to Department? Yes No

5 TYPE OF BLANK CASING USED:
 Steel RMP (SR) Wrought Fiberglass Other (Specify below)
 PVC ABS Asbestos-Cement Concrete Tile Rock
 Blank casing diameter 54 in. Was casing pulled? Yes No If yes, how much _____
 Casing height above or below land surface _____ in.

6 GROUT PLUG MATERIAL: Neat cement Cement grout Bentonite Other _____
 Grout Plug Intervals: From 0.5 ft. to 1 ft., From 1 ft. to 1.5 ft., From 1.5 to 2.0 ft.
 What is the nearest source of possible contamination:
 Septic tank Seepage pit Fuel Storage Other (specify below)
 Sewer lines Pit privy Fertilizer storage
 Watertight sewer lines Sewage lagoon Insecticide storage
 Lateral lines Feedyard Abandoned water well Direction from well? _____
 Cess pool Livestock pens Oil well/Gas well How many feet? _____

FROM	TO	PLUGGING MATERIALS	FROM	TO	PLUGGING MATERIALS
0	9'	Sand			
0	9'	Chlorine			
9'	23'	Subsoil (Ballast)			
23'	25'	Bentonite			
25'	27'	Top soil			

7 CONTRACTOR'S OR LANDOWNER'S CERTIFICATION: This water well was plugged under my jurisdiction and was completed on (mo/day/year) 11-17-10 and this record is true to the best of my knowledge and belief. Kansas Water Well Contractor's License No. _____ This Water Well Record was completed on (mo/day/year) 11-17-10 under the business name of LJM Construction by (signature) [Signature]

INSTRUCTIONS: Use typewriter or ballpoint pen. Please press firmly and print clearly. Please fill in blanks, underline or circle the correct answers. Send top three copies to Kansas Department of Health and Environment, Bureau of Water, Geology Section, 1000 SW Jackson St., Ste. 420, Topeka, Kansas 66612-1367. Telephone: 785/296-5524. Send one to Water Well Owner and retain one for your records. Visit us at <http://www.kdheks.gov/waterwell/index.html>.

Check one: White Copy Blue Copy Pink Copy