

PZ-111

WATER WELL PLUGGING RECORD Form WWC-5P KSA 82a-1212 ID NO.

1 LOCATION OF WATER WELL: County: Franklin Fraction 1/4 NW 1/4 NW 1/4 SW 1/4 Section Number 31 Township Number T 16 S Range Number 19 E W

Street/Rural Address of Well Location: if unknown, distance & direction from nearest town or intersection: If at owner's address, check here [] Approximately 0.5 miles N of Indiana Road and Highway 68 and 400' E Global Positioning Systems (GPS) information: Latitude: 38.61559 Longitude: 95.35870

2 WATER WELL OWNER: BNSF Railway RR#, St. Address, Box #: 4519 Kansas Ave. City, State ZIP Code: KC, KS 66106

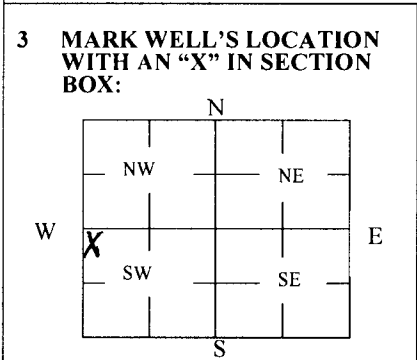

4 DEPTH OF WELL 12 ft. WELL'S STATIC WATER LEVEL _____ ft. WELL WAS USED AS: [] Domestic [] Irrigation [] Feedlot [] Industrial [] Public Water Supply [] Oil Field Water Supply [] Domestic (Lawn & Garden) [] Air Conditioning [] Dewatering [] Monitoring [] Injection Well [] Other

5 TYPE OF BLANK CASING USED: [] Steel [] RMP (SR) [] Wrought [] Fiberglass [] Other (Specify below) [x] PVC [] ABS [] Asbestos-Cement [] Concrete Tile Blank casing diameter 1 in. Was casing pulled? Yes [x] No [] If yes, how much all Casing height above or below land surface 39 in.

6 GROUT PLUG MATERIAL: [] Neat cement [x] Cement grout [] Bentonite [] Other Grout Plug Intervals: From 3 ft. to 12 ft., From - ft. to - ft., From - ft. to - ft. What is the nearest source of possible contamination: [] Septic tank [] Sewer lines [] Watertight sewer lines [] Lateral lines [] Cess pool [] Seepage pit [] Pit privy [] Sewage lagoon [] Feedyard [] Livestock pens [] Fuel storage [] Fertilizer storage [] Insecticide storage [] Abandoned water well [] Oil well/Gas well [x] Other (specify below) derailment/leaking RR car Direction from well? W How many feet? 125'

Table with 6 columns: FROM, TO, PLUGGING MATERIALS, FROM, TO, PLUGGING MATERIALS. Row 1: 0, 3, Top Soil. Row 2: 3, 12, Bentonite Grout.

7 CONTRACTOR'S OR LANDOWNER'S CERTIFICATION: This water well was plugged under my jurisdiction and was completed on (mo/day/year) 4-6-15 and this record is true to the best of my knowledge and belief. Kansas Water Well Contractor's License No. 710. This Water Well Record was completed on (mo/day/year) 4-20-15 under the business name of Below Ground Surface, Inc. by (signature)

Send one white copy to Kansas Department of Health & Environment, Geology Section, 1000 SW Jackson Street, Ste. 420, Topeka, KS 66612-1367. Send one copy to WATER WELL OWNER and retain one for your records. Visit us at http://www.kdheks.gov/waterwell/index.html Telephone 785-296-5524.

961 1/4 NW
OTTAWA NW

UNITED STATES
DEPARTMENT OF THE INTERIOR
GEOLOGICAL SURVEY

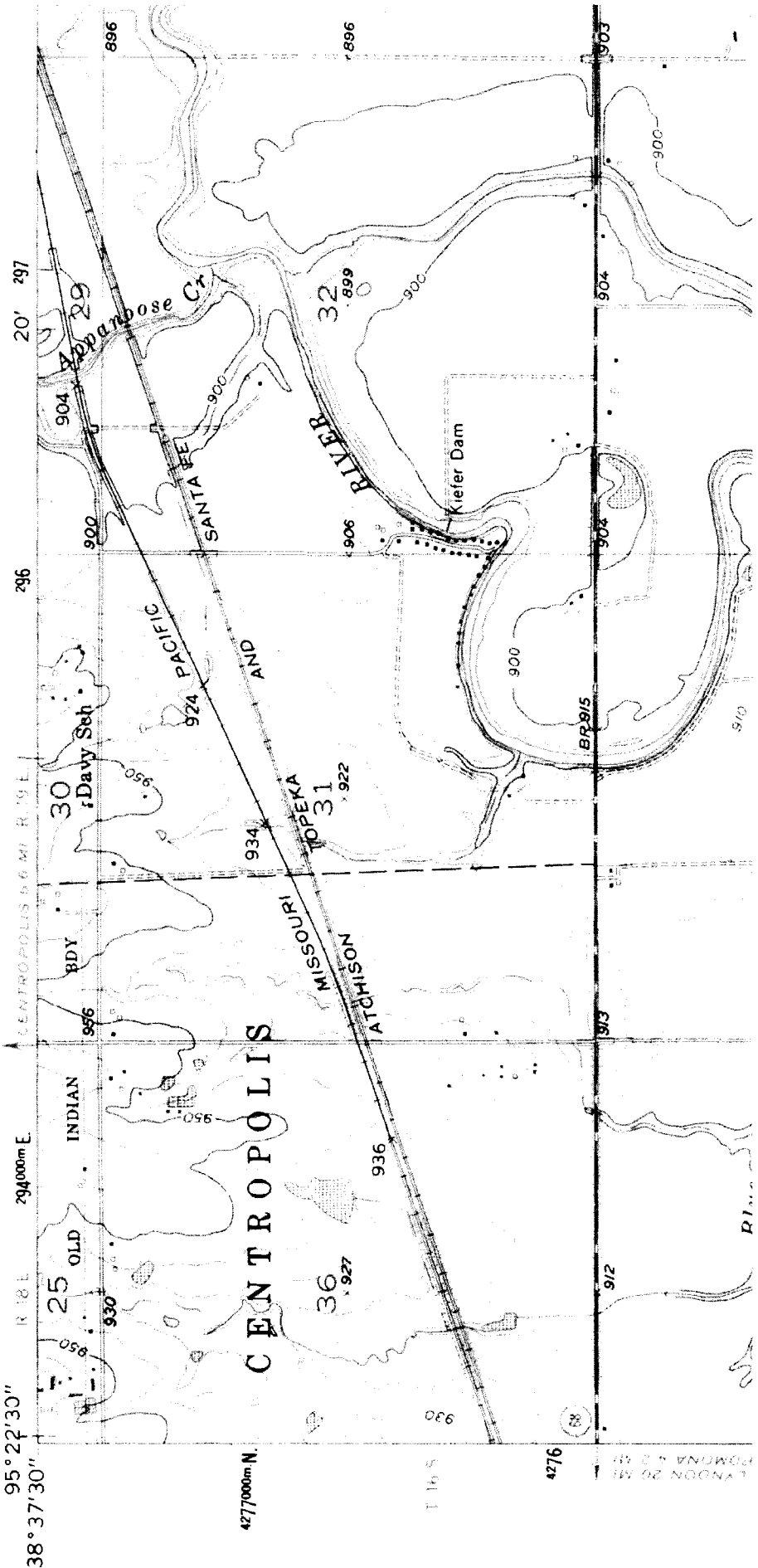

95° 22' 30"
38° 37' 30"

29,400m E

CENTROPOLIS 5.6 MI. R. 19 E

20' 297

4277000m N.

930

4276

LYNON 20 MI
POMONA 20 MI