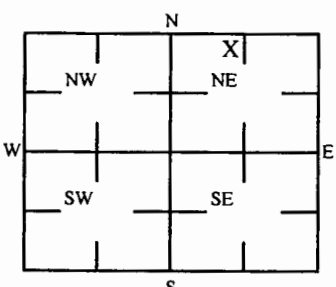

1 LOCATION OF WATER WELL: County: Franklin	Fraction NE ¼ NE ¼ NW ¼ NE ¼	Section Number 31	Township Number T 16 S	Range Number 20 <input checked="" type="checkbox"/> E <input type="checkbox"/> W
--	---------------------------------	----------------------	---------------------------	---

Street/Rural Address of Well Location; if unknown, distance & direction from nearest town or intersection: If at owner's address, check here <input type="checkbox"/> 2518 E. Logan, Ottawa, KS	Global Positioning Systems (GPS) information: Latitude: <u>38.62247</u> (in decimal degrees) Longitude: <u>95.23521</u> (in decimal degrees) Elevation: <u>NA</u> Horizontal Datum <input checked="" type="checkbox"/> WGS84, <input type="checkbox"/> NAD83, <input type="checkbox"/> NAD27 Collection Method: <input type="checkbox"/> GPS unit (Make/model: _____) <input type="checkbox"/> Digital Map/Photo, <input type="checkbox"/> Topographic Map <input type="checkbox"/> Land Survey Est. Accuracy: <input type="checkbox"/> <3 m, <input type="checkbox"/> 3-5 m, <input type="checkbox"/> 5-15 m, <input type="checkbox"/> >15 m
--	--

2 WATER WELL OWNER: S.M. Trading Corporation RR#, St. Address, Box #: 16504 Goddard City, State ZIP Code: Overland Park, KS 66221	
--	--

3 MARK WELL'S LOCATION WITH AN "X" IN SECTION BOX: 	4 DEPTH OF WELL <u>19.68</u> ft. WELL'S STATIC WATER LEVEL <u>NA</u> ft WELL WAS USED AS: <table style="width: 100%;"> <tr> <td><input type="checkbox"/> Domestic</td> <td><input type="checkbox"/> Public Water Supply</td> <td><input type="checkbox"/> Dewatering</td> </tr> <tr> <td><input type="checkbox"/> Irrigation</td> <td><input type="checkbox"/> Oil Field Water Supply</td> <td><input checked="" type="checkbox"/> Monitoring</td> </tr> <tr> <td><input type="checkbox"/> Feedlot</td> <td><input type="checkbox"/> Domestic (Lawn & Garden)</td> <td><input type="checkbox"/> Injection Well</td> </tr> <tr> <td><input type="checkbox"/> Industrial</td> <td><input type="checkbox"/> Air Conditioning</td> <td><input type="checkbox"/> Other _____</td> </tr> </table> Was a chemical/bacteriological sample submitted to Department? Yes <input type="checkbox"/> No <input checked="" type="checkbox"/>	<input type="checkbox"/> Domestic	<input type="checkbox"/> Public Water Supply	<input type="checkbox"/> Dewatering	<input type="checkbox"/> Irrigation	<input type="checkbox"/> Oil Field Water Supply	<input checked="" type="checkbox"/> Monitoring	<input type="checkbox"/> Feedlot	<input type="checkbox"/> Domestic (Lawn & Garden)	<input type="checkbox"/> Injection Well	<input type="checkbox"/> Industrial	<input type="checkbox"/> Air Conditioning	<input type="checkbox"/> Other _____
<input type="checkbox"/> Domestic	<input type="checkbox"/> Public Water Supply	<input type="checkbox"/> Dewatering											
<input type="checkbox"/> Irrigation	<input type="checkbox"/> Oil Field Water Supply	<input checked="" type="checkbox"/> Monitoring											
<input type="checkbox"/> Feedlot	<input type="checkbox"/> Domestic (Lawn & Garden)	<input type="checkbox"/> Injection Well											
<input type="checkbox"/> Industrial	<input type="checkbox"/> Air Conditioning	<input type="checkbox"/> Other _____											

5 TYPE OF BLANK CASING USED:	<input type="checkbox"/> Steel <input type="checkbox"/> RMP (SR) <input type="checkbox"/> Wrought <input type="checkbox"/> Fiberglass <input type="checkbox"/> Other (Specific below) <input checked="" type="checkbox"/> PVC <input type="checkbox"/> ABS <input type="checkbox"/> Asbestos-Cement <input type="checkbox"/> Concrete Tile _____
Blank casing diameter <u>2</u> in.	Was casing pulled? Yes <input checked="" type="checkbox"/> No <input type="checkbox"/> If yes, how much <u>3'</u>
Casing height above or below land surface <u>NA</u> in.	

6 GROUT PLUG MATERIAL:	<input type="checkbox"/> Neat cement <input type="checkbox"/> Cement grout <input checked="" type="checkbox"/> Bentonite <input checked="" type="checkbox"/> Other <u>0-3' Topsoil</u>
Grout Plug Intervals: From <u>3</u> ft to <u>19.68</u> ft, From _____ ft to _____ ft, From _____ ft to _____ ft,	
What is the nearest source of possible contamination:	
<input type="checkbox"/> Septic tank <input type="checkbox"/> Seepage pit <input type="checkbox"/> Fuel storage <input type="checkbox"/> Other (specify below) _____ <input type="checkbox"/> Sewer lines <input type="checkbox"/> Pit privy <input type="checkbox"/> Fertilizer storage _____ <input type="checkbox"/> Watertight sewer lines <input type="checkbox"/> Sewage lagoon <input type="checkbox"/> Insecticide storage _____ <input type="checkbox"/> Lateral lines <input type="checkbox"/> Feed yard <input type="checkbox"/> Abandoned water well _____ <input type="checkbox"/> Cess pool <input type="checkbox"/> Livestock pens <input type="checkbox"/> Oil well/Gas well _____	Direction from well? _____ How many feet? _____

FROM	TO	PLUGGING MATERIALS	FROM	TO	PLUGGING MATERIALS
0	3	Topsoil			
3	19.68	Bentonite			
			KDHE ID: Fuel Express #17; U4-030-14948		

7 CONTRACTOR'S OR LANDOWNER'S CERTIFICATION:	This water well was plugged under my jurisdiction and was completed on (mo/day/year) <u>12/14/2022</u> and this record is true to the best of my knowledge and belief. Kansas Water Contractor's License No. <u>757</u> . This Water Well Record was completed on (mo/day/year) <u>1/4/2023</u> under the business name of <u>Larsen & Associates, Inc.</u> By (signature) _____
---	--

Send one white copy to Kansas Department of Health & Environment, Geology Section, 1000 SW Jackson Street, Ste. 420, Topeka, KS 66612-1367. Send one copy to WATER WELL OWNER and retain one for your records
 Visit us at <http://www.kdheks.gov/waterwell/index.html> Telephone 785-296-5524.

NOTE: Figures exhibited within this report are only to be used within the context of this report. Placement of property lines, wells, structures, and roads is based on the available information from county appraiser maps, surveys, site visits, and/or previous vendor reports and should be considered approximate.

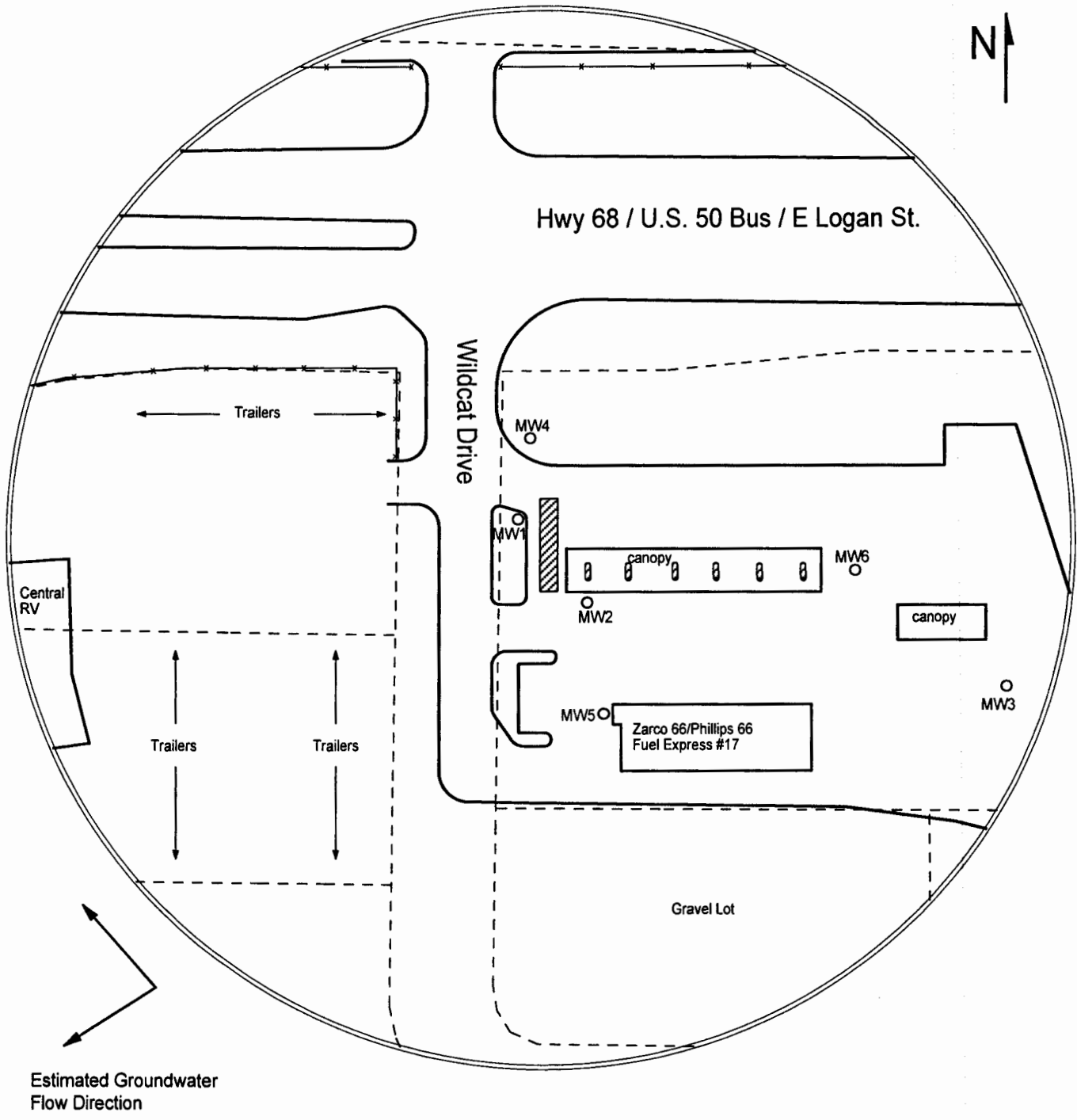

FIGURE 1 - 350 FT RADIUS AREA BASE MAP



PROJECT:
 Fuel Express #17
 2518 E. Logan
 Ottawa, KS
 KDHE ID: U4-030-14948
 Date: 12/14/22

LEGEND:

- Approximate Location of Active UST Basin & Pump Islands
- Approximate Location of Property Line
- Plugged Monitoring Well

T. 16 R. 20E Sec. 31
 Franklin
 County

1311 E 25th St. Suite B 785-841-8707 office
 Lawrence, KS 66046 785-865-4282 fax

