

**WATER WELL PLUGGING RECORD Form WWC-5P KSA 82a-1212 ID NO.**

MW2

<b>I LOCATION OF WATER WELL:</b> County: Franklin	Fraction	Section Number	Township Number	Range Number
	NE 1/4 NE 1/4 NW 1/4 NE 1/4	31	T 16 S	20 <input checked="" type="checkbox"/> E <input type="checkbox"/> W

Street/Rural Address of Well Location; if unknown, distance & direction from nearest town or intersection: If at owner's address, check here <input type="checkbox"/>  2518 E. Logan, Ottawa, KS	<b>Global Positioning Systems (GPS) information:</b> Latitude: <u>38.62233</u> (in decimal degrees) Longitude: <u>95.23503</u> (in decimal degrees) Elevation: <u>NA</u>
	Horizontal Datum <input checked="" type="checkbox"/> WGS84, <input type="checkbox"/> NAD83, <input type="checkbox"/> NAD27 Collection Method: <input type="checkbox"/> GPS unit (Make/model): _____ <input type="checkbox"/> Digital Map/Photo, <input type="checkbox"/> Topographic Map <input type="checkbox"/> Land Survey Est. Accuracy: <input type="checkbox"/> <3 m, <input type="checkbox"/> 3-5 m, <input type="checkbox"/> 5-15 m, <input type="checkbox"/> >15 m

**2 WATER WELL OWNER:** S.M. Trading Corporation  
RR#, St. Address, Box #: 16504 Goddard  
City, State ZIP Code: Overland Park, KS 66221

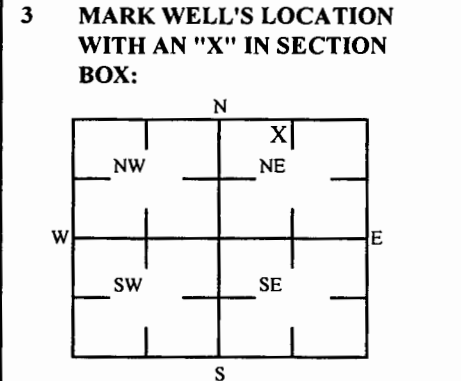

**4 DEPTH OF WELL** 20.00 ft.  
**WELL'S STATIC WATER LEVEL** NA ft.  
**WELL WAS USED AS:**

<input type="checkbox"/> Domestic	<input type="checkbox"/> Public Water Supply	<input type="checkbox"/> Dewatering
<input type="checkbox"/> Irrigation	<input type="checkbox"/> Oil Field Water Supply	<input checked="" type="checkbox"/> Monitoring
<input type="checkbox"/> Feedlot	<input type="checkbox"/> Domestic (Lawn & Garden)	<input type="checkbox"/> Injection Well
<input type="checkbox"/> Industrial	<input type="checkbox"/> Air Conditioning	<input type="checkbox"/> Other _____

Was a chemical/bacteriological sample submitted to Department? Yes  No

**5 TYPE OF BLANK CASING USED:**

<input type="checkbox"/> Steel	<input type="checkbox"/> RMP (SR)	<input type="checkbox"/> Wrought	<input type="checkbox"/> Fiberglass	<input type="checkbox"/> Other (Specific below)
<input checked="" type="checkbox"/> PVC	<input type="checkbox"/> ABS	<input type="checkbox"/> Asbestos-Cement	<input type="checkbox"/> Concrete Tile	_____

Blank casing diameter 2 in. Was casing pulled? Yes  No  If yes, how much 3'  
Casing height above or below land surface NA in.

**6 GROUT PLUG MATERIAL:**  Neat cement  Cement grout  Bentonite  Other 0-0.5' Concrete; 0.5-3' Topsoil

Grout Plug Intervals: From 3 ft to 20.00 ft, From \_\_\_\_\_ ft to \_\_\_\_\_ ft, From \_\_\_\_\_ ft to \_\_\_\_\_ ft,

What is the nearest source of possible contamination:

<input type="checkbox"/> Septic tank	<input type="checkbox"/> Seepage pit	<input type="checkbox"/> Fuel storage	<input type="checkbox"/> Other (specify below)
<input type="checkbox"/> Sewer lines	<input type="checkbox"/> Pit privy	<input type="checkbox"/> Fertilizer storage	_____
<input type="checkbox"/> Watertight sewer lines	<input type="checkbox"/> Sewage lagoon	<input type="checkbox"/> Insecticide storage	_____
<input type="checkbox"/> Lateral lines	<input type="checkbox"/> Feed yard	<input type="checkbox"/> Abandoned water well	Direction from well? _____
<input type="checkbox"/> Cess pool	<input type="checkbox"/> Livestock pens	<input type="checkbox"/> Oil well/Gas well	How many feet? _____

FROM	TO	PLUGGING MATERIALS	FROM	TO	PLUGGING MATERIALS
0	0.5	Concrete			
0.5	3	Soil			
3	20.00	Bentonite			
			KDHE ID: Fuel Express #17; U4-030-14948		

**7 CONTRACTOR'S OR LANDOWNER'S CERTIFICATION:** This water well was plugged under my jurisdiction and was completed on (mo/day/year) 12/14/2022 and this record is true to the best of my knowledge and belief. Kansas Water Contractor's License No. 757. This Water Well Record was completed on (mo/day/year) 1/4/2023 under the business name of Larsen & Associates, Inc. By (signature) \_\_\_\_\_

Send one white copy to Kansas Department of Health & Environment, Geology Section, 1000 SW Jackson Street, Ste. 420, Topeka, KS 66612-1367. Send one copy to WATER WELL OWNER and retain one for your records  
Visit us at <http://www.kdheks.gov/waterwell/index.html> Telephone 785-296-5524.

NOTE: Figures exhibited within this report are only to be used within the context of this report. Placement of property lines, wells, structures, and roads is based on the available information from county appraiser maps, surveys, site visits, and/or previous vendor reports and should be considered approximate.

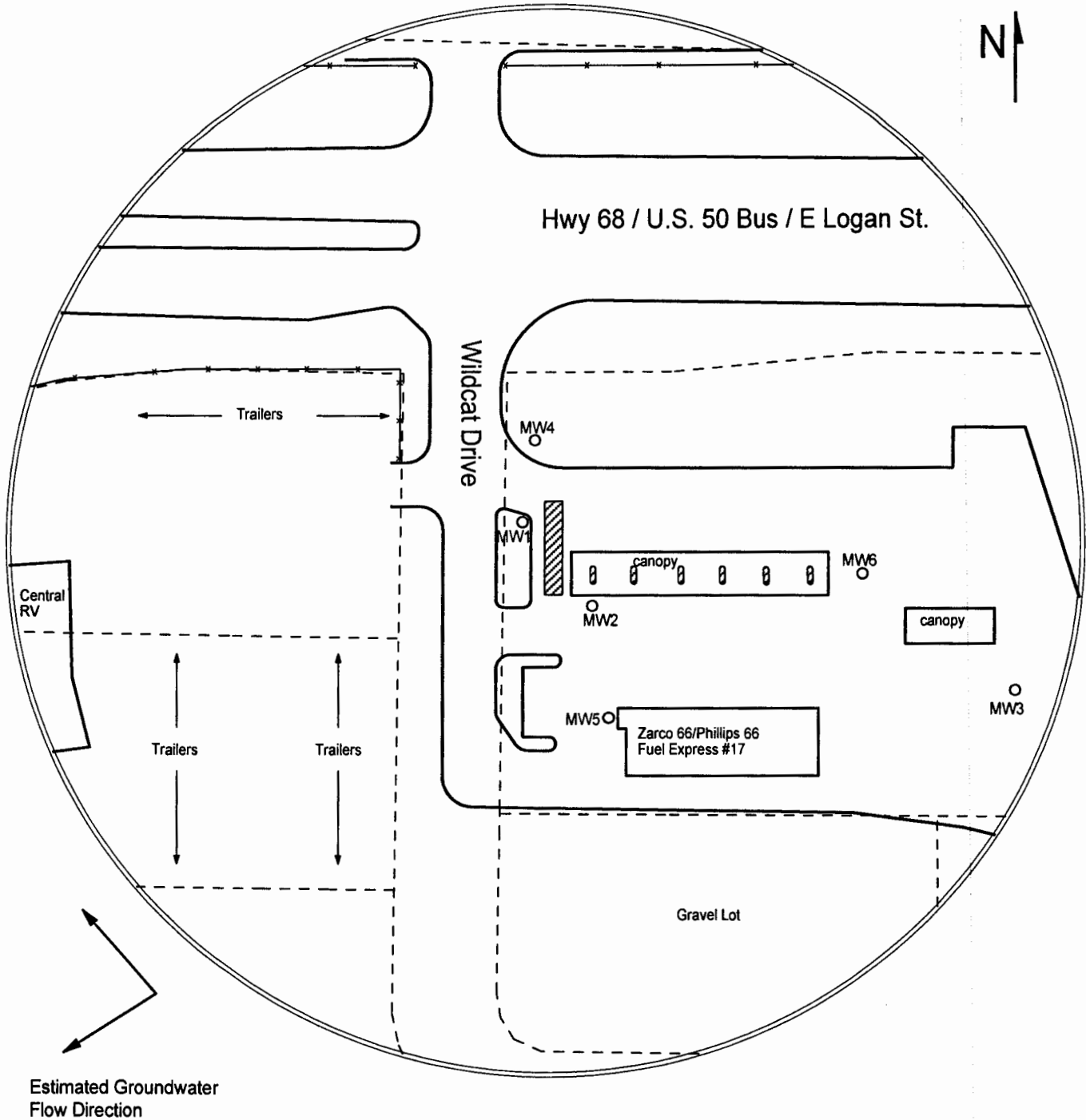



FIGURE 1 - 350 FT RADIUS AREA BASE MAP



**PROJECT:**  
 Fuel Express #17  
 2518 E. Logan  
 Ottawa, KS  
 KDHE ID: U4-030-14948  
 Date: 12/14/22

**LEGEND:**  
 Approximate Location of Active UST Basin & Pump Islands  
 - - - Approximate Location of Property Line  
 ○ Plugged Monitoring Well  
 T. 16 R. 20E Sec. 31  
 Franklin County

1311 E 25th St. Suite B 785-841-8707 office  
 Lawrence, KS 66046 785-865-4282 fax

