



NOTE: Figures exhibited within this report are only to be used within the context of this report. Placement of property lines, wells, structures, and roads is based on the available information from county appraiser maps, surveys, site visits, and/or previous vendor reports and should be considered approximate.

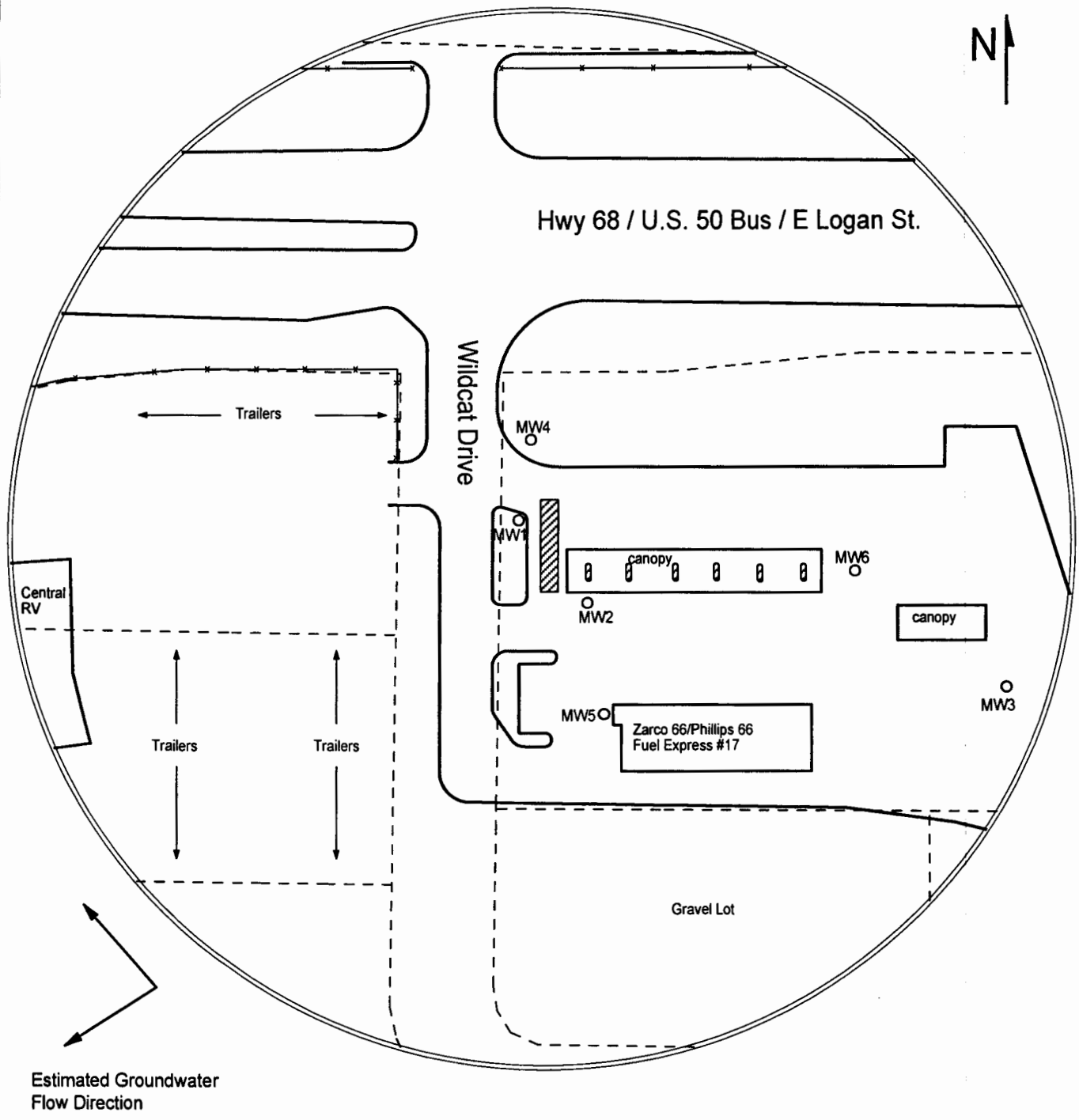
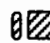



FIGURE 1 - 350 FT RADIUS AREA BASE MAP

**LEGEND:**

-  Approximate Location of Active UST Basin & Pump Islands
-  Approximate Location of Property Line
-  Plugged Monitoring Well

T. 16 R. 20E Sec. 31  
Franklin County



**PROJECT:**  
Fuel Express #17  
2518 E. Logan  
Ottawa, KS  
KDHE ID: U4-030-14948  
Date: 12/14/22

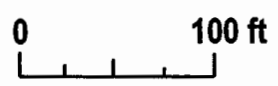

1311 E 25th St. Suite B 785-841-8707 office  
Lawrence, KS 66046 785-865-4282 fax