

STATE CORPORATION COMMISSION OF KANSAS  
OIL & GAS CONSERVATION DIVISION  
WELL COMPLETION OR RECOMPLETION FORM  
ACO-1 WELL HISTORY  
DESCRIPTION OF WELL AND LEASE



API NO. 15-121-26,826  
County Miami  
SW NW NE SE 24 16 21 XX East  
..... West

Operator: License # 5115  
Name REESE EXPLORATION, INC.  
Address 5540 Raytown Rd.  
Raytown, MO 64133  
City/State/Zip

2000  
1070 Ft North from Southeast Corner of Section  
Ft West from Southeast Corner of Section  
(Note: Locate well in section plat below)

Purchaser NA

Lease Name Cayot WSW #1 Well #

Operator Contact Person Patty Eichman  
Phone 816/356-1970

Field Name Wellsville Shoestring

Contractor: License # Kelly Down 5661  
Name Kelly Down Drilling

Producing Formation Mississippian

Wellsite Geologist None  
Phone

Elevation: Ground Unk

Designate Type of Completion  
New Well Re-Entry Workover

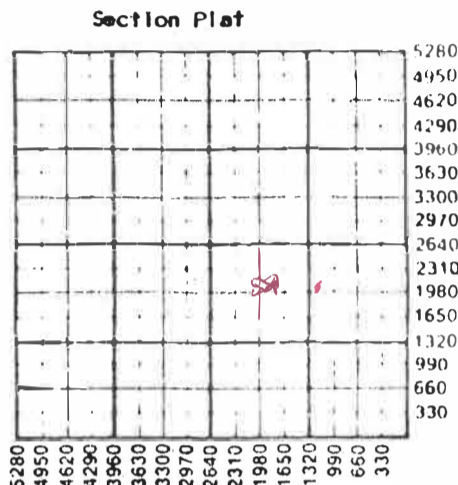

Oil SWD Temp Abd  
Gas Inj Delayed Comp.  
Dry X Other (Core, Water Supply, etc.)

WATER SUPPLY INFORMATION

If OWMQ: old well info as follows:  
Operator  
Well Name  
Comp. Date Old Total Depth

Disposition of Produced Water: Disposal  
Docket # Repressuring

WELL HISTORY

Drilling Method: XX Mud Rotary Air Rotary Cable  
.12-10-87 .12-15-87 .12-16-87  
Spud Date Date Reached TD Completion Date  
....1280... ..1278.....  
Total Depth PBTD

Questions on this portion of the ACO-1 call:

Water Resources Board (913) 296-3717  
Source of Water:  
Division of Water Resources Permit # 38650  
Groundwater.....Ft North from Southeast Corner  
(Well) .....Ft West from Southeast Corner of  
Sec Twp Rge East West  
Surface Water.....Ft North from Southeast Corner  
(Stream, pond etc).....Ft West from Southeast Corner  
Sec Twp Rge East West  
Other (explain).....  
(purchased from city, R.W.D. #)

Amount of Surface Pipe Set and Cemented at 20' feet  
Multiple Stage Cementing Collar Used? Yes No  
If yes, show depth set.....feet  
If alternate 2 completion, cement circulated  
from surface.....feet depth to.....w/ 10 SX cmt  
Cement Company Name Company tools  
Invoice #

INSTRUCTIONS: This form shall be completed in triplicate and filed with the Kansas Corporation Commission, 200 Colorado Derby Building, Wichita, Kansas 67202, within 120 days of the spud date of any well. Rule 82-3-130, 82-3-107 and 82-3-106 apply.  
Information on side two of this form will be held confidential for a period of 12 months if requested in writing and submitted with the form. See rule 82-3-107 for confidentiality in excess of 12 months.  
One copy of all wireline logs and drillers time log shall be attached with this form. Submit CP-4 form with all plugged wells. Submit CP-111 form with all temporarily abandoned wells.

All requirements of the statutes, rules and regulations promulgated to regulate the oil and gas industry have been fully complied with and the statements herein are complete and correct to the best of my knowledge.

Signature L.J. Reese  
Title President Date 2-22-88

K.C.C. OFFICE USE ONLY  
F Letter of Confidentiality Attached  
C Wireline Log Received  
C Drillers Time Log Received  
Distribution  
KCC SWD/Rep NGPA  
KGS Plug Other  
(Specify)

Subscribed and sworn to before me this 22nd day of February 1988.  
Notary Public Patricia Eichman  
Date Commission Expires 6-4-90

JUN 27 1988  
KANSAS GEOLOGICAL SURVEY  
WICHITA BRANCH

STATE CORPORATION COMMISSION  
RECEIVED  
FEBRUARY 22 1988  
CONSERVATION DIVISION  
Wichita, Kansas

Sec 24 Twp 16 Rge 21 E

Operator Name REESE EXPLORATION, INC. Lease Name Cayot Well # WSW #1

Sec. 24 Twp. 16 Rge. 21  East  West County Miami

WELL LOG

INSTRUCTIONS: Show important tops and base of formations penetrated. Detail all cores. Report all drill stem tests giving interval tested, time tool open and closed, flowing and shut-in pressures, whether shut-in pressure reached static level, hydrostatic pressures, bottom hole temperature, fluid recovery, and flow rates if gas to surface during test. Attach extra sheet if more space is needed. Attach copy of log.

Drill Stem Tests Taken  Yes  No  
 Samples Sent to Geological Survey  Yes  No  
 Cores Taken  Yes  No

Formation Description  
 Log  Sample

Name	Top	Bottom
Soil & Clay	0	11
Lime	11	18
Shale	18	20
Lime	20	30
Black Shale	30	34
Lime & Shale	34	594
Coal	594	599
Shale & Lime	599	626
Lime	626	630
Shale	630	1056
Lime & Shale	1056	1132
Green Shale	1132	1141
Lime/blu chirt	1141	1146
Shale	1146	1154
Lime	1154	1158
Shale	1158	1165
Lime	1165	1280
Total Depth		1280

CASING RECORD <input checked="" type="checkbox"/> Now <input type="checkbox"/> Used							
Report all strings set-conductor, surface, intermediate, production, etc.							
Purpose of String	Size Hole Drilled	Size Casing Set (In O.D.)	Weight Lbs/Ft.	Setting Depth	Type of Cement	#Sacks Used	Type and Percent Additives
Surface	10	8-5/8		20	Portland	10	
Production	6 1/2	4 1/2		1278	Portland	195	2% gel
PERFORATION RECORD				Acid, Fracture, Shot, Cement Squeeze Record			
Shots Per Foot	Specify Footage of Each Interval Perforated			(Amount and Kind of Material Used)		Depth	
2	1100 to 1154			NA			
TUBING RECORD		Size	Set At	Packer at	Liner Run	<input type="checkbox"/> Yes <input checked="" type="checkbox"/> No	
		2-3/8	1350				
Date of First Production		Producing Method					
Shut-in		<input type="checkbox"/> Flowing <input checked="" type="checkbox"/> Pumping <input type="checkbox"/> Gas Lift <input type="checkbox"/> Other (explain).....					
Estimated Production Per 24 Hours		Oil Bbls	Gas MCF	Water Bbls	Gas-Oil Ratio	Gravity	
NA		NA	NA	300			

METHOD OF COMPLETION

Production Interval

Disposition of gas:  Vented  Open Hole  Perforation  
 Sold  Other (Specify) ..... 1100 to 1154  
 Used on Lease  Dually Completed .....  
 Conmingled