

WATER WELL RECORD

Form WWC-5

Division of Water Resources App. No.

<p>1 LOCATION OF WATER WELL: County: <u>Miami</u> Street/Rural Address of Well Location; if unknown, distance & direction from nearest town or intersection: If at owner's address, check here <input type="checkbox"/></p>	Fraction <u>SW 1/4 NE 1/4 NE 1/4 NW 1/4</u>	Section Number <u>7</u>	Township No. T <u>16</u> S	Range Number R <u>24</u> E <input type="checkbox"/> W
<p>2 WATER WELL OWNER: <u>Tom + Diane Slackler</u> RR#, Street Address, Box #: <u>18670 W. 248th Street</u> City, State, ZIP Code: <u>Paola, KS 66071</u></p>		<p>Global Positioning System (GPS) information: Latitude: (in decimal degrees) Longitude: (in decimal degrees) Elevation: Datum: <input type="checkbox"/> WGS 84, <input type="checkbox"/> NAD 83, <input type="checkbox"/> NAD 27 Collection Method: <input type="checkbox"/> GPS unit (Make/Model:) <input type="checkbox"/> Digital Map/Photo, <input type="checkbox"/> Topographic Map, <input type="checkbox"/> Land Survey Est. Accuracy: <input type="checkbox"/> <3 m, <input type="checkbox"/> 3-5 m, <input type="checkbox"/> 5-15 m, <input type="checkbox"/> >15 m</p>		

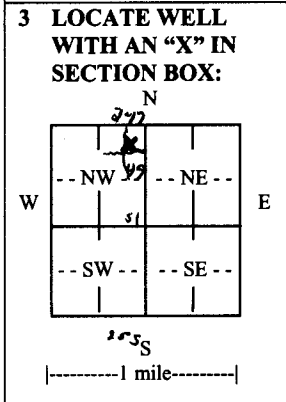

4 DEPTH OF COMPLETED WELL ft. 200 ft. 7-200' bores

Depth(s) Groundwater Encountered (1) None ft. (2) ft. (3) ft.
 WELL'S STATIC WATER LEVEL None ft. below land surface measured on mo/day/yr.....
 Pump test data: Well water was ft. after hours pumping gpm
 EST. YIELD. None gpm. Well water was ft. after hours pumping gpm
 Bore Hole Diameter 6 in. to 200 ft., and in. to ft.
 WELL WATER TO BE USED AS: Public water supply Geothermal Injection well
 Domestic Feedlot Oil field water supply Dewatering Other (Specify below)
 Irrigation Industrial Domestic-lawn & garden Monitoring well Closed loop
 Was a chemical/bacteriological sample submitted to Department? Yes No
 If yes, mo/day/yr sample was submitted.....
 Water well disinfected? Yes No

5 TYPE OF CASING USED: Steel PVC Other A.O. Polyethylene
 CASING JOINTS: Glued Clamped Welded Threaded Fusion
 Casing diameter 3 1/4 in. to 20.0 ft., Diameter in. to ft., Diameter in. to ft.
 Casing height below land surface..... 36 in., Weight SDR 11 lbs./ft., Wall thickness or gauge No. 16.0 PSI
 TYPE OF SCREEN OR PERFORATION MATERIAL: None
 Steel Stainless Steel PVC Other (Specify)
 Brass Galvanized Steel None used (open hole)
 SCREEN OR PERFORATION OPENINGS ARE: None
 Continuous slot Mill slot Gauze wrapped Torch cut Drilled holes None (open hole)
 Louvered shutter Key punched Wire wrapped Saw cut Other (specify)
 SCREEN-PERFORATED INTERVALS: From ft. to ft., From ft. to ft.
 GRAVEL PACK INTERVALS: From ft. to ft., From ft. to ft.

6 GROUT MATERIAL: Neat cement Cement grout Bentonite Other
 Grout Intervals: From 200 ft. to 3 ft., From ft. to ft., From ft. to ft.
 What is the nearest source of possible contamination:
 Septic tank Lateral lines Pit privy Livestock pens Insecticide storage Other (specify below)
 Sewer lines Cesspool Sewage lagoon Fuel storage Abandoned water well
 Watertight sewer lines Seepage pit Feedyard Fertilizer storage Oil well/gas well
 Direction from well NW Distance from well 150

FROM	TO	LITHOLOGIC LOG	FROM	TO	LITHO. LOG (cont.) or PLUGGING INTERVALS
0	10	Soil + clay			
10	27	Shale			
27	42	lime			
42	113	Shale	200	3	7-200' bores plugged with High Solid Bentonite
113	136	lime			
136	148	Shale			
148	157	lime			
157	190	Shale			
190	194	lime			
194	200	Shale			

7 CONTRACTOR'S OR LANDOWNER'S CERTIFICATION: This water well was constructed, reconstructed, or plugged under my jurisdiction and was completed on (mo/day/year) 8-4-11 and this record is true to the best of my knowledge and belief.
 Kansas Water Well Contractor's License No. 561 This Water Well Record was completed on (mo/day/year) 8-5-11
 under the business name of Evans Energy Dev. Inc. by (signature) [Signature]

INSTRUCTIONS: Use typewriter or ball point pen. PLEASE PRESS FIRMLY and PRINT clearly. Please fill in blanks and check the correct answers. Send three copies (white, blue, pink) to Kansas Department of Health and Environment, Bureau of Water, Geology Section, 1000 SW Jackson St., Suite 420, Topeka, Kansas 66612-1367. Telephone 785-296-5522. Send one copy to WATER WELL OWNER and retain one for your records. Include fee of \$5.00 for each constructed well. Visit us at <http://www.kdheks.gov/waterwell/index.html>.