

WATER WELL RECORD

Form WWC-5

Division of Water Resources App. No.

1 LOCATION OF WATER WELL: County: Miami	Fraction <u>NE 1/4 SE 1/4 SE 1/4 NE 1/4</u>	Section Number <u>17</u>	Township No. <u>T 16 S</u>	Range Number <u>R 24</u> <input checked="" type="checkbox"/> E <input type="checkbox"/> W
Street/Rural Address of Well Location; if unknown, distance & direction from nearest town or intersection: If at owner's address, check here <input checked="" type="checkbox"/> .		Global Positioning System (GPS) information: Latitude: (in decimal degrees) Longitude: (in decimal degrees) Elevation: Datum: <input type="checkbox"/> WGS 84, <input type="checkbox"/> NAD 83, <input type="checkbox"/> NAD 27 Collection Method: <input type="checkbox"/> GPS unit (Make/Model:) <input type="checkbox"/> Digital Map/Photo, <input type="checkbox"/> Topographic Map, <input type="checkbox"/> Land Survey Est. Accuracy: <input type="checkbox"/> <3 m, <input type="checkbox"/> 3-5 m, <input type="checkbox"/> 5-15 m, <input type="checkbox"/> >15 m		

2 WATER WELL OWNER: Jeff Lake
RR#, Street Address, Box #: 25840 Somerset Road
City, State, ZIP Code : Paola, Kansas 66071

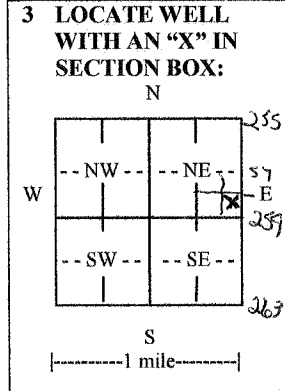

4 DEPTH OF COMPLETED WELL 200 ft. 3-200' Bores

Depth(s) Groundwater Encountered (1)..... ft. (2)..... ft. (3)..... ft.
WELL'S STATIC WATER LEVEL.....ft. below land surface measured on mo/day/yr.....
Pump test data: Well water was.....ft. after..... hours pumping..... gpm
EST. YIELD.....gpm. Well water was.....ft. after..... hours pumping..... gpm
Bore Hole Diameter 6 in. to 200 ft., and in. to ft.
WELL WATER TO BE USED AS: Public water supply Geothermal Injection well
 Domestic Feedlot Oil field water supply Dewatering Other (Specify below)
 Irrigation Industrial Domestic-lawn & garden Monitoring well Closed Loop
Was a chemical/bacteriological sample submitted to Department? Yes No
If yes, mo/day/yr sample was submitted.....
Water well disinfected? Yes No

5 TYPE OF CASING USED: Steel PVC Other HD Polyethylene
CASING JOINTS: Glued Clamped Welded Threaded Fusion
Casing diameter 3/4 in. to 200 ft., Diameter in. to ft., Diameter in. to ft.
Casing height above land surface 36 in., Weight SDR11 lbs./ft., Wall thickness or gauge No. 160 PSI
TYPE OF SCREEN OR PERFORATION MATERIAL: None Other (Specify)
 Steel Stainless Steel PVC
 Brass Galvanized Steel None used (open hole)
SCREEN OR PERFORATION OPENINGS ARE: None
 Continuous slot Mill slot Gauze wrapped Torch cut Drilled holes None (open hole)
 Louvered shutter Key punched Wire wrapped Saw cut Other (specify)
SCREEN-PERFORATED INTERVALS: From..... ft. to ft., From ft. to ft.
GRAVEL PACK INTERVALS: From..... ft. to ft., From ft. to ft.
From..... ft. to ft., From ft. to ft.

6 GROUT MATERIAL: Neat cement Cement grout Bentonite Other
Grout Intervals: From 200 ft. to 3 ft., From ft. to ft., From ft. to ft.
What is the nearest source of possible contamination:
 Septic tank Lateral lines Pit privy Livestock pens Insecticide storage Other (specify below)
 Sewer lines Cesspool Sewage lagoon Fuel storage Abandoned water well
 Watertight sewer lines Seepage pit Feedyard Fertilizer storage Oil well/gas well
Direction from well Distance from well

FROM	TO	LITHOLOGIC LOG	FROM	TO	LITHO. LOG (cont.) or PLUGGING INTERVALS
0	4	soil/clay/lime 120-163 shale			
4	9	lime 163-174 lime			
9	10	clay 174-188 shale			
10	30	lime 188-191 lime			
30	36	shale 191-198 shale	200	3	3-200' bores plugged with
36	56	lime 198-200 lime			High Solid Bentonite
56	85	shale			
85	98	lime			
98	118	shale			
118	120	lime			

7 CONTRACTOR'S OR LANDOWNER'S CERTIFICATION: This water well was constructed, reconstructed, or plugged under my jurisdiction and was completed on (mo/day/year) 9/3/2013..... and this record is true to the best of my knowledge and belief.
Kansas Water Well Contractor's License No. 561..... This Water Well Record was completed on (mo/day/year) 9/3/2013.....
under the business name of Evans Energy Development, Inc...... by (signature) [Signature].....

INSTRUCTIONS: Use typewriter or ball point pen. PLEASE PRESS FIRMLY and PRINT clearly. Please fill in blanks and check the correct answers. Send one copy to Kansas Department of Health and Environment, Bureau of Water, Geology Section, 1000 SW Jackson St., Suite 420, Topeka, Kansas 66612-1367. Telephone 785-296-5524. Send one copy to WATER WELL OWNER and retain one for your records. Include fee of \$5.00 for each constructed well. Visit us at <http://www.kdheks.gov/waterwell/index.html>