

WATER WELL RECORD

Form WWC-5

Revision

Division of Water Resources App. No.

Well ID

MW2

Original Record Correction Change in Well Use

1 LOCATION OF WATER WELL: County Franklin Fraction NW 1/4 SE 1/4 NE 1/4 NE 1/4 Section Number 11 Township Number T 17 S Range Number R 19 E W

2 WELL OWNER: Last Name: Business: KDHE Address: 1000 SW Jackson Blvd City Topeka State: KS ZIP: 66612 Street or Rural Address where well is located (if unknown, distance and direction from nearest town or intersection): 1630 S. Main. St., Ottawa, KS

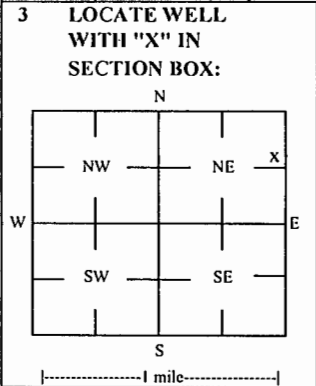

4 DEPTH OF COMPLETED WELL: 29 ft Depth(s) Groundwater Encountered: 1) 29 ft 2) 3) 4) Dry Well WELL'S STATIC WATER LEVEL: 27.43 ft X below land surface, measured on (mo-day-yr) 2/21/2019

5 Latitude: 38.59169 (decimal degrees) Longitude: 95.26971 (decimal degrees) Horizontal Datum: X WGS 84 NAD 83 NAD 27 Source for Latitude/Longitude: GPS (unit make/model:) (WAAS enabled? Yes No) X Land Survey Topographic Map Online Mapper

6 Elevation 947.81 ft Ground Level X TOC Source: X Land Survey GPS Topographic Map Other

7 WELL WATER TO BE USED AS: 1 Domestic: Household Lawn & Garden Livestock Irrigation Feedlot Industrial 5 Public Water Supply: well ID 6 Dewatering: how many wells? 7 Aquifer Recharge: well ID 8 X Monitoring: well ID MW2 9 Environmental Remediation: well ID Air Sparge Soil Vapor Extractor Recovery Injection 10 Oil Field Water Supply: lease 11 Test Hole: well ID Cased Uncased Geotechnical 12 Geothermal: How many bores? a) Closed Loop Horizontal Vertical b) Open Loop Surface Discharge Inj. of Water Other (specify):

Was a chemical/bacteriological sample submitted to KDHE? Yes No X No If yes, date sample was submitted: Water well disinfected? Yes No X No

8 TYPE OF CASING USED: Steel PVC X PVC Other CASING JOINTS: Glued Clamped Welded X Threaded Casing diameter 2 in. to 14 ft, Diameter in. to ft, Diameter in. to ft, Casing height above land surface -0.29 in. Weight lbs./ft. Well thickness or gauge No TYPE OF SCREEN OR PERFORATION MATERIAL: Steel Stainless Steel Fiberglass X PVC Other (Specify) Brass Galvanized Steel Concrete tile None used (open hole) SCREEN OR PERFORATION OPENINGS ARE: Continuous Slot X Mill Slot Gauze Wrapped Torch Cut Drilled Holes Other (Specify) Louvered Shutter Key Punched Wire Wrapped Saw Cut None (Open Hole) SCREEN-PERFORATED INTERVALS: From 14 ft. to 29 ft, From ft. to ft, From ft. to ft, GRAVEL PACK INTERVALS: From 12 ft. to 29 ft, From ft. to ft, From ft. to ft,

9 GROUT MATERIAL: Neat cement Cement grout X Bentonite X Other Concrete: 0-0.7' Grout intervals: From 0.7 ft. to 12 ft, From ft. to ft, From ft. to ft,

Nearest source of possible contamination: Septic Tank Lateral Lines Pit Privy Livestock Pens Insecticide Storage Sewer Lines Cess Pool Sewage Lagoon X Fuel Storage Abandoned Water Well Watertight Sewer Lines Seepage Pit Feedyard Fertilizer Storage Oil Well / Gas Well Other (Specify): Direction from well? SE Distance from well? ~230 ft

Table with 6 columns: FROM, TO, LITHOLOGIC LOG, FROM, TO, LITHO. LOG (cont.) or PLUGGING INTERVALS. Rows: 0-3.5 Topsoil w/ fatty silty clay, 3.5-28.5 Silty clay, 28.5-29 Chert Gravel

Notes: KDHE ID: Kicks 66; U4-030-15093 Target of monitoring well is shallow groundwater, <20' of grout was installed at the direction of KDHE.

11 CONTRACTOR'S OR LANDOWNER'S CERTIFICATION: This water well was X constructed, reconstructed or plugged under my jurisdiction and was completed on (mo-day-year) 12/12/18 and this record is true to the best of my knowledge and belief. Kansas Water Well Contractor's License No 757 This Water Well Record was completed on (mo-day-year) 2/28/19 under the business name of Larsen & Associates, Inc. Signature

Mail 1 white copy along with a fee of \$5.00 for each constructed well to: Kansas Department of Health and Environment, Bureau of Water, GWTS Section, 1000 SW Jackson St., Suite 420, Topeka, Kansas 66612-1367. Mail one to Water Well Owner and retain one for your records. Telephone 785-296-5524.

DENNIS L HANDKE

1820 NW 59th Terrace
TOPEKA, KANSAS 66618
785-286-4047 Home
785-286-1990 Fax

Jess Chapman
Larsen & Associates
1311 E. 25th Street, Suite B
Lawrence, Kansas, 66046

January 29, 2019

RE: Monitor Well Elevation Survey
1621 S. Main, Ottawa, Kansas

Proj. 19-00C
Kicks 66
U4-030-15093

Bench Mark: Square cut on West center of concrete storm inlet at NW Corner of property.
Elev: 944.83 North 4453.83 West 246.68 (from SE Cor. Sec. 11-17-19E)

| | | | | | |
|------|----------|--------|-------|---------|-------------------------------|
| MW-1 | rim | 944.93 | North | 4390.08 | NE1/4,SE1/4,NE1/4,NE1/4 |
| | top pipe | 944.64 | West | 223.51 | Lat= 38.59137 Long = 95.26865 |
| MW-2 | rim | 948.10 | North | 4504.85 | NW1/4,SE1/4,NE1/4,NE1/4 |
| | top pipe | 947.81 | West | 527.41 | Lat= 38.59169 Long = 95.26971 |
| MW-3 | rim | 943.53 | North | 4355.61 | NE1/4,SE1/4,NE1/4,NE1/4 |
| | top pipe | 943.29 | West | 100.55 | Lat= 38.59125 Long = 95.26822 |
| MW-4 | rim | 945.88 | North | 4219.68 | SE1/4,SE1/4,NE1/4,NE1/4 |
| | top pipe | 945.49 | West | 234.91 | Lat= 38.59090 Long = 95.26869 |
| MW-5 | rim | 945.85 | North | 4313.49 | SE1/4,SE1/4,NE1/4,NE1/4 |
| | top pipe | 945.45 | West | 238.90 | Lat= 38.59116 Long = 95.26870 |
| MW-6 | rim | 939.89 | North | 4512.93 | NE1/4,SE1/4,NE1/4,NE1/4 |
| | top pipe | 939.58 | West | 53.17 | Lat= 38.59171 Long = 95.26806 |
| MW-7 | rim | 946.17 | North | 4362.86 | NW1/4,SE1/4,NE1/4,NE1/4 |
| | top pipe | 945.79 | West | 331.51 | Lat= 38.59130 Long = 95.26903 |
| MW-8 | rim | 945.19 | North | 4527.64 | NE1/4,SE1/4,NE1/4,NE1/4 |
| | top pipe | 944.82 | West | 211.98 | Lat= 38.59175 Long = 95.26861 |
| MW-9 | rim | 946.23 | North | 4491.36 | NW1/4,SE1/4,NE1/4,NE1/4 |
| | top pipe | 945.92 | West | 352.21 | Lat= 38.59165 Long = 95.26910 |

RECEIVED
APR 30 2019
BUREAU OF WATER

Lat & Long derived from Ottawa South 7.5' quad map. WGS84

Elevation established from USGS BM L 327 Reset.

If you have any questions, please feel free to call me. Thank you for the opportunity to be of service to you.

January 29, 2019
Dennis L Handke RLS

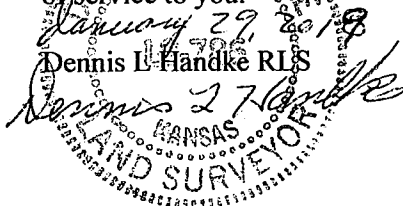

NOTE: Figures exhibited within this report are only to be used within the context of this report. Placement of property lines, wells, structures, and roads is based on the available information from county appraiser maps, surveys, site visits, and/or previous vendor reports and should be considered approximate.

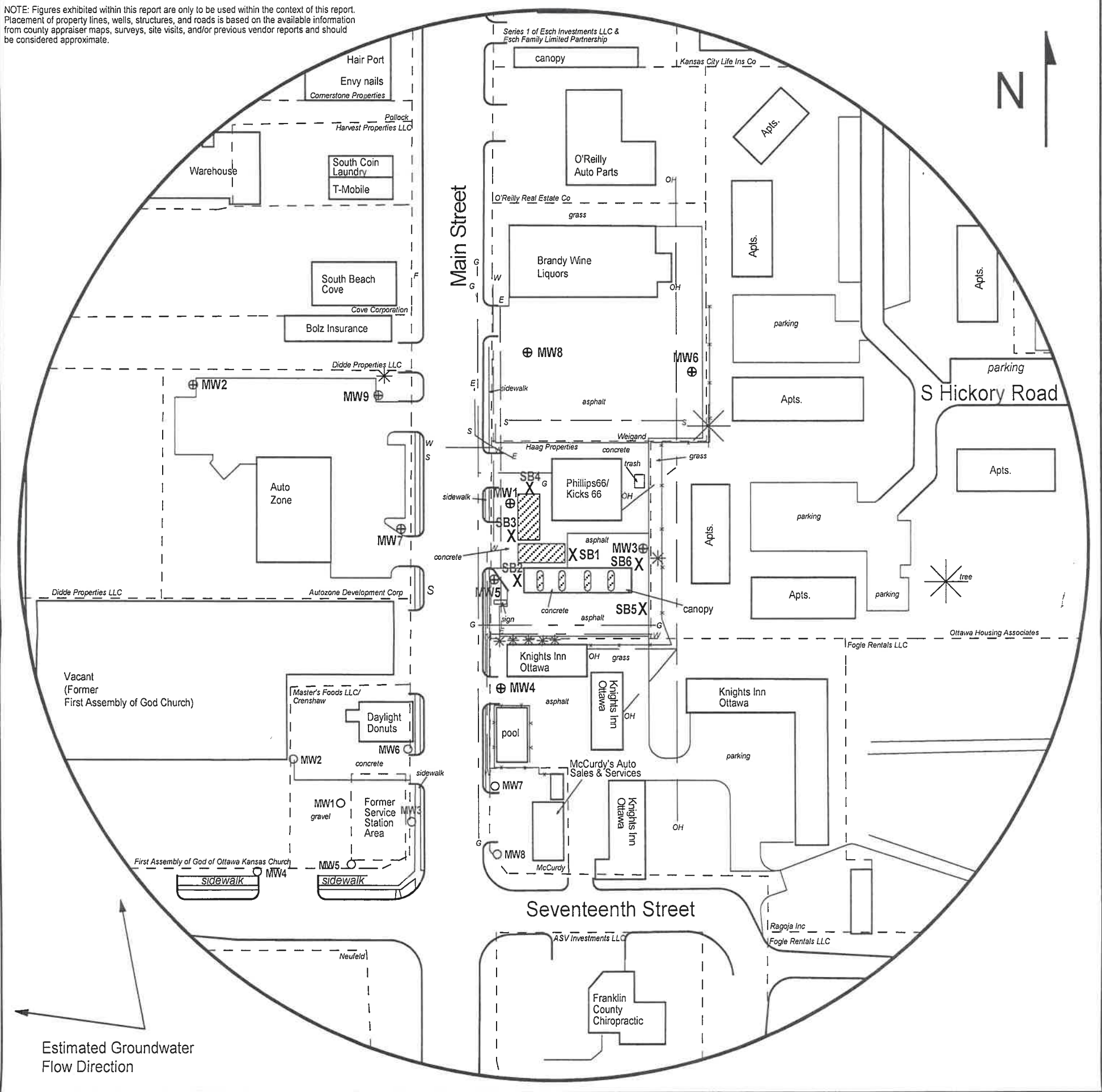

FIGURE 2.2 - 500 FT RADIUS AREA BASE MAP

LEGEND:

- Approximate Location of Active UST Basin and Pump Islands
- Approximate Location of Property Line
- Monitoring Well (Installed 12/11-12/19, 12/26-27/19)
- Plugged Well
- Soil Boring (Drilled 12/26-27/19)
- Fire Hydrant
- Gas Lines (2 - 6 ft BGS)
- Overhead Lines (25-40 ft high)
- Electric Lines (2 - 6 ft BGS)
- Sewer Lines (2 - 6 ft BGS)
- Water Lines (2 - 6 ft BGS)

NOTE: MW1 & MW5 are the source wells.
 NOTE: Location of product active lines is unknown.
 NOTE: SB5 & SB6 were drilled to collect hydrologic samples.
 NOTE: Utility depths, heights and locations are approximate.



PROJECT:

Kicks 66
 1621 South Main
 Ottawa, KS
 KDHE ID: U4-030-15093
 Date: 2/21/19



1311 E 25th St., Suite B (785) 841-8707 office
 Lawrence, KS 66046 (785) 865-4282 fax

RECEIVED

APR 30 2019

BUREAU OF WATER