

WATER WELL RECORD

Form WWC-5

Revision

Division of Water Resources App. No.

Well ID

MW9

Original Record [] Correction [X] Change in Well Use []

1 LOCATION OF WATER WELL: County Franklin, Fraction NW 1/4 SE 1/4 NE 1/4 NE 1/4, Section Number 11, Township Number T 17 S, Range Number R 19 E W

2 WELL OWNER: Last Name: Business: KDHE, Address: 1000 SW Jackson Blvd, City: Topeka, State: KS, ZIP: 66612, Street or Rural Address where well is located: 1630 S. Main. St., Ottawa, KS

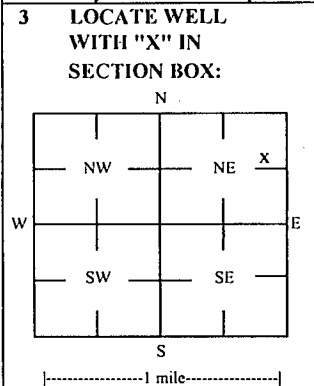

3 LOCATE WELL WITH 'X' IN SECTION BOX: 4 DEPTH OF COMPLETED WELL: 25.5 ft, Depth(s) Groundwater Encountered: 1) 25.5 ft, 2) Dry Well, WELL'S STATIC WATER LEVEL: Dry ft, [X] below land surface, measured on (mo-day-yr) 2/21/2019, Pump test data: Well water was ft after hours pumping gpm, Water well was ft after hours pumping gpm, Estimated Yield: gpm, Bore Hole Diameter: 7.25 in to ft, and in to ft

5 Latitude: 38.59165 (decimal degrees), Longitude: 95.26910 (decimal degrees), Horizontal Datum: [X] WGS 84 [] NAD 83 [] NAD 27, Source for Latitude/Longitude: [] GPS (unit make/model:), (WAAS enabled? [] Yes [] No), [X] Land Survey [] Topographic Map, [] Online Mapper

6 Elevation: 945.92 ft, [] Ground Level [X] TOC, Source: [X] Land Survey [] GPS [] Topographic Map, [] Other

7 WELL WATER TO BE USED AS: 1 Domestic: [] Household [] Lawn & Garden [] Livestock [] Irrigation [] Feedlot [] Industrial, 2 Public Water Supply: well ID, 3 Dewatering: how many wells?, 4 Aquifer Recharge: well ID, 5 Monitoring: well ID MW9, 6 Environmental Remediation: well ID, 7 Air Sparge [] Soil Vapor Extractor [] Recovery [] Injection, 8 Oil Field Water Supply: lease, 9 Test Hole: well ID, [] Cased [] Uncased [] Geotechnical, 10 Geothermal: How many bores?, a) Closed Loop [] Horizontal [] Vertical, b) Open Loop [] Surface Discharge [] Inj. of Water, [] Other (specify):

Was a chemical/bacteriological sample submitted to KDHE? [] Yes [X] No, If yes, date sample was submitted: Water well disinfected? [] Yes [X] No

8 TYPE OF CASING USED: [] Steel [X] PVC [] Other, CASING JOINTS: [] Glued [] Clamped [] Welded [X] Threaded, Casing diameter 2 in. to 10.5 ft, Diameter in. to ft, Diameter in. to ft, Casing height above land surface -0.31 in. Weight lbs./ft. Well thickness or gauge No, TYPE OF SCREEN OR PERFORATION MATERIAL: [] Steel [] Stainless Steel [] Fiberglass [X] PVC [] Other (Specify), [] Brass [] Galvanized Steel [] Concrete tile [] None used (open hole), SCREEN OR PERFORATION OPENINGS ARE: [] Continuous Slot [X] Mill Slot [] Gauze Wrapped [] Torch Cut [] Drilled Holes [] Other (Specify), [] Louvered Shutter [] Key Punched [] Wire Wrapped [] Saw Cut [] None (Open Hole), SCREEN-PERFORATED INTERVALS: From 10.5 ft. to 25.5 ft., From ft. to ft., From ft. to ft., GRAVEL PACK INTERVALS: From 8 ft. to 25.5 ft., From ft. to ft., From ft. to ft.,

9 GROUT MATERIAL: [] Neat cement [] Cement grout [X] Bentonite [X] Other Concrete: 0-0.7', Grout intervals: From 0.7 ft. to 8 ft., From ft. to ft., From ft. to ft.,

Nearest source of possible contamination: [] Septic Tank [] Lateral Lines [] Pit Privy [] Livestock Pens [] Insecticide Storage, [] Sewer Lines [] Cess Pool [] Sewage Lagoon [X] Fuel Storage [] Abandoned Water Well, [] Watertight Sewer Lines [] Seepage Pit [] Feedyard [] Fertilizer Storage [] Oil Well / Gas Well, [] Other (Specify): Direction from well? SE Distance from well? ~100 ft

10 FROM TO LITHOLOGIC LOG FROM TO LITHO. LOG (cont.) or PLUGGING INTERVALS

FROM	TO	LITHOLOGIC LOG	FROM	TO	LITHO. LOG (cont.) or PLUGGING INTERVALS
0	0.7	Topsoil, silty clay with limestone gravel			
0.7	4	Fatty silty clay			
4	25	Lean silty clay			
25	25.5	Chert gravel			

Notes: KDHE ID: Kicks 66; U4-030-15093, Target of monitoring well is shallow groundwater, <20' of grout was installed at the direction of KDHE.

11 CONTRACTOR'S OR LANDOWNER'S CERTIFICATION: This water well was [X] constructed, [] reconstructed, or [] plugged under my jurisdiction and was completed on (mo-day-year) 12/11/18 and this record is true to the best of my knowledge and belief, Kansas Water Well Contractor's License No 757 This Water Well Record was completed on (mo-day-year) 2/28/19 under the business name of Larsen & Associates, Inc. Signature

DENNIS L HANDKE

1820 NW 59th Terrace
TOPEKA, KANSAS 66618
785-286-4047 Home
785-286-1990 Fax

Jess Chapman
Larsen & Associates
1311 E. 25th Street, Suite B
Lawrence, Kansas, 66046

January 29, 2019

RE: Monitor Well Elevation Survey
1621 S. Main, Ottawa, Kansas

Proj. 19-00C
Kicks 66
U4-030-15093

Bench Mark: Square cut on West center of concrete storm inlet at NW Corner of property.
Elev: 944.83 North 4453.83 West 246.68 (from SE Cor. Sec. 11-17-19E)

MW-1	rim	944.93	North	4390.08	NE1/4,SE1/4,NE1/4,NE1/4
	top pipe	944.64	West	223.51	Lat= 38.59137 Long = 95.26865
MW-2	rim	948.10	North	4504.85	NW1/4,SE1/4,NE1/4,NE1/4
	top pipe	947.81	West	527.41	Lat= 38.59169 Long = 95.26971
MW-3	rim	943.53	North	4355.61	NE1/4,SE1/4,NE1/4,NE1/4
	top pipe	943.29	West	100.55	Lat= 38.59125 Long = 95.26822
MW-4	rim	945.88	North	4219.68	SE1/4,SE1/4,NE1/4,NE1/4
	top pipe	945.49	West	234.91	Lat= 38.59090 Long = 95.26869
MW-5	rim	945.85	North	4313.49	SE1/4,SE1/4,NE1/4,NE1/4
	top pipe	945.45	West	238.90	Lat= 38.59116 Long = 95.26870
MW-6	rim	939.89	North	4512.93	NE1/4,SE1/4,NE1/4,NE1/4
	top pipe	939.58	West	53.17	Lat= 38.59171 Long = 95.26806
MW-7	rim	946.17	North	4362.86	NW1/4,SE1/4,NE1/4,NE1/4
	top pipe	945.79	West	331.51	Lat= 38.59130 Long = 95.26903
MW-8	rim	945.19	North	4527.64	NE1/4,SE1/4,NE1/4,NE1/4
	top pipe	944.82	West	211.98	Lat= 38.59175 Long = 95.26861
MW-9	rim	946.23	North	4491.36	NW1/4,SE1/4,NE1/4,NE1/4
	top pipe	945.92	West	352.21	Lat= 38.59165 Long = 95.26910

RECEIVED
APR 30 2019
BUREAU OF WATER

Lat & Long derived from Ottawa South 7.5' quad map. WGS84

Elevation established from USGS BM L 327 Reset.

If you have any questions, please feel free to call me. Thank you for the opportunity to be of service to you.

January 29, 2019
Dennis L Handke RLS

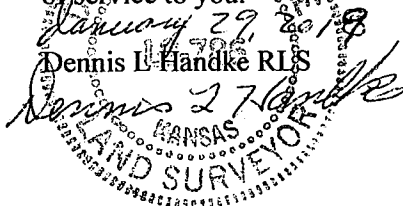

NOTE: Figures exhibited within this report are only to be used within the context of this report. Placement of property lines, wells, structures, and roads is based on the available information from county appraiser maps, surveys, site visits, and/or previous vendor reports and should be considered approximate.

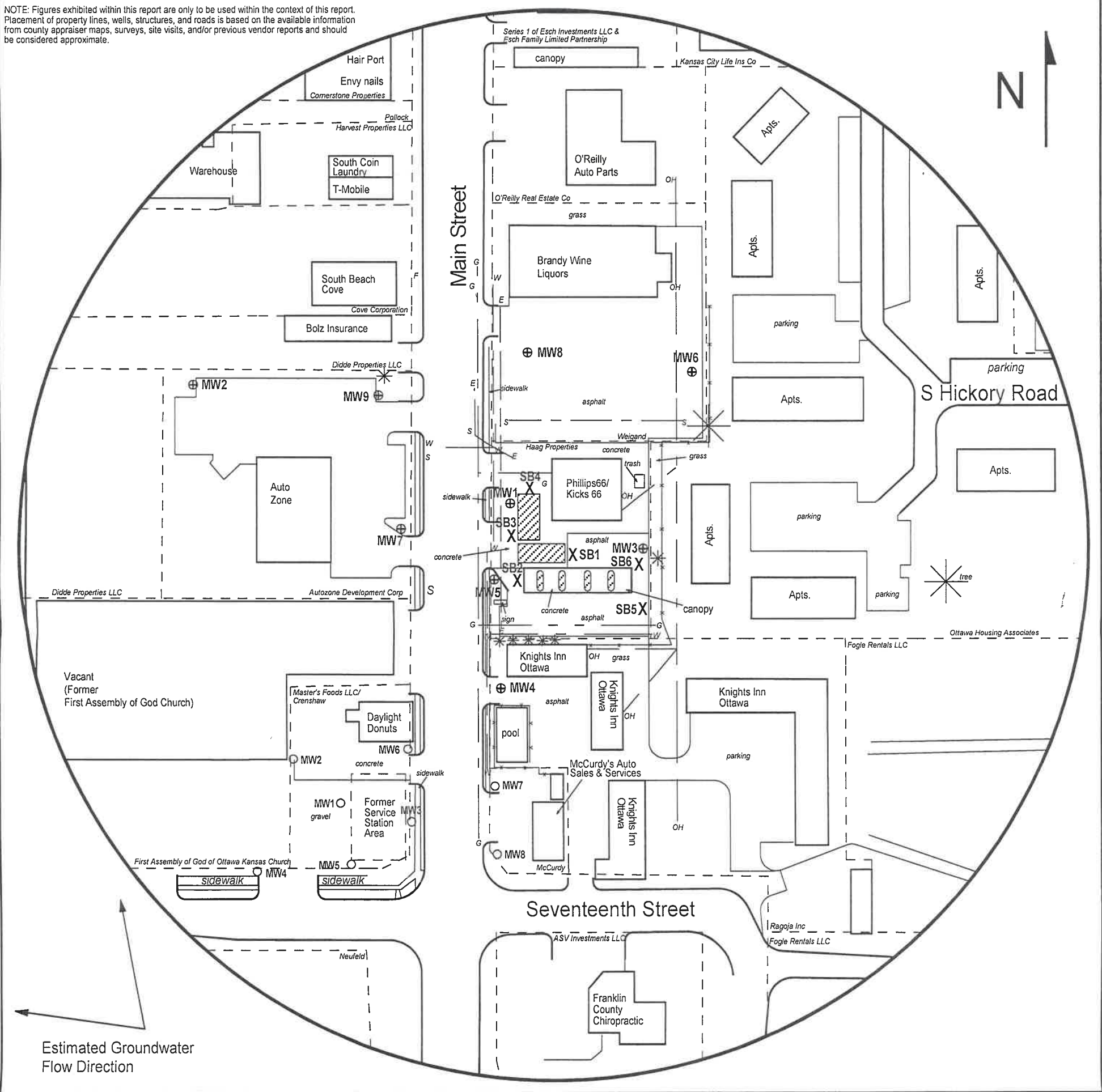

FIGURE 2.2 - 500 FT RADIUS AREA BASE MAP

LEGEND:

- Approximate Location of Active UST Basin and Pump Islands
- Approximate Location of Property Line
- Monitoring Well (Installed 12/11-12/19, 12/26-27/19)
- Plugged Well
- Soil Boring (Drilled 12/26-27/19)
- Fire Hydrant
- Gas Lines (2 - 6 ft BGS)
- Overhead Lines (25-40 ft high)
- Electric Lines (2 - 6 ft BGS)
- Sewer Lines (2 - 6 ft BGS)
- Water Lines (2 - 6 ft BGS)

NOTE: MW1 & MW5 are the source wells.
 NOTE: Location of product active lines is unknown.
 NOTE: SB5 & SB6 were drilled to collect hydrologic samples.
 NOTE: Utility depths, heights and locations are approximate.



PROJECT:

Kicks 66
 1621 South Main
 Ottawa, KS
 KDHE ID: U4-030-15093
 Date: 2/21/19



1311 E 25th St., Suite B (785) 841-8707 office
 Lawrence, KS 66046 (785) 865-4282 fax

RECEIVED

APR 30 2019

BUREAU OF WATER